

GRAPHIC SCALE



(IN FEET)
1 inch = 20 ft.

- LEGEND:**
- AE - AERIAL EASEMENT
 - BL - BUILDING LINE
 - BLDG - BUILDING
 - ESMT - EASEMENT
 - FND - FOUND
 - HL&P - HOUSTON LIGHTING & POWER
 - IP - IRON PIPE
 - IR - IRON ROD
 - CIR - CAPPED IRON ROD
 - STS - STAMPED SOUTH TEXAS SURVEYING
 - HCF - HARRIS COUNTY CLERKS FILE
 - HCDR - HARRIS COUNTY DEED RECORDS
 - HCMR - HARRIS COUNTY MAP RECORDS
 - POB - POINT OF BEGINNING
 - POC - POINT OF COMMENCING
 - PS - PARKING SPACES
 - RW - RIGHT OF WAY
 - SQ. FT. - SQUARE FEET
 - UE - UTILITY EASEMENT
 - WC - CONCRETE WALL
 - BW - BRICK WALL
 - SW - SIDEWALK
 - PLR - PLANTER
 - GI - GRATE INLET
 - FTN - FOUNTAIN
 - BCN - BRICK COLUMN
 - ICV - IRRIGATION CONTROL VALVE
 - EP - EDGE OF PAVEMENT
 - BWF - BARBED WIRE FENCE
 - CLF - CHAIN LINK FENCE
 - CONC - CONCRETE
 - CC - COVERED CONCRETE
 - EE - OVERHEAD ELECTRIC LINES
 - WF - WOOD FENCE
 - WIF - WROUGHT IRON FENCE
 - GW - GUY WIRE
 - CB - CATCH BASIN
 - CBX - CABLE BOX
 - EBX - ELECTRIC BOX
 - EMH - ELECTRIC MH
 - FH - FIRE HYDRANT
 - FOM - FIBER OPTIC MARKER
 - FP - FLAG POLE
 - GM - GAS METER
 - GV - GAS VALVE
 - CI - CURB INLET
 - LFP - LIGHT POLE
 - MH - MANHOLE
 - MW - MONITORING WELL
 - PM - PIPELINE MARKER
 - PP - POWER POLE
 - SP - SERVICE POLE
 - SMH - SANITARY MANHOLE
 - SM - STORM MANHOLE
 - TP - TELEPHONE PEDESTAL
 - TR - TRANSFORMER
 - TSCB - TRAFFIC SIGNAL BOX
 - TSM - TRAFFIC SIGNAL MARKER
 - UCM - UNDERGROUND CABLE MARKER
 - WW - WATER WELL
 - WM - WATER METER
 - WV - WATER VALVE
 - B - BENCHMARK

LOT 5
CALLED 1.176 ACRES
OWNER: JANARDAN THAKKAR
AND WIFE, LINDA J. THAKKAR
H.C.C.F. NO. S237475

LOT 7J
1.3649 ACRES
OWNER: BERNARDINO AROCHA
H.C.C.F. NO. M593445

LOTS 11 & 12
CALLED 1.0588 ACRES
OWNER: NORMAN WAY
VOL. 2574, PG. 707
H.C.M.R.

MERRIE WAY LANE
(40' R.O.W.)

PINEY POINT VILLAGE
SUBDIVISION
H.C.C.F. NO. R639959

MEMORIAL DRIVE
(VARIABLE WIDTH R.O.W.)

- NOTES:**
1. ALL BEARINGS ARE BASED ON G.P.S. OBSERVATION, TEXAS SOUTH CENTRAL, GEOID 18, NAD 83, WITH A BEARING BEING THE NORTHWEST RIGHT-OF-WAY LINE OF MEMORIAL DRIVE WITH A BEARING OF BEARING OF S 22°07'42" W.
 2. SURVEYOR DID NOT ABSTRACT PROPERTY. SURVEY BASED ON LEGAL DESCRIPTIONS RECORDED IN H.C.C.F. NO. H058210.
 3. NOTHING IN THIS SURVEY IS INTENDED TO EXPRESS AN OPINION REGARDING OWNERSHIP OR TITLE.
 4. THE WORD CERTIFY IS UNDERSTOOD TO BE AN EXPRESSION OF PROFESSIONAL JUDGMENT BY THE SURVEYOR, WHICH IS BASED ON HIS BEST KNOWLEDGE, INFORMATION AND BELIEF.
 5. SURVEY IS CERTIFIED FOR THIS TRANSACTION ONLY.
 6. THE FINDINGS AND OPINIONS OF SOUTH TEXAS SURVEYING ASSOCIATES, INC. REFLECTED HEREON ARE PRIVILEGED, CONFIDENTIAL AND INTENDED FOR THE USE OF THE INDIVIDUAL OR ENTITY FOR WHOM THIS WORK WAS PREPARED, IT IS UNDERSTOOD THAT THE USE OF, RELIANCE ON, OR REPRODUCTION OF SAME, IN WHOLE OR IN PART, BY OTHERS WITHOUT THE EXPRESS WRITTEN CONSENT OF SOUTH TEXAS SURVEYING ASSOCIATES, INC. IS PROHIBITED AND WITHOUT WARRANTY, EXPRESS OR IMPLIED, SOUTH TEXAS SURVEYING ASSOCIATES, INC. SHALL BE HELD HARMLESS AGAINST DAMAGES OR EXPENSES RESULTING FROM SUCH UNAUTHORIZED USE, RELIANCE OR REPRODUCTION. COPYRIGHT 2022. ALL RIGHTS RESERVED.
 7. THIS SURVEY WAS PERFORMED WITHOUT THE BENEFIT OF A TITLE REPORT. CERTAIN EASEMENTS AND/OR BUILDING LINES MAY HAVE BEEN GRANTED WHICH ARE NOT REFLECTED HEREON. THIS SURVEY IS SUBJECT TO ANY FACTS THAT MAY BE DISCLOSED BY A FULL AND ACCURATE TITLE SEARCH. THIS SURVEY WAS DONE WITHOUT BENEFIT OF DEED. OWNER SHOULD OBTAIN A TITLE COMMITMENT BEFORE DESIGN OR CONSTRUCTION COMMENCES.

FLOOD NOTE:

PROPERTY LIES WITHIN FLOOD ZONE "X", ACCORDING TO F.I.R.M. MAP NO. 4851C-0645L. DATE: 6/18/2007. BY GRAPHING PLOTTING ONLY. WE DO NOT ASSUME RESPONSIBILITY FOR EXACT DETERMINATION. BEFORE ANY DEVELOPMENT PLANNING, DESIGN, OR CONSTRUCTION IS STARTED, THE COMMUNITY, CITY AND COUNTY IN WHICH SUBJECT TRACT EXISTS SHOULD BE CONTACTED. SAID ENTITIES MAY IMPOSE LARGER FLOOD PLAIN AND FLOODWAY AREAS THAN SHOWN BY F.I.R.M. MAPS THAT WILL AFFECT DEVELOPMENT.

SURVEYOR'S CERTIFICATION
PROPERTY SUBJECT TO CITY ORDINANCES AND SUBDIVISION COVENANTS, CONDITIONS AND RESTRICTIONS. I hereby certify that this survey was made on the ground and that this plot correctly represents the facts found at the time of survey showing any improvements, from legal descriptions supplied by client. There are no encroachments apparent on the ground, except as shown. This survey is only certified for boundary and this transaction only. Surveyor did not abstract property, Easements, building lines, etc. shown are as identified by:
GF: N/A of N/A

Fred F. Lawton, Registered Professional Land Surveyor No. 5530

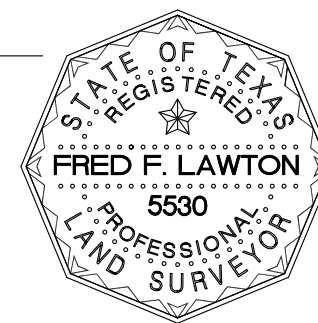

SURVEY OF

A 1.6369 ACRES, (71,303 SQ. FT.) TRACT OR PARCEL OF LAND OUT OF JOHN D. TAYLOR SURVEY, ABSTRACT NO. 72 IN HARRIS COUNTY, TEXAS, BEING THE NORTH PORTION OF THAT THREE ACRE TRACT CONVEYED TO FRANCES J. NIVEN BY DEED RECORDED IN VOLUME 1337, PAGE 294 OF THE DEED RECORDS OF HARRIS COUNTY, TEXAS.

ADDRESS: 11406 MEMORIAL DRIVE HOUSTON, TEXAS 77024	REVISIONS:
SITE:	NO. DATE DESCRIPTION
JOB NO: 1546-22	SCALE: 1" = 20'
DATE: 08-15-22	SHEET 1 OF 1

SOUTH TEXAS SURVEYING ASSOCIATES, INC.
11281 Richmond Ave. Bldg J, Suite 101, Houston, Texas 77082
281-556-6918 FAX 281-556-9331
Firm Number: 10045400