

DETACHED GARAGE

D/W

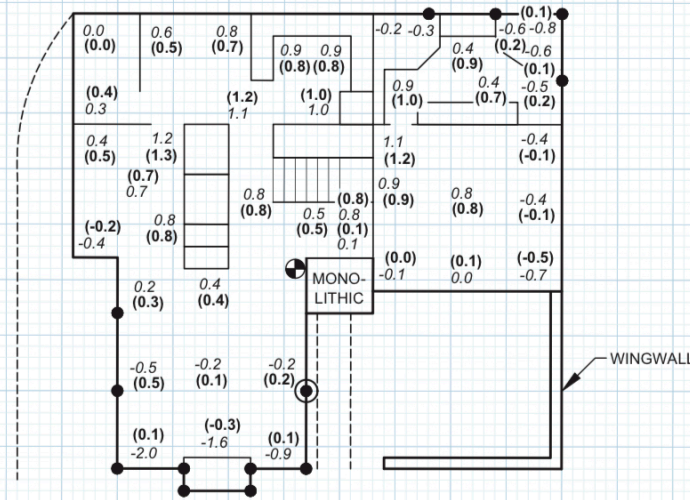

CONSTRUCTION NOTE: IF INTERIOR PILING LOCATIONS ARE SHOWN ON THIS MAP THEY ARE APPROXIMATED AND ARE LOCATED WITHOUT KNOWLEDGE OF THE LOCATIONS OF THE INTERIOR GRADE BEAMS. THE CONTRACTOR SHALL MAKE FIELD JUDGEMENTS BASED OFF OF THEIR GRADE BEAM INVESTIGATIONS AND OBSERVED SLAB QUALITIES TO FIELD LOCATE THE FINAL INTERIOR PIER LOCATIONS. FINAL SCOPE CHANGES SHALL BE APPROVED BY THE ENGINEER OF RECORD.

PLEASE NOTE: IF EXISTING PILINGS ARE SHOWN ON THIS MAP, THEIR LOCATION WAS PROVIDED BY THE CLIENT AND IS APPROXIMATE. CE DOES NOT CERTIFY THEIR PERFORMANCE OR EXISTENCE. IF THE READER WOULD LIKE TO DETERMINE IF THEY ARE ACTUALLY PRESENT, THEY MUST CONTACT THE OWNER OR CONTRACTOR TO OBTAIN AN ENGINEERING CERTIFICATE FOR THEM.

- INSTALLED 13 TOTAL PILINGS (12 EXTERIOR, 1 BREAKOUT).
- NOT COMPLETED: INSTALL A FULLY FUNCTIONING GUTTERING SYSTEM ON ALL SLOPED ROOF SIDES (STILL RECOMMENDED).

LIMITED REPAIR PLAN

NOT TO SCALE - ALL LOCATIONS APPROXIMATE

PRE-LIFT ELEVATIONS BY CE (01.13.22) 0.0

POST-LIFT ELEVATIONS BY CE (02.01.22) (X.X)

LEGEND

- ELEVATION BASEPOINT
- INSTALLED PAD/BLOCK
- ⊗ EXISTING PIER
- INSTALLED BEAM
- EXISTING PAD/BLOCK
- ⊙ INSTALLED BREAKOUT PIER
- EXISTING BEAM
- INSTALLED PIER
- ⊗ EXISTING BREAKOUT PIER

Adam Green
02/02/22

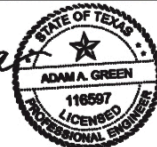

CROSSTOWN ENGINEERING
TBPE FIRM F-15944 - WWW.CROSSTOWNENGINEERING.COM
(469)-751-7694 - DALLAS METROPLEX

522 BLUE RIDGE DR., SHENANDOAH, TX. 77381