

Existing Grade Beam

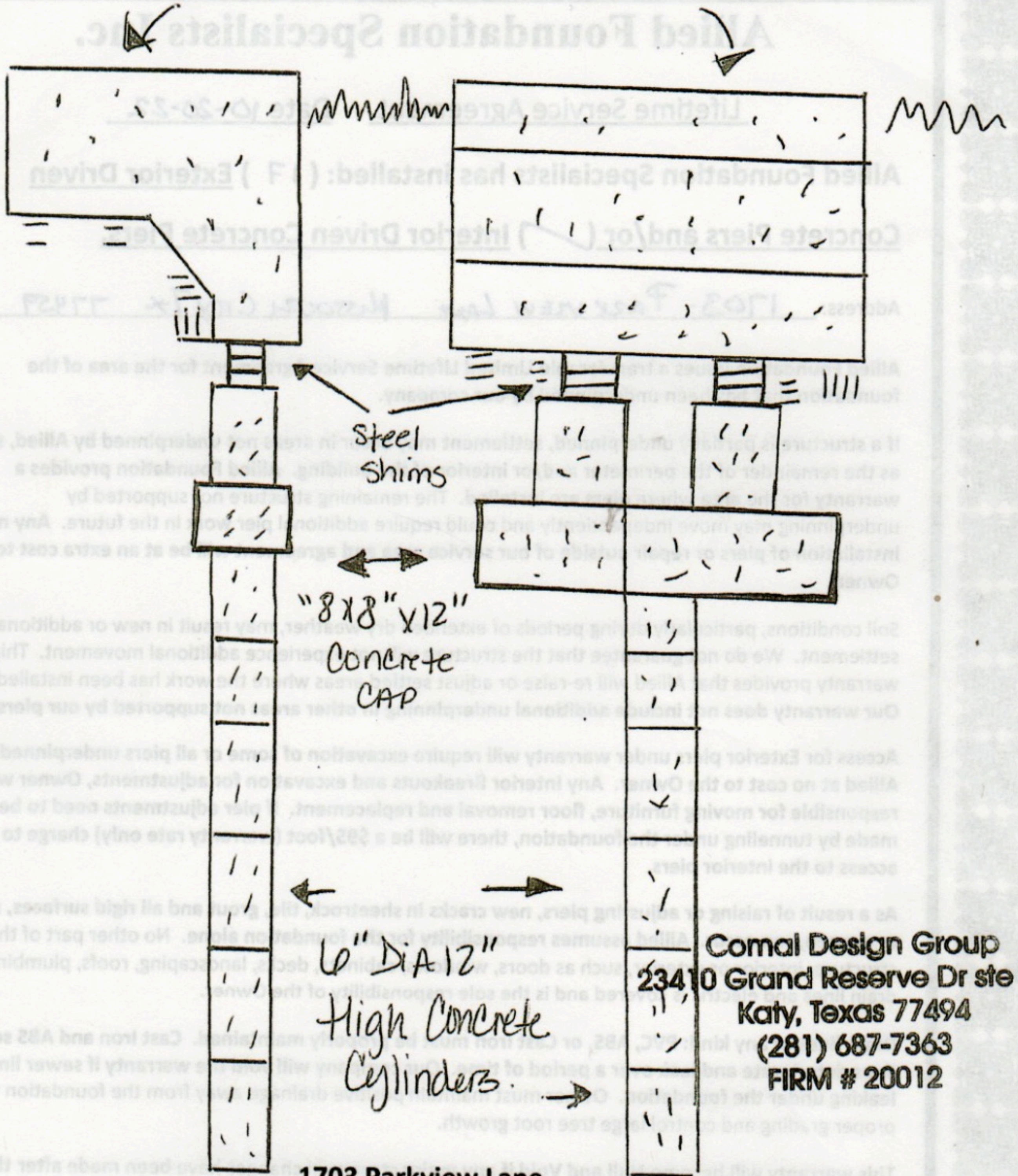

1703 Parkview Lane

Missouri City TX 77459

Comal Design Group
23410 Grand Reserve Dr ste 81
Katy, Texas 77494
(281) 687-7363
FIRM # 20012

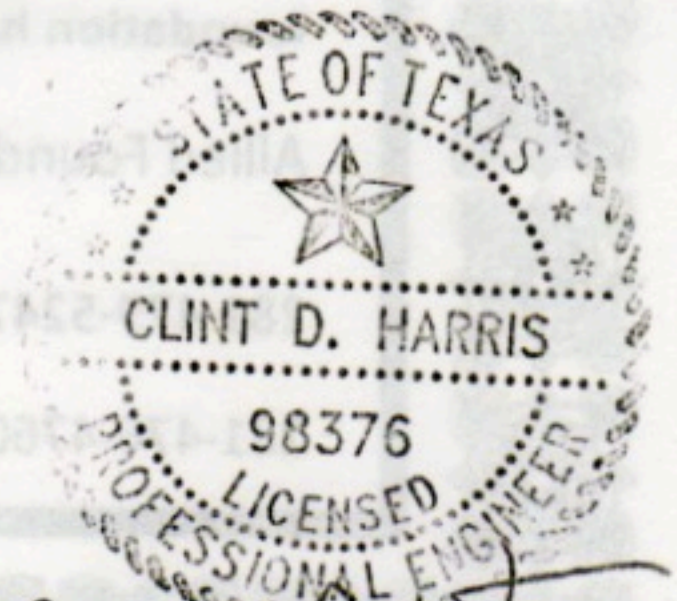

Clint D. Harris
9/19/08

4906 Luella
Deer Park, Texas 77536
(281) 479-5247 • (281) 476-4760 Fax
crackedslab.com

Allied Foundation Specialists, Inc.

07/02/22
Salman Raza
(631) 827-8838

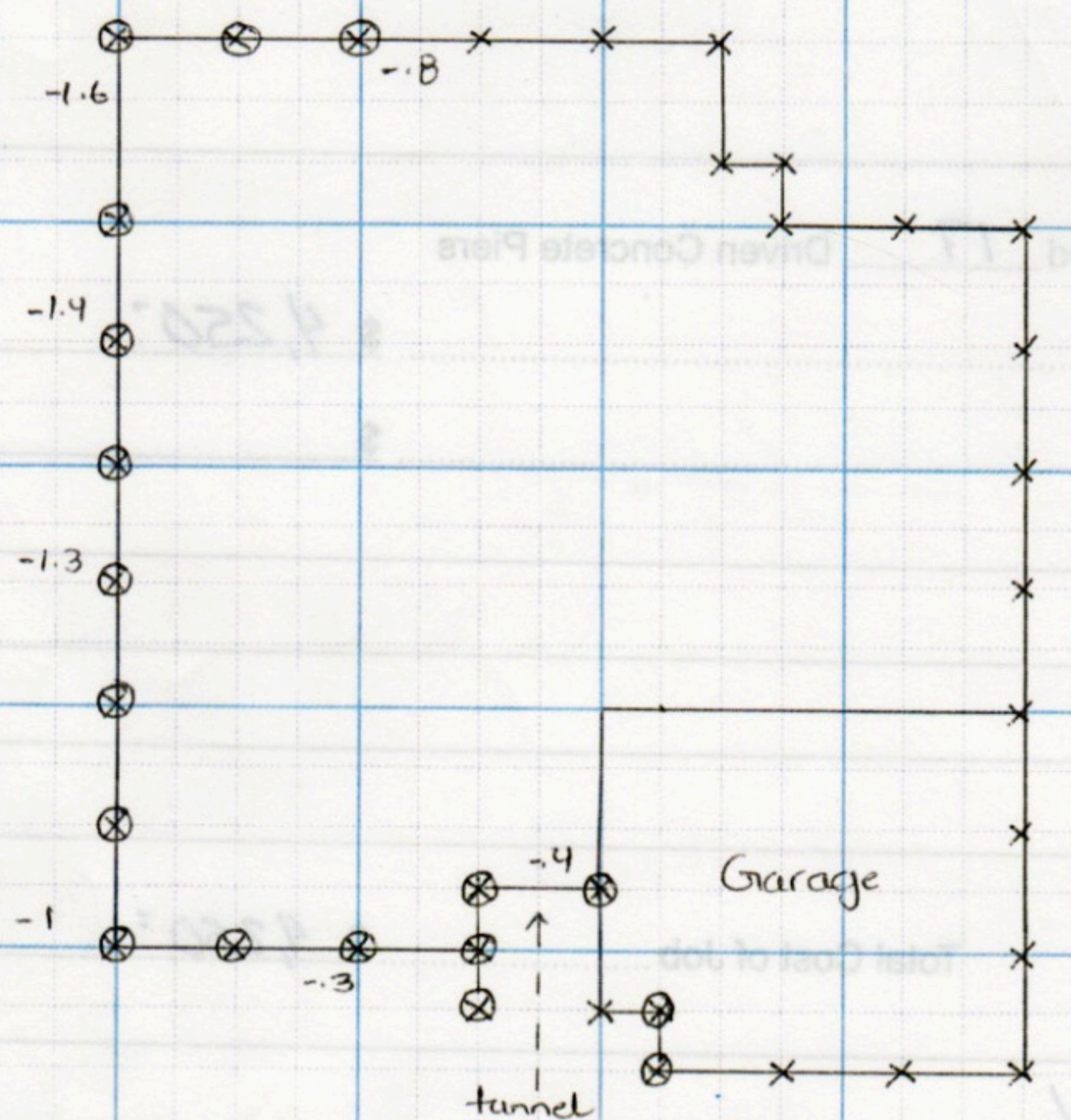

⊗ - 18 exterior piers $X^{\$275} = \4950
 (Optional) 14 ft tunnel $X^{\$125} = \1750
 $\$6,700$

ALLIED FOUNDATION SPECIALIST, INC.
ALLIED PLUMBING LLC
 MPL LIC #39626

NAME Joseph
 ADDRESS 1703 Parkview lane
 CITY ZIP Missouri City, TX 77459
 HOME # _____
 WORK # _____
 CELL # (281) 731-4570

NO. OF PIERS 18 ext.
 BREAKOUTS ~3
 KEY MAP _____
 COST OF JOB \$6,000
 CHECK
 CREDIT CARD

4906 Luella Ave. • Deer Park, TX 77536
 Ph. 281-479-5247
 Fax 281-476-4760

ALL-2013-7-12
 Texas State Board of Plumbing Examiners