

Building Sketch

Borrower	N/A				
Property Address	646 Durham Dr				
City	Conroe	County	Montgomery	State	TX
Zip Code	77302				
Lender/Client	N/A				

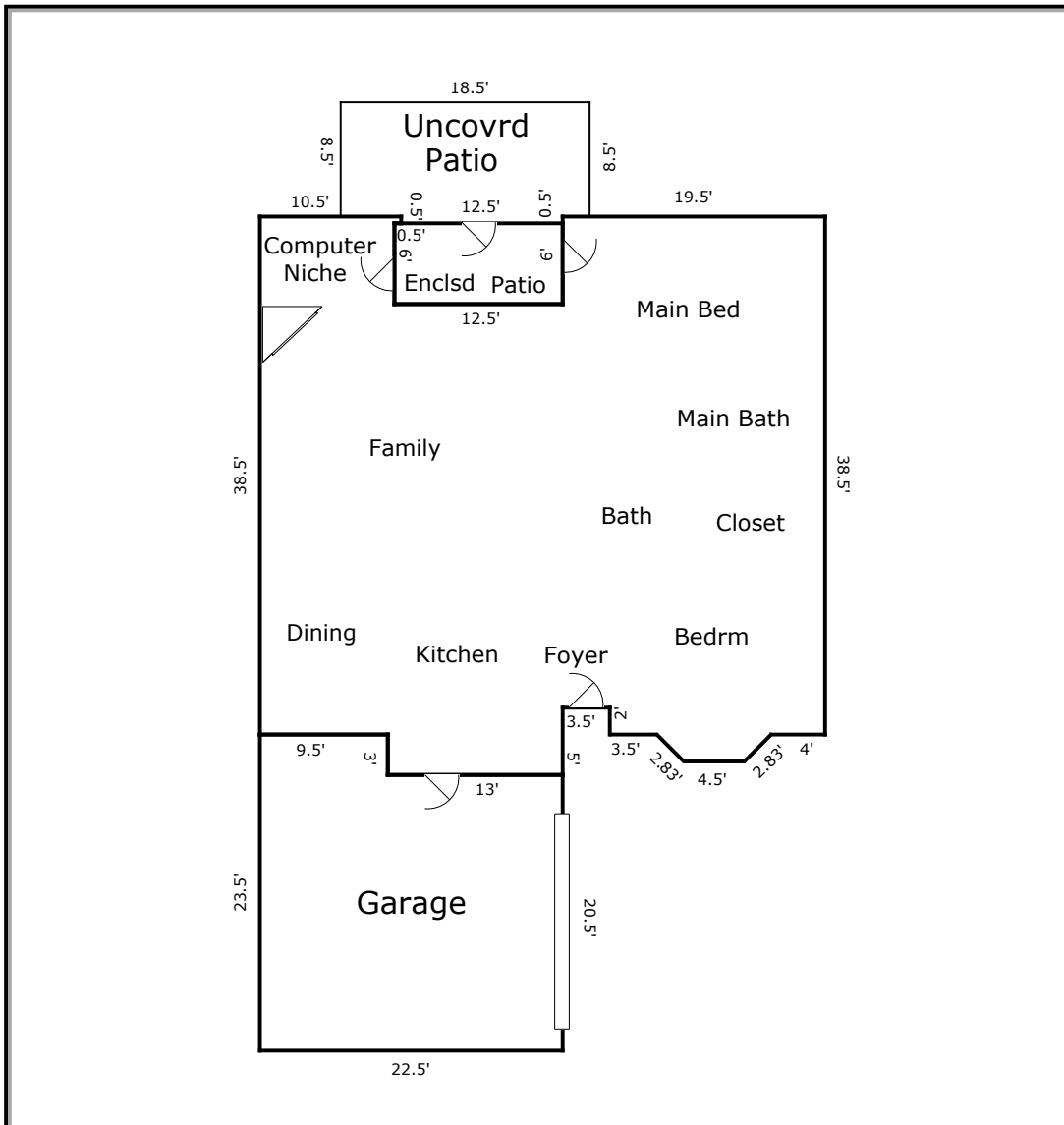

TOTAL Sketch by a la mode, inc.

Area Calculations Summary

Living Area		Calculation Details
First Floor	1581 Sq ft	$0.5 \times 2 \times 2 = 2$ $0.5 \times 2 \times 2 = 2$ $4.5 \times 2 = 9$ $38.5 \times 9.5 = 365.75$ $41.5 \times 0.5 = 20.75$ $35 \times 12.5 = 437.5$ $36.5 \times 3.5 = 127.75$ $38.5 \times 16 = 616$ $0.5 \times 0.5 = 0.25$
Total Living Area (Rounded):	1581 Sq ft	
Non-living Area		
2 Car Attached	489.75 Sq ft	$22.5 \times 20.5 = 461.25$ $9.5 \times 3 = 28.5$
Enclosed Patio	75 Sq ft	$6 \times 12.5 = 75$