

Building Sketch

Borrower	N/A				
Property Address	4910 Brian Haven Dr				
City	Houston	County	Harris	State	TX Zip Code 77018
Lender/Client	N/A				

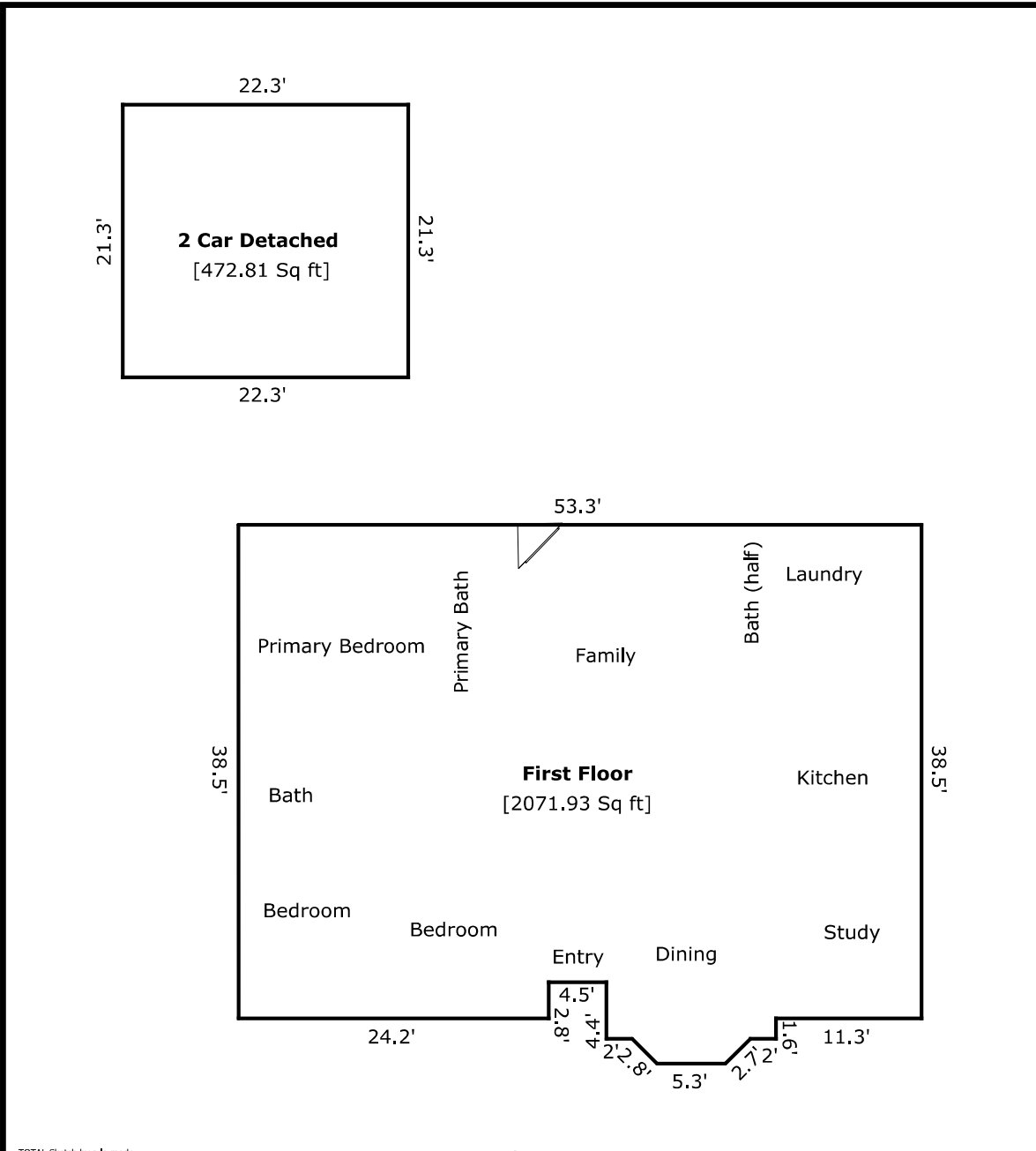

TOTAL Sketch by a la mode

Area Calculations Summary

Living Area	Calculation Details	
First Floor	2071.9 Sq ft	$0.5 \times 1.9 \times 1.9 = 1.9$ $0.5 \times 1.9 \times 1.9 = 1.9$ $5.3 \times 1.9 = 10.4$ $0.5 \times 35.7 \times 0 = 0.5$ $53.2 \times 35.7 = 1898.3$ $4.4 \times 13.2 = 58.4$ $2.8 \times 11.3 = 32.1$ $2.8 \times 24.2 = 68.5$ $0.5 \times 2.8 \times 0 = 0$
Total Living Area (Rounded):	2072 Sq ft	
Non-living Area		
2 Car Detached	472.8 Sq ft	$22.2 \times 21.2 = 472.8$