

Survey of Lot Two (2), of REPLAT OF SANDY POINT, a subdivision in Harris County, Texas, according to the map or plat thereof, recorded at Film Code No. 357048 of the Map Records of Harris County, Texas.

I hereby certify that on the below date, the herein described property, together with improvements located thereon, was surveyed on the ground and under my direction, and that this map, together with dimensions as shown hereon, accurately represents the facts as found on the ground this date.

*Stephen C. Blaskey*

Stephen C. Blaskey  
Registered Professional  
Land Surveyor No. 5856

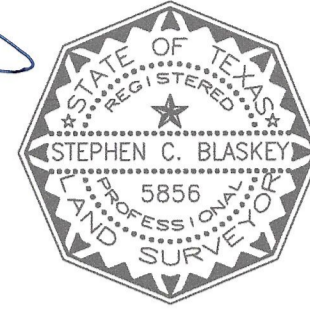

J. HUNTER  
ABST. No. 35  
SURVEY

Latimer Revocable Trust  
Called 1.4993 Acre Tract  
(RP-2017-275279 HCDR)

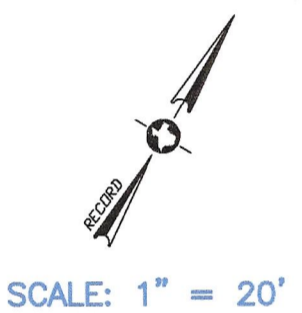

SCALE: 1" = 20'

LEGEND

B.L.	Building Line
Esmt.	Easement
Fnd.	Found
HCDR	Harris County Deed Records
HCMR	Harris County Map Records
Pvt.	Private
U.E.	Utility Easement
W.L.E.	Water Line Easement
	Electric Transformer
	Electric Meter
	Flag Pole
	Gas Meter
	Gate Motor
	Grate Inlet
	Light Pole
	Mail Box
	Telephone Pedestal
	Water Meter
	Metal Fence
	Wood Fence

- NOTES:
- 1) This property lies entirely within Zone "X" Shaded according to FIRM Panel No. 4820100945M, dated January 6, 2017, as established by the Federal Emergency Management Agency.
  - 2) This property is subject to any restrictions of record as established by the City, Plat, or Subdivision Covenants and Restrictions; may also be subject to easements and setbacks for utility services and power lines as individually recorded or established by OSHA (call your power company).
  - 3) Bearings based on Monumentation of the centerline of Sandy Point.
  - 4) Dome Title Insurance, Inc.  
Insured: George Ramirez Velasquez  
CF No.: 2023-30933  
Issue Date: 09/05/2023
  - 5) Schedule B Exceptions from Coverage:  
Item 10 h. Agreement between Point Bayridge corporation and Houston Lighting & Power Company as recorded instrument recorded August 12, 1991 as (instrument) N269007.



LEAGUE CITY OFFICE  
Registration Number: 10193855  
(281) 554-7739 www.hightidelandsurveying.com  
200 HOUSTON AVE, SUITE B | LEAGUE CITY, TX 77573  
Mailing | P.O. BOX 16142 | GALVESTON, TX 77552

SURVEY DATE: SEPTEMBER 8, 2023  
FILE No.: 1173550010002  
DRAFTING: JTK  
JOB No.: 23-0380

