

Lot Fifty-One (51), of TIKI ISLAND, SECTION ELEVEN (11), a subdivision in Galveston County, Texas, according to the map or plat thereof recorded in Volume 1616, Page 193, and transferred to Plat Record 9, Map No. 43, both of the Map Records of Galveston County, Texas.

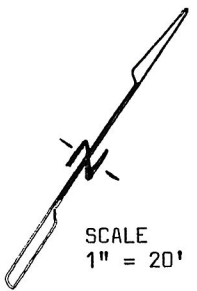

CANAL

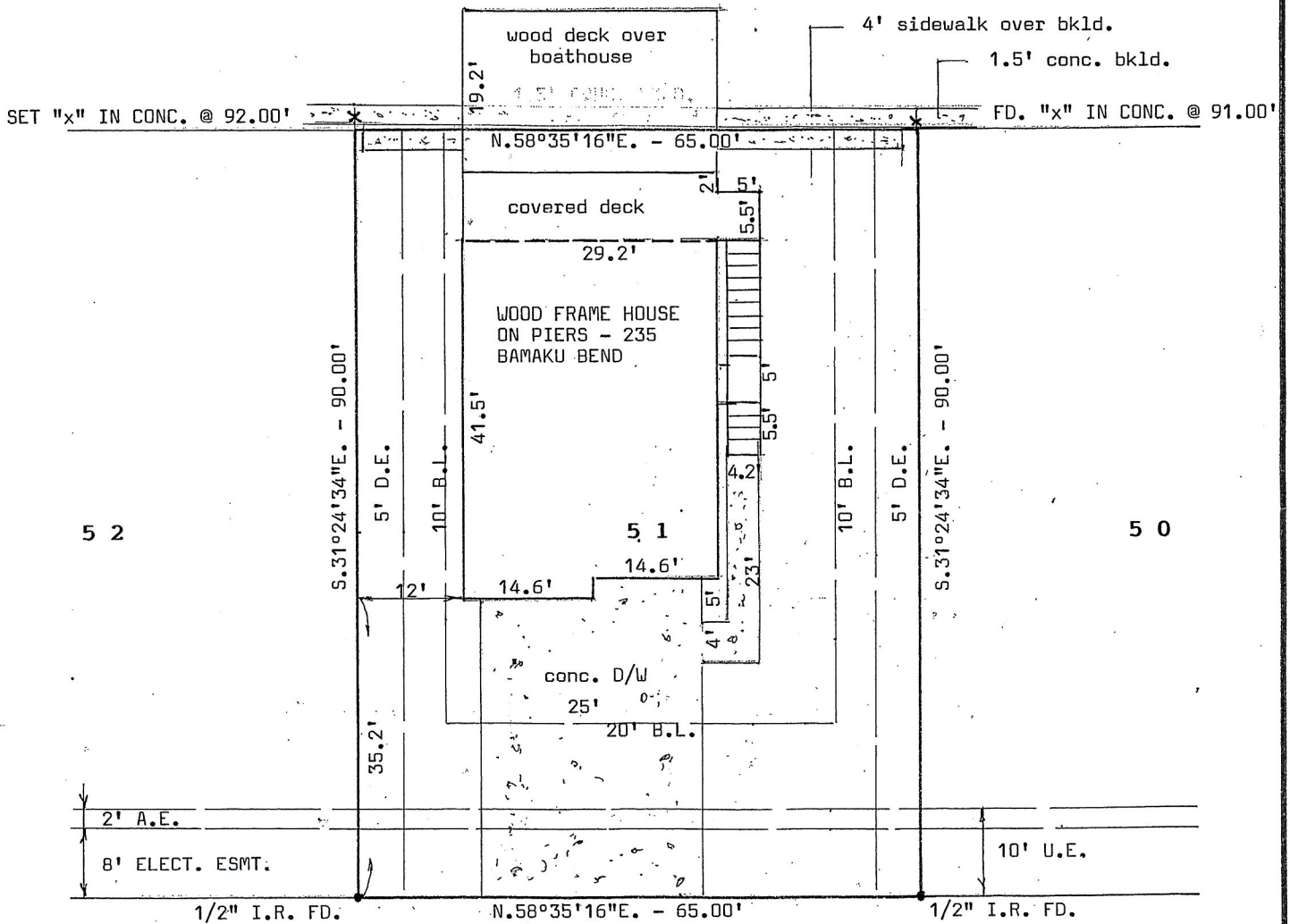

BAMAKU BEND (50' R.O.W.)

I hereby certify that this is a plat on the above property indicating improvements thereon which was prepared under my supervision from a survey made on the ground on February 25, 2020.

