

Building Sketch (Page - 1)

Borrower	Ardee Toppe/Client				
Property Address	7 Pine Lodge Pl				
City	The Woodlands	County	Montgomery	State	TX
Zip Code	77382				
Lender/Client	Ardee Toppe				

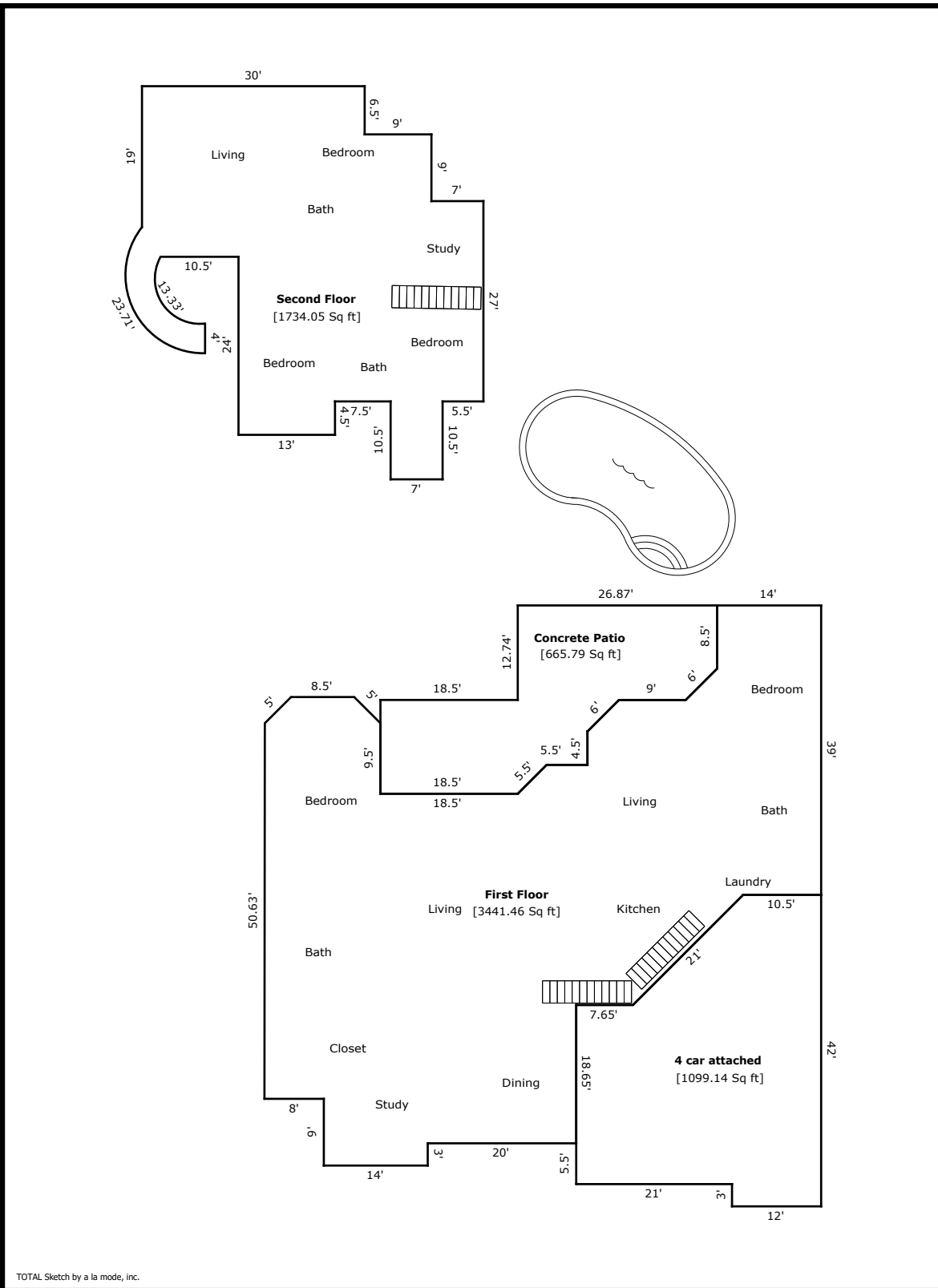

Building Sketch (Page - 2)

Borrower	Ardee Toppe/Client				
Property Address	7 Pine Lodge Pl				
City	The Woodlands	County	Montgomery	State	TX
				Zip Code	77382
Lender/Client	Ardee Toppe				

TOTAL Sketch by a la mode, inc.

Area Calculations Summary

Living Area		Calculation Details
First Floor	3441.46 Sq ft	$14 \times 8.5 = 119$ $30.5 \times 10.5 = 320.25$ $14 \times 3 = 42$ $34 \times 6 = 204$ $3.5 \times 4.24 = 14.85$ $0.5 \times 4.24 \times 4.24 = 9$ $26.26 \times 14.85 = 389.9$ $0.5 \times 14.85 \times 14.85 = 110.25$ $41.11 \times 1.89 = 77.83$ $41.99 \times 12.65 = 531.16$ $0.5 \times 0.01 \times 12.65 = 0.09$ $47.71 \times 28.47 = 1358.62$ $0.5 \times 0.03 \times 28.47 = 0.44$ $8.39 \times 4.24 = 35.59$ $0.5 \times 4.24 \times 4.24 = 9$ $3.89 \times 5.5 = 21.39$ $0.5 \times 3.89 \times 3.89 = 7.56$ $15.57 \times 9.5 = 147.93$ $0.5 \times 0.01 \times 9.5 = 0.05$ $8.5 \times 3.54 = 30.05$ $0.5 \times 3.54 \times 3.54 = 6.25$ $0.5 \times 3.54 \times 3.54 = 6.25$
Second Floor	1734.05 Sq ft	$7 \times 10.5 = 73.5$ $27 \times 7 = 189$ $36 \times 9 = 324$ $42.5 \times 4 = 170$ $47 \times 13 = 611$ $23 \times 10.5 = 241.5$ $0.5 \times (1 + 4) \times 6 = 15$ $0.5 \times 2.5 \times 5 = 6.25$ $19 \times 2.5 = 47.5$ Arc = 81.78 Negative Arc = 25.48
Total Living Area (Rounded):	5176 Sq ft	
Non-living Area		
Concrete Patio	665.79 Sq ft	$12.63 \times 18.5 = 233.69$ $26.87 \times 8.5 = 228.43$ $0.5 \times 4.24 \times 4.24 = 9$ $22.63 \times 4.24 = 96.02$ $0.5 \times 4.24 \times 4.24 = 9$ $9.39 \times 4.24 = 39.83$ $9.39 \times 4.5 = 42.25$ $0.5 \times 3.89 \times 3.89 = 7.56$
4 car attached	1099.14 Sq ft	$0.5 \times 14.85 \times 14.85 = 110.25$ $10.5 \times 14.85 = 155.92$ $33 \times 24.15 = 796.98$ $12 \times 3 = 36$