

Map

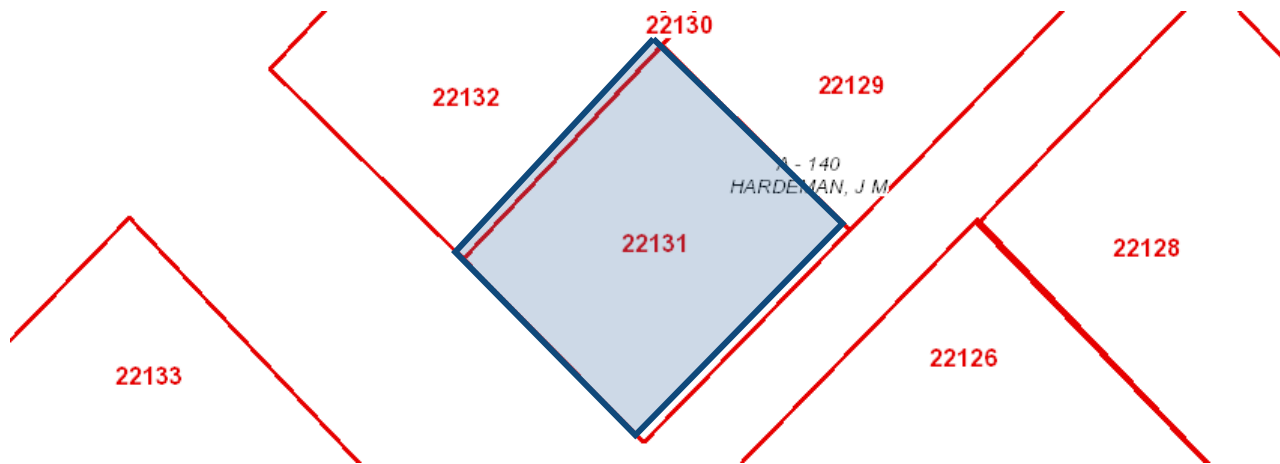

Property Details

|                              |   |  |
|------------------------------|---|--|
| <b>Account</b>               |   |  |
| <b>Property ID:</b>          | 22131   | <b>Geographic ID:</b> 2431-000-011-03000 |
| <b>Type:</b>                 | Real  | <b>Zoning:</b>                           |
| <b>Property Use:</b>         |   | <b>Condo:</b>                            |
| <b>Location</b>              |   |  |
| <b>Situs Address:</b>        | 452 AVE F SOMERVILLE, TX 77879  |  |
| <b>Map ID:</b>               | 32  | <b>Mapsco:</b>                           |
| <b>Legal Description:</b>    | S2431 LANDOLT #7 BLK 11 LOT S 1/2 OF 29 & S 1/2 OF 30, .3444 ACRES SN# 12335993 HUD# PFS0752211 |  |
| <b>Abstract/Subdivision:</b> | S2431 - LANDOLT #7  |  |
| <b>Neighborhood:</b>         | CSMR200   |  |
| <b>Owner</b>                 |   |  |
| <b>Owner ID:</b>             | 104688  |  |
| <b>Name:</b>                 | LEWIS COLTON  |  |
| <b>Agent:</b>                |   |  |
| <b>Mailing Address:</b>      | PO BOX 284<br>SOMERVILLE, TX 77879  |  |
| <b>% Ownership:</b>          | 100.0%  |  |
| <b>Exemptions:</b>           | For privacy reasons not all exemptions are shown online.  |  |

Property Values

|  |              |
|--|--------------|
| <b>Improvement Homesite Value:</b>     | \$15,000 (+) |
| <b>Improvement Non-Homesite Value:</b> | \$0 (+)      |
| <b>Land Homesite Value:</b>            | \$48,900 (+) |
| <b>Land Non-Homesite Value:</b>        | \$0 (+)      |
| <b>Agricultural Market Valuation:</b>  | \$0 (+)      |

|                                   |              |
|-----------------------------------|--------------|
| <b>Market Value:</b>              | \$63,900 (=) |
| <b>Agricultural Value Loss:</b> ⓘ | \$0 (-)      |
| <b>Appraised Value:</b>           | \$63,900 (=) |
| <b>Homestead Cap Loss:</b> ⓘ      | \$0 (-)      |
| <b>Assessed Value:</b>            | \$63,900     |
| <b>Ag Use Value:</b>              | \$0          |

VALUES DISPLAYED ARE 2023 CERTIFIED VALUES.

Information provided for research purposes only. Legal descriptions and acreage amounts are for appraisal district use only and should be verified prior to using for legal purpose and or documents. Please contact the Appraisal District to verify all information for accuracy.

### Property Taxing Jurisdiction

**Owner:** LEWIS COLTON **%Ownership:** 100.0%

| Entity | Description     | Tax Rate | Market Value | Taxable Value |
|--------|-----------------|----------|--------------|---------------|
| CAD    | Burleson CAD    | 0.000000 | \$63,900     | \$63,900      |
| CSM    | Somerville City | 0.676950 | \$63,900     | \$63,900      |
| GBU    | Burleson County | 0.425000 | \$63,900     | \$63,900      |
| HOS    | Memorial Hosp   | 0.057470 | \$63,900     | \$63,900      |
| RDD    | County Road     | 0.075000 | \$63,900     | \$63,900      |
| SSM    | Somerville ISD  | 1.064600 | \$63,900     | \$63,900      |

**Total Tax Rate:** 2.299020

### Property Improvement - Building

**Type:** MOBILE HOME **State Code:** A2 **Living Area:** 1,216.00sqft **Value:** \$15,000

| Type | Description | Class CD | Year Built | SQFT     |
|------|-------------|----------|------------|----------|
| MA   | MA          | MH3      | 2002       | 1,216.00 |

### Property Land

| Type | Description        | Acreage | Sqft      | Eff Front | Eff Depth | Market Value | Prod. Value |
|------|--------------------|---------|-----------|-----------|-----------|--------------|-------------|
| CSM  | CITY OF SOMERVILLE | 0.3444  | 15,000.00 | 75.00     | 200.00    | \$48,900     | \$0         |

### Property Roll Value History

| Year | Improvements | Land Market | Ag Valuation | Appraised | HS Cap Loss | Assessed |
|------|--------------|-------------|--------------|-----------|-------------|----------|
| 2023 | \$15,000     | \$48,900    | \$0          | \$63,900  | \$0         | \$63,900 |
| 2022 | \$22,850     | \$19,650    | \$0          | \$42,500  | \$0         | \$42,500 |
| 2021 | \$43,112     | \$12,900    | \$0          | \$56,012  | \$0         | \$56,012 |
| 2020 | \$45,381     | \$12,900    | \$0          | \$58,281  | \$0         | \$58,281 |
| 2019 | \$46,263     | \$11,250    | \$0          | \$57,513  | \$0         | \$57,513 |
| 2018 | \$29,184     | \$11,250    | \$0          | \$40,434  | \$0         | \$40,434 |
| 2017 | \$14,592     | \$9,000     | \$0          | \$23,592  | \$0         | \$23,592 |
| 2016 | \$1,099      | \$6,000     | \$0          | \$7,099   | \$0         | \$7,099  |
| 2015 | \$2,041      | \$6,000     | \$0          | \$8,041   | \$0         | \$8,041  |
| 2014 | \$2,041      | \$6,000     | \$0          | \$8,041   | \$0         | \$8,041  |
| 2013 | \$2,041      | \$6,000     | \$0          | \$8,041   | \$0         | \$8,041  |

### Property Deed History

| Deed Date | Type | Description                       | Grantor                              | Grantee                              | Volume | Page | Number |
|-----------|------|-----------------------------------|--------------------------------------|--------------------------------------|--------|------|--------|
| 4/6/2023  | SOL  | STATEMENT OF OWNERSHIP & LOCATION | HUESKE JOHN & TRACEY                 | LEWIS COLTON                         | 2023   | 2063 |        |
| 4/26/2022 | WD   | WARRANTY DEED                     | MANTEY PATRICK                       | HUESKE JOHN & TRACEY                 | 2022   | 2565 |        |
| 2/3/2020  | SWD  | SPEC WARRANTY DEED                | MANTEY RICK DALE, JR & PATRICK WAYNE | MANTEY PATRICK                       | 2020   | 1715 |        |
| 9/6/2019  | AH   | AFFIDAVIT HEIRSHIP                | MANTEY RICKY & CONNIE, ESTATE        | MANTEY RICK DALE, JR & PATRICK WAYNE |        |      | 5663   |
| 2/19/2009 | WD   | WARRANTY DEED                     | CONRAD MARTHA                        | MANTEY RICKY & CONNIE, ESTATE        | 770    | 528  | 618    |
| 2/19/2009 | WD   | WARRANTY DEED                     | WEICHERT MICHAEL                     | CONRAD MARTHA                        | 770    | 526  | 617    |