

# HARLIN

(60' RIGHT-OF-WAY)

MAIL BOX

N 51°53'00" E

S 38°07'00" E

N 38°07'00" W

S 51°53'00" W

LOT 23

LOT 24

LOT 25

1 STORY BRICK & FRAME RESIDENCE

EL PASO PIPELINE CORRIDOR

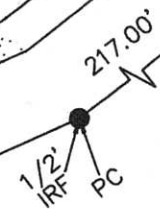

*[Handwritten signature]*

**LEGEND:**

- OPRCC - OFFICIAL PUBLIC RECORDS OF CHAMBERS COUNTY
- AE - AERIAL EASEMENT
- BL - BUILDING LINE
- //— WOOD FENCE
- UE - UTILITY EASEMENT
- [Symbol] CONCRETE
- [Symbol] COVERED CONCRETE
- [Symbol] TELEPHONE PEDESTAL
- [Symbol] WATER METER
- PC - POINT OF CURVATURE
- IRF - IRON ROD FOUND
- CIRS - CAPPED IRON ROD SET

- NOTES:**
1. THE BEARINGS SHOWN HEREON ARE BASED ON THE MAP OR PLAT OF LANAI, SECTION 2, RECORDED UNDER CLERK'S COUNTY NUMBER NO. 2006017916, PLAT RECORDS, CHAMBERS COUNTY, TEXAS.
  2. SURVEYOR DID NOT ABSTRACT PROPERTY. SURVEY BASED ON LEGAL DESCRIPTIONS SUPPLIED BY TITLE COMPANY. EASEMENTS, BUILDING LINES, ETC., SHOWN ARE AS IDENTIFIED BY GF NO. TP1321451 OF TITLE RESOURCES GUARANTY COMPANY.
  3. NOTHING IN THIS SURVEY IS INTENDED TO EXPRESS AN OPINION REGARDING OWNERSHIP OR TITLE.
  4. THE WORD CERTIFY IS UNDERSTOOD TO BE AN EXPRESSION OF PROFESSIONAL JUDGMENT BY THE SURVEYOR, WHICH IS BASED ON HIS BEST KNOWLEDGE, INFORMATION AND BELIEF.
  5. SURVEY IS CERTIFIED FOR THIS TRANSACTION ONLY.
  6. THE FINDINGS AND OPINIONS OF WELLS LAND SURVEY, LLC REFLECTED HEREON ARE PRIVILEGED, CONFIDENTIAL AND INTENDED FOR THE USE OF THE INDIVIDUAL OR ENTITY FOR WHOM THIS WORK WAS PREPARED, IT IS UNDERSTOOD THAT THE USE OF, RELIANCE ON, OR REPRODUCTION OF SAME, IN

PROPERTY LIES WITHIN FLOOD ZONE 'C', ACCORDING TO F.I.R.M. MAP NO. 1401190155C, DATED DECEMBER 2, 1992, BY GRAPHIC PLOTTING ONLY, WELLS