

Building Sketch (Page - 1)

Borrower	RHONDA D SELFRIDGE		
Property Address	7676 Hicks Dairy Rd		
City	Silsbee	County	HARDIN
		State	TX
		Zip Code	77656
Lender/Client	GATEWAY MORTGAGE GROUP, LLC		

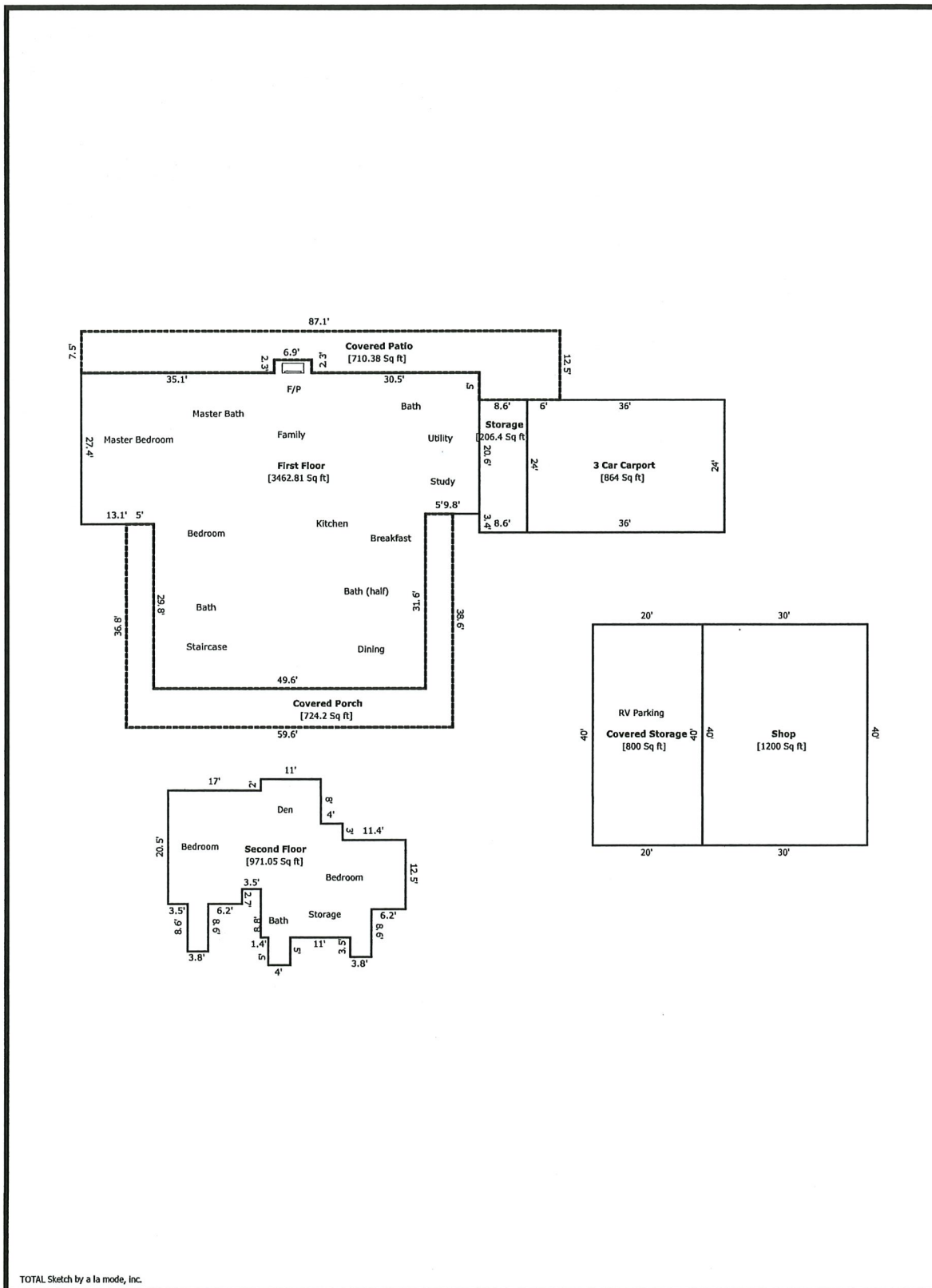

TOTAL Sketch by a la mode, Inc.

Building Sketch (Page - 2)

Borrower	RHONDA D SELFRIDGE						
Property Address	7676 Hicks Dairy Rd						
City	Silsbee	County	HARDIN	State	TX	Zip Code	77656
Lender/Client	GATEWAY MORTGAGE GROUP, LLC						

TOTAL Sketch by a la mode, Inc.

Area Calculations Summary

Living Area	Calculation Details	
First Floor	3462.81 Sq ft	$6.9 \times 2.3 = 15.87$ $49.6 \times 29.8 = 1478.08$ $27.4 \times 62.7 = 1717.98$ $9.8 \times 25.6 = 250.88$
Second Floor	971.05 Sq ft	$3.8 \times 8.6 = 32.68$ $4 \times 5 = 20$ $20.5 \times 13.5 = 276.75$ $17.8 \times 3.5 = 62.3$ $28.6 \times 11 = 314.6$ $20.6 \times 4 = 82.4$ $17.6 \times 1.4 = 24.64$ $21.1 \times 3.8 = 80.18$ $12.5 \times 6.2 = 77.5$
Total Living Area (Rounded):	4434 Sq ft	
Non-living Area		
3 Car Carport	864 Sq ft	$24 \times 36 = 864$
Covered Porch	724.2 Sq ft	$5 \times 31.6 = 158$ $5 \times 29.8 = 149$ $7 \times 59.6 = 417.2$
Shop	1200 Sq ft	$40 \times 30 = 1200$
Storage	206.4 Sq ft	$8.6 \times 24 = 206.4$
Covered Patio	710.38 Sq ft	$12.5 \times 14.6 = 182.5$ $7.5 \times 30.5 = 228.75$ $5.2 \times 6.9 = 35.88$ $35.1 \times 7.5 = 263.25$
Covered Storage	800 Sq ft	$40 \times 20 = 800$