

Scale: 1" = 20'

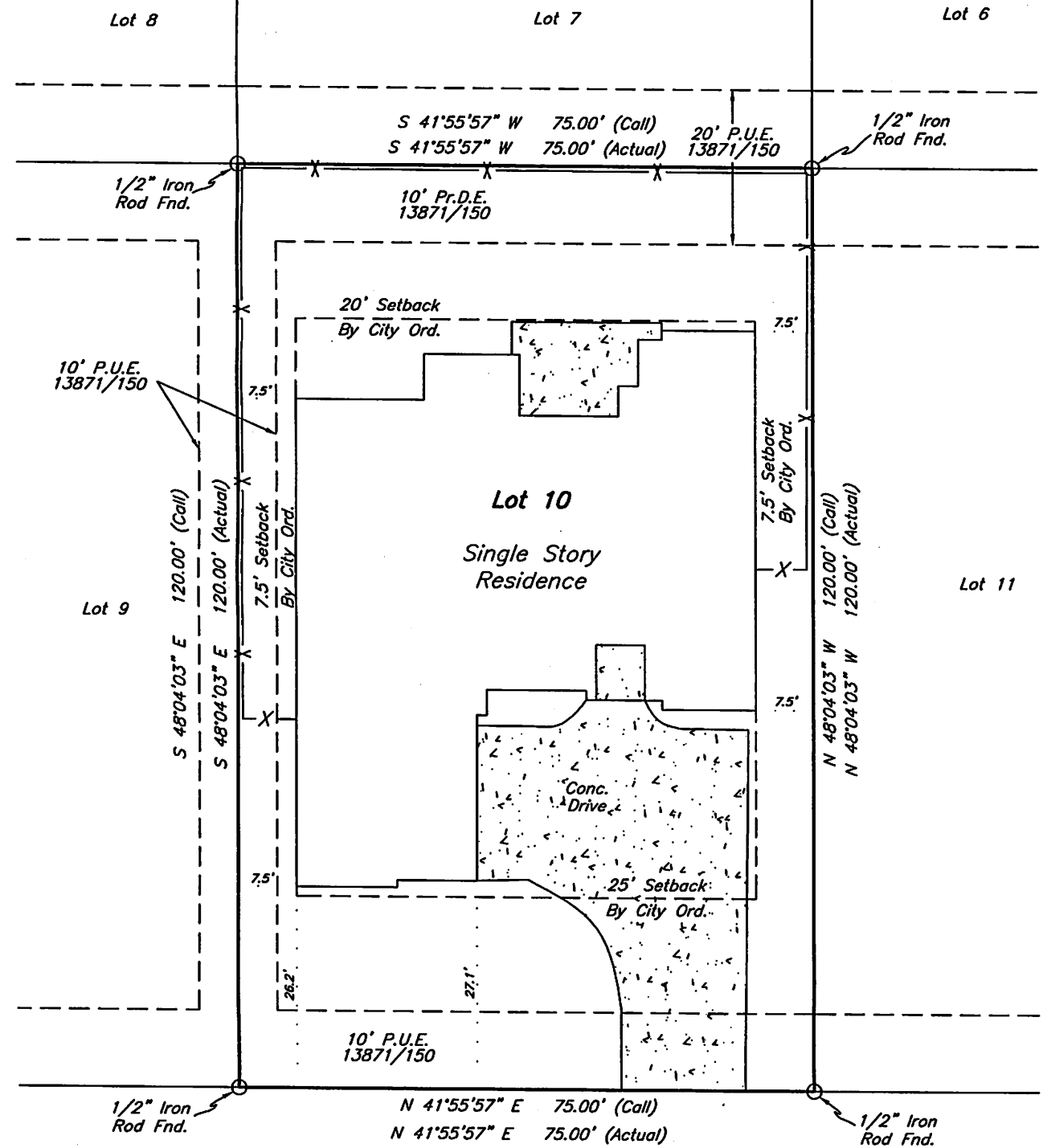

**2703 Wardford Way
Eugene Morris and LaToya Morris**

Being all of Lot 10 (TEN), Block 42 (FORTY TWO), CASTLEGATE II SUBDIVISION, SECTION 209, an addition to the City of College Station, Brazos County, Texas, according to the plat recorded in Volume 13871 Page 150 of the Official Records of Brazos County, Texas.

I, Paul Williams, Registered Professional Land Surveyor No. 5743 do hereby certify that this plat represents the results of a survey performed on the ground, under my supervision on July 25, 2018, and is true and correct to the best of my knowledge.

I further certify that no improvements on this property encroach on adjacent property, nor do any improvements on adjacent property encroach on to this property, except as shown.

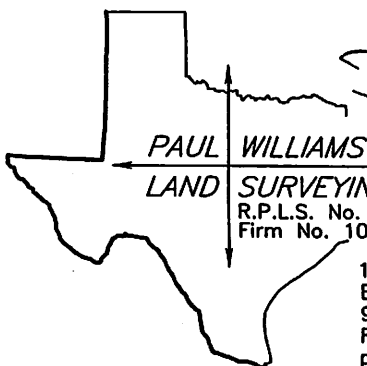

PAUL WILLIAMS
LAND SURVEYING CO.
R.P.L.S. No. 5743
Firm No. 10014300

1851 Briarcrest
Bryan, TX 77802
979-779-7670
Fax 979-779-7672
pwlandsurveying@earthlink.net



Notes:
North orientation is based on rotating to plat calls in 13871/150.

This survey was prepared with the benefit of South Land Title Company Commitment No. G.F. BC1807328 and is valid for this transaction only.

The Following Easements appear to effect the parent tract of this property, however no above ground evidence was located on this survey:

- 1) From W. I. McCulloch to The City of Bryan in 98/179.
- 2) From Mrs. Esther McCulloch Dansby to The City of Bryan in 566/489.