

THOMAS HONEY FARMS INC  
C.F. NO. 2013019158  
O.P.R.L.C.

TRACT 3  
PART OF  
KLINT D. BUSH  
C.F. NO. 2018005954  
O.P.R.L.C.  
0.5735 ACRES  
(24,982 SQ.FT.)  
(VACANT)

TRACT 2  
KLINT D. BUSH  
C.F. NO. 2005011179  
O.P.R.L.C.  
1.6546 ACRES  
(72,076 SQ.FT.)

TRACT 1  
(VACANT)  
RESERVE "A"

CHARLOTTEVILLE  
VOL. 9, PG. 133  
P.R.L.C.

LOT 1

REMAINDER OF  
KLINT D. BUSH  
C.F. NO. 2018005954  
O.P.R.L.C.

COUNTY ROAD 2005  
(60' R.O.W.) (PLATTED AS JOHN DANIEL ROAD)

LEGEND

	CONCRETE		FENCE
	COVERED AREA		WIRE
	WOOD DECK		OVERHEAD UTILITY LINES
	GRAVEL		APPROXIMATE HIGH BANK
	STEPS		B.L. = BUILDING LINE
	WATER		U.E. = UTILITY EASEMENT
	SUNDOG LOGISTICS		D.E. = DRAINAGE EASEMENT
	PETROLEUM PIPELINE MARKER		

- NOTES:
- ALL BEARINGS SHOWN HEREON ARE REFERENCED TO A PRIOR DEED CONVEYED UNTO KLINT D. BUSH AND SHAYLA BUSH, RECORDED IN COUNTY CLERK'S FILE NO. 2005011179 AND 2018005954 OF THE OFFICIAL PUBLIC RECORDS OF LIBERTY COUNTY, TEXAS. POINTS (A) AND (B) WERE HELD FOR HORIZONTAL CONTROL.
  - ABSTRACT INFORMATION FOR THE SUBJECT TRACT WAS PROVIDED BY THE TITLE INSURANCE COMPANY LISTED BELOW. SURVEYOR HAS NOT INDEPENDENTLY RECHECKED SUBJECT PROPERTY.
  - THIS SURVEY IS LIMITED TO THE TITLE INSURANCE COMPANY LISTED BELOW FOR THIS TRANSACTION ONLY. IT IS NOT TRANSFERABLE TO ADDITIONAL INSTITUTIONS OR SUBSEQUENT OWNERS.
  - ALL EASEMENTS AND BUILDING LINES SHOWN ARE FOR THE RECORDED PLAT UNLESS OTHERWISE NOTED.
  - THERE ARE NO NATURAL DRAINAGE COURSES ON SUBJECT PROPERTY.
  - SUBJECT TO THE RESTRICTIVE COVENANTS AS LISTED IN SCHEDULE B OF THE TITLE COMMITMENT ISSUED ON 04-28-23, UNDER G.F. NO. 2808438-H044.

TITLE COMPANY:  
First American Title  
281-328-3239  
G.F. # 2808438-H044 ISSUE DATE 04-28-23

LEGAL DESCRIPTION: TRACT 1: RESERVE "A", OF CHARLOTTEVILLE, A SUBDIVISION IN LIBERTY COUNTY, TEXAS, ACCORDING TO THE MAP OR PLAT THEREOF RECORDED IN VOLUME 9, PAGE 133, OF THE MAP RECORDS OF LIBERTY COUNTY, TEXAS.  
TRACT 2: A TRACT OF LAND CONTAINING 1.6546 ACRES (72,076 SQUARE FEET) SITUATED IN THE JOSE CORONADO LEAGUE, ABSTRACT 14, LIBERTY COUNTY, TEXAS. SAID TRACT BEING MORE PARTICULARLY DESCRIBED BY METES AND BOUNDS AS ATTACHED.  
TRACT 3: A TRACT OF LAND CONTAINING 0.5735 ACRES (24,982 SQUARE FEET) SITUATED IN THE JOSE CORONADO LEAGUE, ABSTRACT 14, LIBERTY COUNTY, TEXAS. SAID TRACT BEING MORE PARTICULARLY DESCRIBED BY METES AND BOUNDS AS ATTACHED.

SURVEYOR'S CERTIFICATE: IN MY PROFESSIONAL OPINION, THIS PLAT REPRESENTS THE FACTS FOUND ON THE GROUND DURING THE COURSE OF A BOUNDARY SURVEY CONDUCTED UNDER MY SUPERVISION ON 06-05-23 AND I AM NOT AWARE OF ANY FACTS OR CIRCUMSTANCES WHICH WOULD CAUSE THIS PLAT TO BE IN VIOLATION OF THE RULES AND REGULATIONS OF THE BOARD OF PROFESSIONAL LAND SURVEYORS AND THAT THERE ARE NO ENCUMBRANCES OR INTERESTS EXCEPT AS SHOWN.

CLIENT: JESSE DEPREIST SR AND MICHELLE DEPREIST  
ADDRESS: 1400 COUNTY ROAD 2005  
www.survey1inc.com  
survey1@survey1inc.com  
281-328-3239

DATE: 06-05-23  
JOB# 5-124212-23

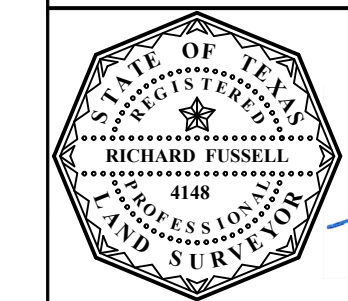

**Survey 1, Inc.**  
Your Land Survey Company  
Firm Registration No. 100758-00  
P.O. Box 2545 | Aledo, TX 77812 | (201)983-1392