

BEING a 10.010 acre tract of land situated in the H. B. GILLY SURVEY, ABSTRACT No. 1259, Hamilton County, Texas and being all of that certain 10.01 acre tract of land described in a Deed to Donna Stockman and being of record in Volume 579, Page 2312, Official Public Records of Hamilton County, Texas and being more particularly described by metes and bounds as follows:

BEGINNING at a 1/2" iron rod with cap stamped "CULPIN" found being the southeast corner of the said 10.01 acre tract and being the southwest corner of that certain 11.010 acre tract of land described in a Deed to Tommy Michael White and Cynthia Michelle White and being of record in Volume 570, Page 670, Official Public Records of Hamilton County, Texas and being in the north right-of-way line of County Road No. 42110 for corner;

THENCE departing the said 11.010 acre tract and with the south boundary line of the said 10.01 acre tract and with the said north right-of-way line the following three ( 3 ) calls:

- 1) N. 62° 05' 25" W., 118.39 feet to a 1/2" iron rod with cap stamped "CULPIN" found being at the beginning of a curve to the left having a radius equals 330.00 feet, chord bearing equals N. 66° 41' 55" W., 51.78 feet for corner;
- 2) 51.84 feet along the arc of said curve to the left to a 1/2" iron rod with cap stamped "CULPIN" found for corner;
- 3) N. 71° 02' 12" W., 89.59 feet to a 1/2" iron rod with cap stamped "CULPIN" found being the southwest corner of the said 10.01 acre tract and being the southeast corner of that certain 10.010 acre tract of land described in a Deed to James Oneal Goldsmith and being of record in Volume 576, Page 99, Official Public Records of Hamilton County, Texas for corner;

THENCE N. 01° 04' 48" W., 694.60 feet departing the said north right-of-way line and with the west boundary line of the said 10.01 acre tract and with the east boundary line of the said 10.010 acre tract to a 1/2" iron rod with cap stamped "CULPIN" found being the northwest corner of the said 10.01 acre tract and being the southwest corner of that certain 10.010 acre tract of land described in a Deed to Barbara Sibrian and being of record in Volume 574, Page 700, Official Public Records of Hamilton County, Texas for corner;

THENCE N. 58° 55' 30" E., 769.33 feet departing the said 10.010 acre Goldsmith tract and with the north boundary line of the said 10.01 acre tract and with the south boundary line of the said 10.010 acre Sibrian tract to a 1/2" iron rod with cap stamped "CULPIN" found being the northeast corner of the said 10.01 acre tract and being the southeast corner of the said 10.010 acre Sibrian tract and being in the west boundary line of that certain 10.010 acre tract of land described in a Deed to Noe Cruz and Delia G. Cruz and being of record in Volume 575, Page 37, Official Public Records of Hamilton County, Texas for corner;

THENCE S. 14° 15' 54" W., 841.74 feet departing the said 10.010 acre Sibrian tract and with the east boundary line of the said 10.01 acre tract and with the west boundary line of the said 10.010 acre Cruz tract to a 1/2" iron rod with cap stamped "CULPIN" found being the southwest corner of the said 10.010 acre Cruz tract and being the northwest corner of the aforementioned 11.010 acre tract for corner;



ENGINEERING • SURVEYING • PLANNING  
301 NORTH 3RD STREET • TEMPLE, TEXAS 76501 • (254) 773-2400  
ENGINEERING FIRM #1658 SURVEY FIRM #10056000

THENCE S. 27° 53' 19" W., 430.84 feet departing the said 10.010 acre Cruz tract and continuing with the east boundary line of the said 10.01 acre tract and with the west boundary line of the said 11.010 acre tract to the Point of BEGINNING and containing 10.010 acres of land.

\*\*\*\*\*

I, Michael E. Alvis, a Registered Professional Land Surveyor in the State of Texas, do hereby certify that these field notes are a correct representation of a survey made on the ground.

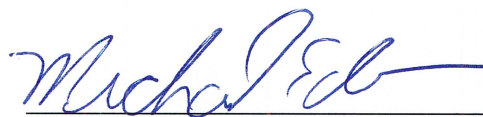

Michael E. Alvis, RPLS#5402  
August 15, 2022

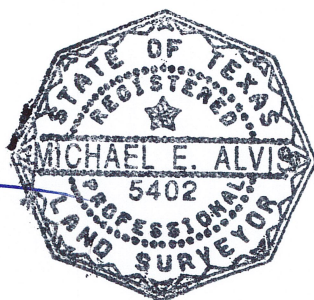

Bearing Base: Texas State Plain Coordinate System ( NAD 1983 ) as determined by G.P.S. observation.