

CLOVER LANE (50' RIGHT-OF-WAY)

**SURVEY PLAT**  
**OF**  
**3610 CLOVER LANE**  
**LOT 3, BLK. 2**  
**GREENWAY PLACE SECTION 1**  
**AS RECORDED IN**  
**VOL. 114, PG. 734 of the**  
**HARRIS COUNTY TAX RECORDS**  
**SCALE 1" = 20'      5-17-93**  
**prepared by M&M SURVEYING CO.**  
**P. O. 1496**  
**PEARLAND, TEXAS 77588**

**OWNER: STEVEN L. McELWEE**  
**DEER PARK, TEXAS**

**NOTE: PROPERTY LIES IN FLOOD ZONE "X"**  
**community # 480291**  
**panel # 0335**  
**suffix G**  
**9-28-90**

I, Mike Morton, a Registered Professional Land Surveyor in the State of Texas do hereby certify that this plat correctly represents the results of an actual survey made on the ground under my direction and that said property has access to a dedicated roadway and that there are no encroachments except as shown.

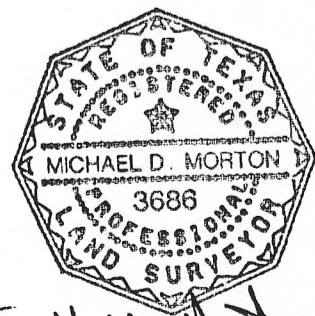

*Handwritten signature of Michael D. Morton*