

# Building Sketch (Page - 1)

Borrower			
Property Address 201 Wildwood Ln			
City	County	State	Zip Code
Lender/Client			

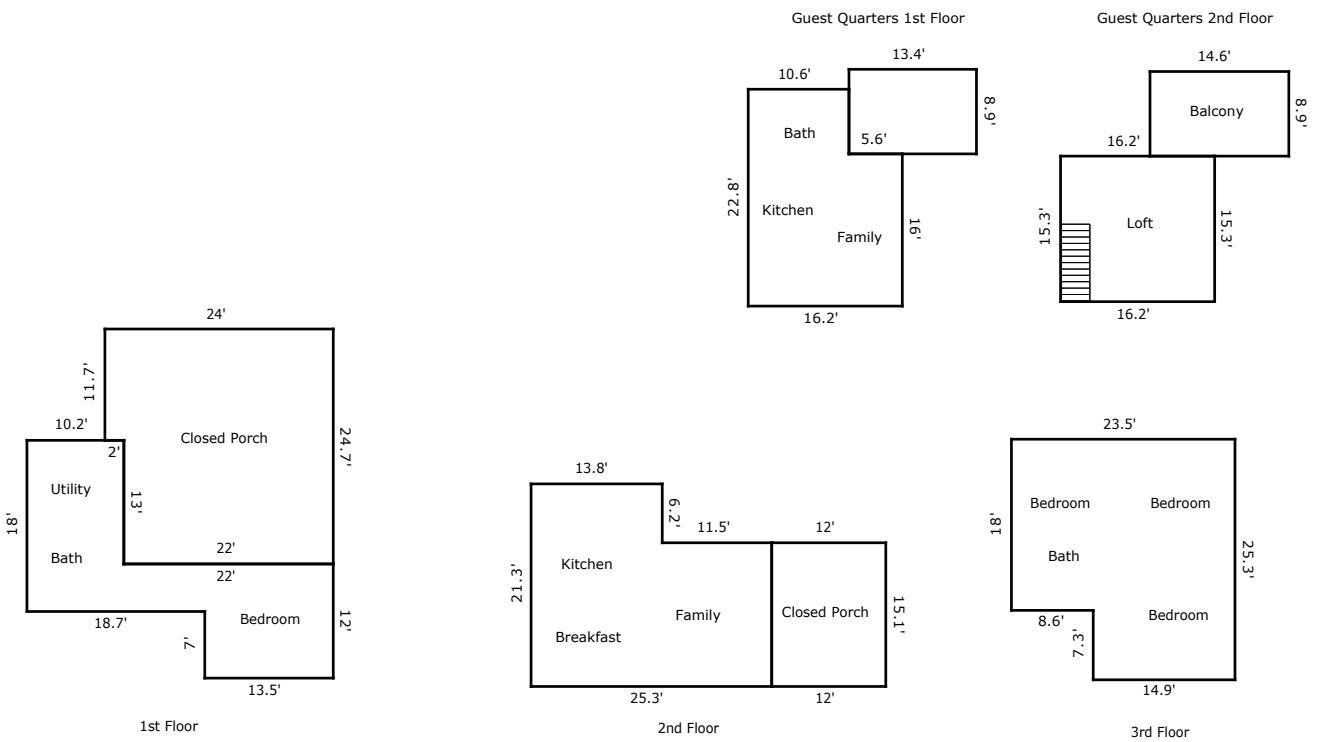

TOTAL Sketch by a la mode

## Building Sketch (Page - 2)

Borrower			
Property Address 201 Wildwood Ln			
City	County	State	Zip Code
Lender/Client			

TOTAL Sketch by a la mode

### Area Calculations Summary

Living Area	Calculation Details		
First Floor	388.1 Sq ft	12 × 13.5 = 162	10.2 × 13 = 132.6
		18.7 × 5 = 93.5	
Second Floor	467.59 Sq ft	15.1 × 11.5 = 173.65	21.3 × 13.8 = 293.94
Third Floor	531.77 Sq ft	23.5 × 18 = 423	7.3 × 14.9 = 108.77
<b>Total Living Area (Rounded):</b>	<b>1387 Sq ft</b>		
Non-living Area			
Closed Porch	119.26 Sq ft	13.4 × 8.9 = 119.26	
Open Porch	129.94 Sq ft	8.9 × 14.6 = 129.94	
Closed Porch	566.8 Sq ft	24.7 × 22 = 543.4	2 × 11.7 = 23.4
Closed Porch	181.2 Sq ft	15.1 × 12 = 181.2	
Guest Quarters	331.28 Sq ft	10.6 × 6.8 = 72.08	16.2 × 16 = 259.2
		0.5 × 16.2 × 0 = 0	
Guest Quarters	247.86 Sq ft	16.2 × 15.3 = 247.86	

**STATE CERTIFICATE**



**Certified Residential  
Real Estate Appraiser**

Appraiser: **Jacob Alfonso Casanova**

License #: **TX 1338514 R**

License Expires: **09/30/2025**

Having provided satisfactory evidence of the qualifications required by the Texas Appraiser Licensing and Certification Act, Occupations Code, Chapter 1103, authorization is granted to use this title:  
Certified Residential Real Estate Appraiser

For additional information or to file a complaint please contact TALCB at [www.talcb.texas.gov](http://www.talcb.texas.gov).

  
**Chelsea Buchholtz**  
Commissioner