



JENSEN GROVE

3052 Jensen Drive

ASHTON

3 BEDS | 2.5 BATHS | 1,750 SQFT

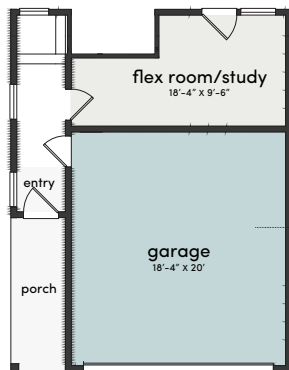

FIRST FLOOR

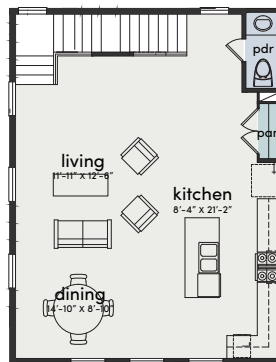

SECOND FLOOR

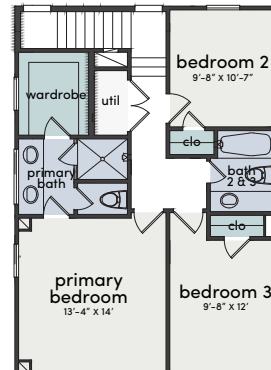

THIRD FLOOR

FOR MORE INFORMATION

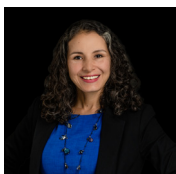

Yenny Labrador

REALTOR®

281.928.1058

yenny@cqhouston.com

MARKETED BY

