

1128 CR 230 (CANAL DRIVE)

**SURVEY PLAT SHOWING
LOT 6 IN BLOCK 22 OF THE
RE-PLAT OF SARGENT BEACH ADDITION
BLOCKS 15-24
VOLUME 2, PAGE 86 OF THE
MATAGORDA COUNTY PLAT RECORDS
WILLIAM BAXTER LEAGUE
ABSTRACT NO. 4
MATAGORDA COUNTY, TEXAS**

FOR RESTRICTIVE COVENANTS NOT SHOWN
HEREON SEE VOLUME 258, PAGE 276 OF
THE MATAGORDA COUNTY DEED RECORDS.

LEGEND

○	EXISTING 5/8" IRON ROD UNLESS NOTED
—E—	OVERHEAD POWERLINE
[]	PLAT OR DEED CALL

I, WESLEY E. GAERTNER, REGISTERED PROFESSIONAL LAND SURVEYOR, DO HEREBY CERTIFY THAT THE PLAT SHOWN HEREON REPRESENTS THE RESULT OF A SURVEY MADE ON THE GROUND UNDER MY DIRECTION ON APRIL 26, 2023.

Wesley Gaertner
G & W ENGINEERS, INC.
WESLEY E. GAERTNER
REGISTERED PROFESSIONAL
LAND SURVEYOR NO. 6483

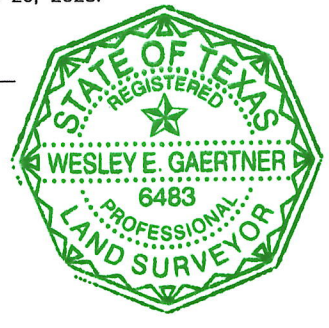

FLOOD DATA
ACCORDING TO THE APPROXIMATE SCALE OF THE NATIONAL FLOOD INSURANCE RATE MAP, COMMUNITY PANEL NO. 48321C0525 F, REVISED JANUARY 15, 2021, THIS PROPERTY IS LOCATED IN ZONES AE & VE.

WOUT VANTELLINGEN

FILE NO.:	10671-001
JOB NO.:	10671-001B
SCALE:	1" = 30'

G & W ENGINEERS, INC.

● ENGINEERING ● SURVEYING ● PLANNING ●

205 W. LIVE OAK STREET, PORT LAVACA, TEXAS 77979
 TBPELS FIRM NO.: 10022100
 (361) 552-4509: PORT LAVACA (979) 323-7100: BAY CITY

DRAWN BY:	M.M.A.
CHECKED BY:	W.E.G.
DATE:	MAY 1, 2023