

**803 Mark "T" Drive
Myron Dean Forland and Debra Joy Forland**

Being all of Lot 13 (THIRTEEN) OF THE NINTH ATLOW ADDITION an addition to the City of Brenham, Washington County, Texas, according to the plat recorded in Plat Cabinet File No. 79A-79B of the Plat Records of Washington County, Texas.
I, Paul Williams, Registered Professional Land Surveyor No. 5743 do hereby certify that this plat represents the results of a survey performed on the ground, under my supervision on June 10, 2010, and is true and correct to the best of my knowledge.
I further certify that no improvements on this property encroach on adjacent property, nor do any improvements on adjacent property encroach on to this property, except as shown.

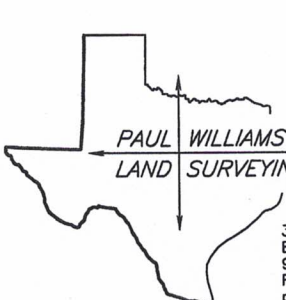

307 South Main Street, Ste. 206
Bryan, TX 77803
979-779-7670
Fax 979-779-7672
pwlandsurveying@earthlink.net

Notes:
North orientation is based on rotating to plat calls in Plat Cabinet File No. 79A-79B of Plat Records.
This survey was performed with the benefit of Washington County Abstract Company Commitment No. G.F. S100436 and is valid for this transaction only.
1) The Easement from Sam D.W. Low and Maggie Low to Texas Power and Light Company in 93/548 does not appear to effect this tract.
2) Aerial Easement 5 feet wide from a plane of 20 feet above ground upward, located adjacent to all easements, per plat.