

TO ALL PARTIES INTERESTED IN TITLE TO THE PREMISES SURVEYED:

I CERTIFY THAT THIS IS A PLAT OF A SURVEY MADE ON THE GROUND OF A LOT CONTAINING 0.1406 AC. KNOWN AS 1140 MERIDIAN LIVINGSTON, 77351. THE PROPERTY OF KATHY CAMPBELL ALFRED SHOWING ACCURATELY ALL IMPROVEMENTS REQUIRED BY THE STATE OF TEXAS IN SPECIFICATION CATEGORY IA, CONDITION II, AS SURVEYED BY ME ON THE GROUND JULY 9, 2012 THE LEGAL DESCRIPTION BEING LOTS 34 & 35 OF LAKE LIVINGSTON VILLAGE SEC. 6, POLK COUNTY, TEXAS, CORRECT OF WHICH IS RECORDED IN VOL. 10, PGS. 15 & 16 OF THE POLK COUNTY PLAT RECORDS. ALL CORNERS ARE MARKED AS SHOWN HEREON. THERE ARE NO FENCES, ENCROACHMENTS, OVERLAPPING OF IMPROVEMENTS, EASEMENTS, RIGHTS-OF-WAY, PAVING, BOUNDARY RECORDS. ALL CONFLICTS, WATERWAYS, OR SHORTAGES IN AREA, EXCEPT AS SHOWN, AND SAID PROPERTY HAS ACCESS TO AND FROM A DEDICATED ROADWAY, EXCEPT AS SHOWN HEREON. LOT LIES IN A ZONE X DESIGNATION, AND IS NOT IN 100 YEAR FLOOD PLAIN, PER COMMUNITY - PANEL 1480526009A FLOOD INFORMATION RATE MAP DATED 08/04/09. FIELD REF: BS. DRAWN BY: CM SCALE: 1" = 20 FT.

**THE MCKINLEY COMPANY, INC**  
 P.O. Box 4218  
 Pasadena, Texas 77502  
 Phone: (713) 473-3602

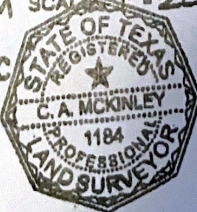

By: C.A. McKinley PRES.  
 C.A. MCKINLEY LICENSE NO. 1184  
 REGISTERED PROFESSIONAL STATE OF TEXAS  
 LAND SURVEYOR

Palm Harbor Homes  
GF-12042984