

Liberty CAD Web Map

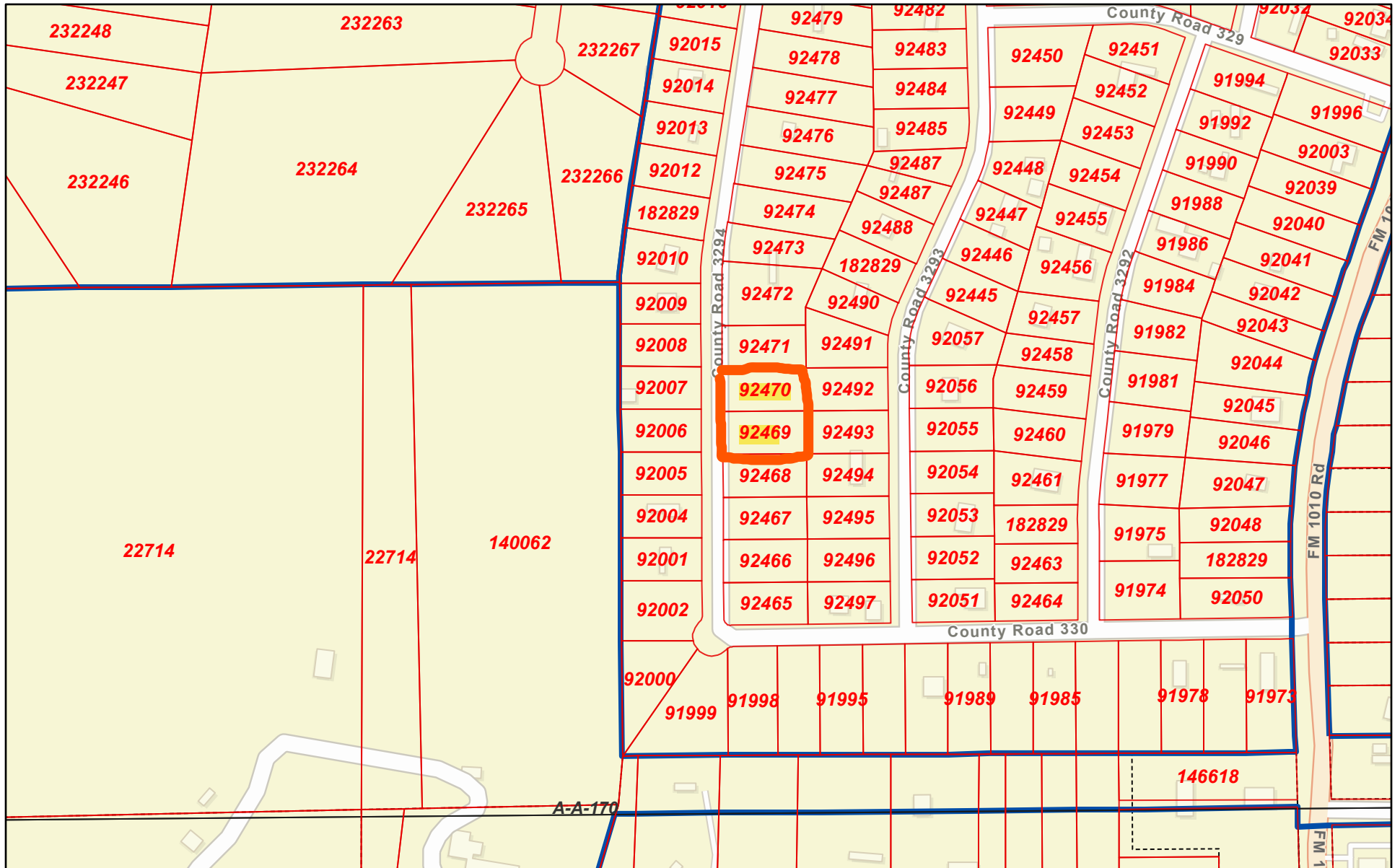

12/4/2023, 7:20:24 PM

-  Parcels
-  Subdivisions
-  Abstracts
-  Lot Lines

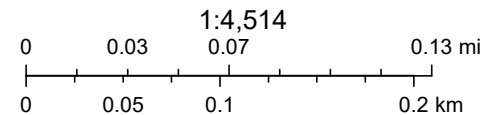

Esri Community Maps Contributors, Texas Parks & Wildlife, © OpenStreetMap, Microsoft, CONANP, Esri, HERE, Garmin, SafeGraph,

Liberty County Appraisal District, BIS Consulting - www.bisconsulting.com

Disclaimer: This product is for informational purposes only and has not been prepared for or be suitable for legal, engineering, or surveying purposes. It does not represent an on-the-ground survey and represents only the approximate relative location of boundaries.