



APPROVED BY THE TEXAS REAL ESTATE COMMISSION (TREC)
LANDLORD'S FLOODPLAIN AND FLOOD NOTICE
 NOTICE: For Use With a Residential Lease, Including a Temporary Residential lease

08-08-2022



CONCERNING THE PROPERTY AT: 23910 Lenz Road

Spring

(Street Address and City)

- A. Landlord is is not aware that the dwelling you are renting is located in a 100-year floodplain. If neither box is checked, you should assume the Property is in a 100-year floodplain. Even if the dwelling is not in a 100-year floodplain, the dwelling may still be susceptible to flooding. The Federal Emergency Management Agency (FEMA) maintains a flood map on its Internet website that is searchable by address, at no cost, to determine if a dwelling is located in a flood hazard area. Most tenant insurance policies do not cover damages or loss incurred in a flood. You should seek insurance coverage that would cover losses caused by a flood.
- B. Landlord is is not aware that the dwelling you are renting has flooded at least once within the last five years.
- C. For purposes of this notice:
- (1) "100-year floodplain" means any area of land designated as a flood hazard area with a one percent or greater chance of flooding each year by the Federal Emergency Management Agency under the National Flood Insurance Act of 1968 (42 U.S.C. Section 4001 et seq.).
 - (2) "Flooding" means a general or temporary condition of partial or complete inundation of a dwelling caused by:
 - (a) the overflow of inland or tidal waters;
 - (b) the unusual and rapid accumulation of runoff or surface waters from any established water source such as a river, stream, or drainage ditch; or
 - (c) excessive rainfall.
 - (3) "Dwelling" means one or more rooms rented for use as a permanent residence under a single lease to one or more tenants.

Brooke Coe 12.10.23

Landlord _____ Date _____ Landlord _____ Date _____

The undersigned Tenant hereby acknowledges receipt of the foregoing notice.

Tenant _____ Date _____ Tenant _____ Date _____

 This form was prepared by the Texas Real Estate Commission in accordance with Texas Property Code §92.0135 and is to be used in conjunction with a residential lease, including a temporary residential lease, entered into or renewed on or after January 1, 2022. Texas Real Estate Commission, P.O. Box 12188, Austin, TX 78711-2188, 512-936-3000 (<http://www.trec.texas.gov>) TREC NO. 54-0

TREC NO. 54-0

23910 Lenze Road, Spring, Texas, 77389-3507 Harris County

Flood Map

Flood Zone Code: **X** Special Flood Hazard Area (SFHA): **Out**
 Flood Zone Date: **10/16/2013** Within 250 Feet of Multiple Flood Zone: **Yes (A,AE,X500,X)**
 Flood Zone Panel: **48201C0235M** Flood Community Name: **HARRIS COUNTY**
 Flood Code Description: **Zone X-An Area That Is Determined To Be Outside The 100- And 500-Year Floodplains.**

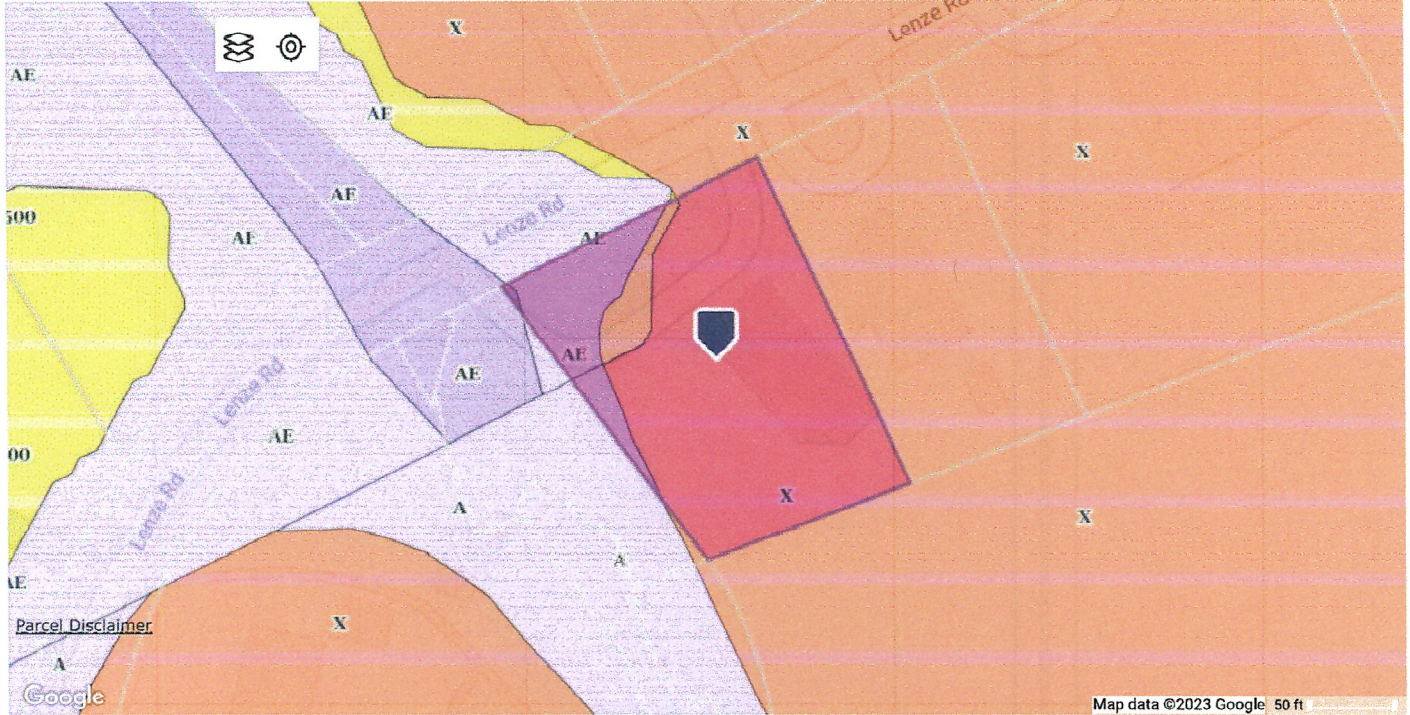

This map/report was produced using multiple sources. It is provided for informational purposes only. This map/report should not be relied upon by any third parties. It is not intended to satisfy any regulatory guidelines and should not be used for this or any other purpose.

Street Number Search is 23910
 Street Name is like 'lenz*'
 Ordered by Status, Current Price
 Found 11 results in 0.02 seconds.