

GF NO. CTH-WD-CTT17679886 CHICAGO TITLE
 ADDRESS: 2452 RIPPLEWOOD DRIVE
 CONROE, TEXAS 77384
 BORROWER: RYAN JOSEPH SHUBATT AND
 ALEXIS PAIGE SHUBATT

LOT 28, BLOCK 1 CARRIAGE HILLS, SECTION 1

A SUBDIVISION IN MONTGOMERY COUNTY, TEXAS
 ACCORDING TO THE MAP OR PLAT THEREOF RECORDED
 IN CABINET B, SHEET 127-B OF THE MAP RECORDS
 OF MONTGOMERY COUNTY, TEXAS



THIS PROPERTY DOES NOT LIE WITHIN THE
 100 YEAR FLOOD PLAIN AS PER FIRM
 PANEL NO. 48339C 0510 G
 MAP REVISION: 08/18/2014
 ZONE X
 BASED ONLY ON VISUAL EXAMINATION OF MAPS.
 INACCURACIES OF FEMA MAPS PREVENT EXACT
 DETERMINATION WITHOUT DETAILED FIELD STUDY

A SUBSURFACE INVESTIGATION
 WAS BEYOND THE SCOPE OF THIS SURVEY

D.C.L. = DIRECTIONAL CONTROL LINE
 RECORD BEARING: CAB. B, SHT. 127-B, M.C.M.R.

I HEREBY CERTIFY THAT THIS SURVEY WAS MADE
 ON THE GROUND, THAT THIS PLAT CORRECTLY
 REPRESENTS THE FACTS FOUND AT THE
 TIME OF SURVEY AND THAT THERE ARE NO
 ENCROACHMENTS APPARENT ON THE GROUND,
 EXCEPT AS SHOWN HEREON. THIS SURVEY IS
 CERTIFIED FOR THIS TRANSACTION ONLY AND
 ABSTRACTING PROVIDED IN THE ABOVE
 REFERENCED TITLE COMMITMENT WAS RELIED
 UPON IN PREPARATION OF THIS SURVEY.

JAMES P. WALKOVIAK
 PROFESSIONAL LAND SURVEYOR
 NO. 5971
 JOB NO. 17-04891
 MAY 9, 2017

DRAWN BY: AC

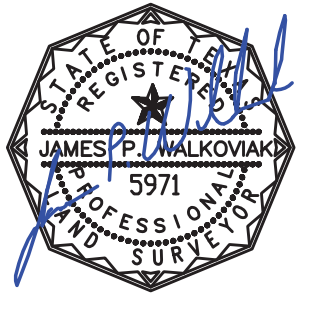

MAGALY MULHERN
 281-364-8110

