

Building Sketch (Page - 1)

Borrower	Susan Tan						
Property Address	1504 Luzon St						
City	Houston	County	Harris	State	TX	Zip Code	77009
Lender/Client	Longhorn Investments						

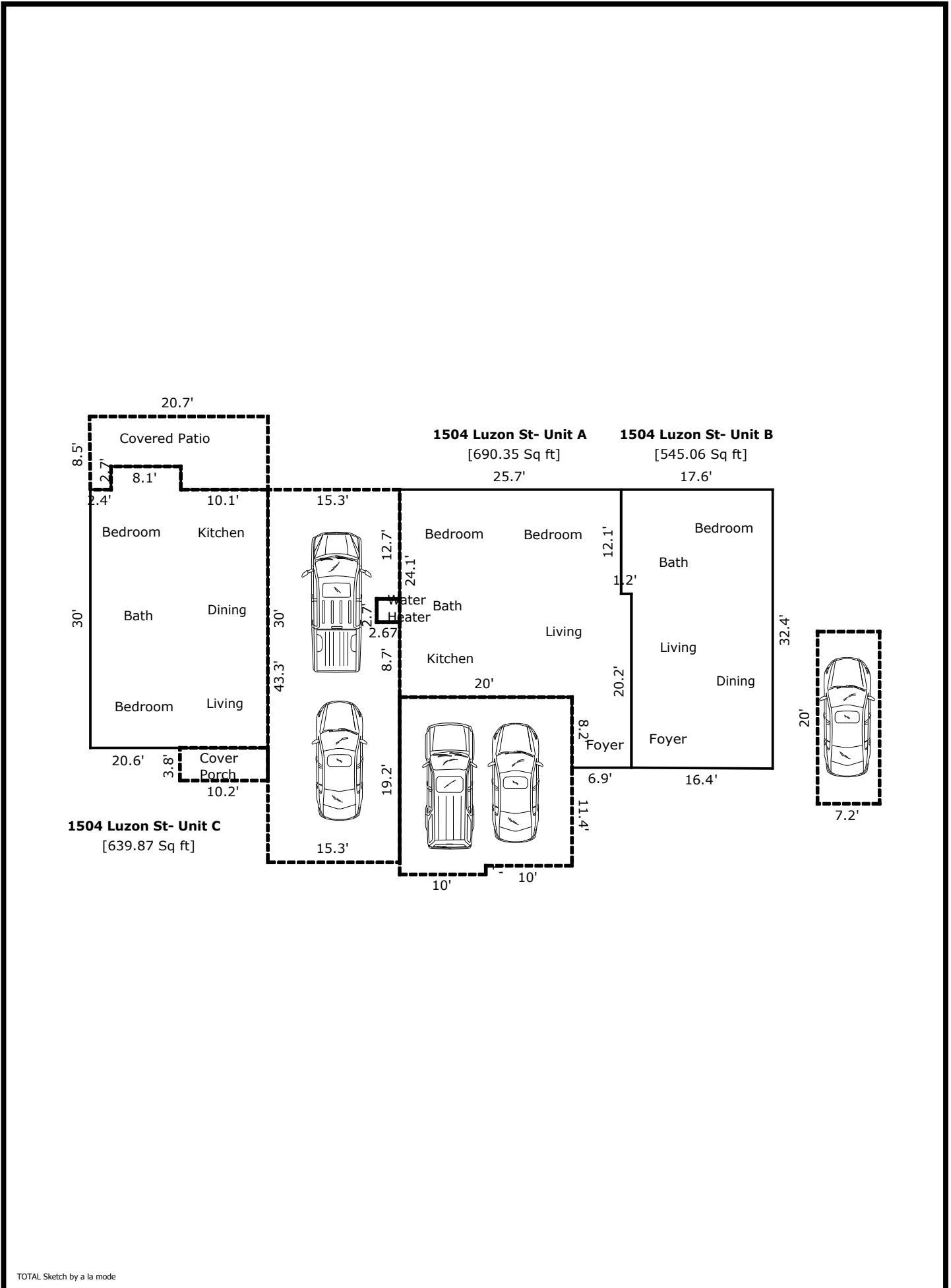

TOTAL Sketch by a la mode

Building Sketch (Page - 2)

Borrower	Susan Tan			
Property Address	1504 Luzon St			
City	Houston	County Harris	State TX	Zip Code 77009
Lender/Client	Longhorn Investments			

TOTAL Sketch by a la mode

Area Calculations Summary

Living Area	Calculation Details		
1504 Luzon St- Unit C	639.87 Sq ft	8.1×2.7	= 21.87
		20.6×30	= 618
1504 Luzon St- Unit A	690.35 Sq ft	6.9×8.2	= 56.58
		24.1×25.7	= 619.37
		12×1.2	= 14.4
1504 Luzon St- Unit B	545.06 Sq ft	17.6×12.1	= 212.96
		16.4×20.2	= 331.28
		$0.5 \times 16.4 \times 0.1$	= 0.82
Covered Porch	38.76 Sq ft	10.2×3.8	= 38.76
Total Living Area (Rounded):	1914 Sq ft		
Non-living Area			
2 Car Carport	655.28 Sq ft	43.3×12.63	= 546.9
		2.67×27.9	= 74.48
		2.67×12.7	= 33.9
2 Car Carport	402 Sq ft	20×19.6	= 392
		10×1	= 10
Driveway	144 Sq ft	7.2×20	= 144
Covered Patio	153.65 Sq ft	$0.5 \times 5.8 \times 0.07$	= 0.2
		20.63×5.8	= 119.66
		2.7×10.1	= 27.27
		2.7×2.4	= 6.48
		$0.5 \times 2.7 \times 0.03$	= 0.04
Water Heater	7.21 Sq ft	2.67×2.7	= 7.21