

Ponce D. [Signature] *Rose [Signature]*

NOTE: Restrictive Covenants as recorded in V-254-A, P-76 Map Records; V-1126, P-291 V-1140, P-550, V-1139, P-485.

BUYER Charlotte M. Jones 7304 Blue Jay Drive

DESCRIBED PROPERTY Lot 14, in Block 2, of SOUTH ACRE MANOR, SECTION 1, a subdivision in Galveston County, Texas, according to the map or plat thereof recorded in Volume 3, Page 47 (formerly Volume 254-A, Page 76) of the Map Records of Galveston County, Texas.

WESTAR LAND SURVEYORS, INC.
 P. O. BOX 669 • ALVIN, TX 77512-0669
 (281) 388-1159 • (888) 339-1159
 G.F. 210-02-1587

Date: 4/18/02
 Inv.#: 5264

JOB# 5264

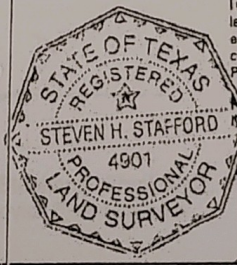

I do hereby certify that this survey was this day made on the ground of the property legally described hereon, (or on the attached sheet), and is correct, and there are no encroachments unless shown, and was done by me or under my supervision, and conforms to or exceeds the current standards as adopted by the Texas Board of Professional Land Surveying.

Note: There are no natural drainage courses on this property.
 Note: This property does not lie in a flood hazard zone according to H.U.D./F.I.A.

485514 0030 C 5/2/83 Zone C

JRD