

GF NO. 17001002-RBS FIRST PRIORITY TITLE  
 ADDRESS: 2111 KNIGHT QUEST DRIVE  
 TOMBALL, TEXAS 77375  
 BORROWER: THOMAS SAWYER APPLEBY

# LOT 12, BLOCK 1 ALBURY TRAILS ESTATES, SECTION 1

A SUBDIVISION IN HARRIS COUNTY, TEXAS  
 ACCORDING TO THE MAP OR PLAT THEREOF RECORDED  
 IN FILM CODE NO. 606119 OF THE MAP RECORDS  
 OF HARRIS COUNTY, TEXAS

SCALE: 1" = 30'



NOTE: AGREEMENT BY AND BETWEEN DEVELOPER AND CENTERPOINT ENERGY FOR INSTALLATION OF OVERHEAD/UNDERGROUND ELECTRICAL DISTRIBUTION SYSTEM AS PER H.C.C.F. NO. 20070102677.

THIS PROPERTY DOES NOT LIE WITHIN THE 100 YEAR FLOOD PLAIN AS PER FIRM PANEL NO. 48201C 0230 L MAP REVISION: 06/18/2007 ZONE X BASED ONLY ON VISUAL EXAMINATION OF MAPS. INACCURACIES OF FEMA MAPS PREVENT EXACT DETERMINATION WITHOUT DETAILED FIELD STUDY

A SUBSURFACE INVESTIGATION WAS BEYOND THE SCOPE OF THIS SURVEY

D.C.L. = DIRECTIONAL CONTROL LINE  
 RECORD BEARING: FILM CODE NO. 606119, H.C.M.R.

DRAWN BY: RE

I HEREBY CERTIFY THAT THIS SURVEY WAS MADE ON THE GROUND, THAT THIS PLAT CORRECTLY REPRESENTS THE FACTS FOUND AT THE TIME OF SURVEY AND THAT THERE ARE NO ENCROACHMENTS APPARENT ON THE GROUND, EXCEPT AS SHOWN HEREON. THIS SURVEY IS CERTIFIED FOR THIS TRANSACTION ONLY AND ABSTRACTING PROVIDED IN THE ABOVE REFERENCED TITLE COMMITMENT WAS RELIED UPON IN PREPARATION OF THIS SURVEY.

PATRICK TREWITT  
 PROFESSIONAL LAND SURVEYOR  
 NO. 5677  
 JOB NO. 17-12126  
 NOVEMBER 17, 2017

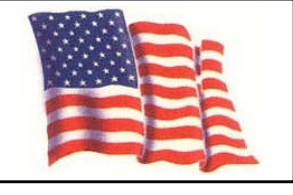
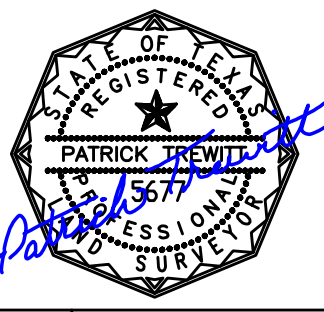

**RE/MAX Integrity**  
**KIMBERLY ROE**  
 281-627-9033

**FIRST PRIORITY TITLE**  
**MATT CREE**  
 281-296-5887

