

- 1 Summer Shores 2 South Point 3 South Lake 4 Waterside
 5 Oak Harbor West 6 Waterside North 7 Shoreline Cove
 8 Oak Harbour 9 Compass Cove 10 Sunset Cove
 11 South Bay Village

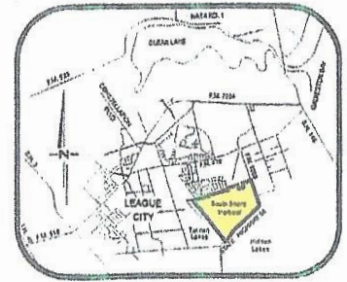

Vicinity Map
N.T.S.



LOT DISTRIBUTION ANALYSIS

| LOT SIZE | NUMBER OF LOTS |
|-----------------|----------------|
| 50' X 115' LOTS | 245 |
| 60' X 115' LOTS | 200 |
| 80' X 115' LOTS | 270 |
| 70' X 150' LOTS | 185 |
| 15' X 125' LOTS | 52 |
| TOTAL | 1,152 |

LAND USE SUMMARY

| Land Use | PLD Land Use | Gross Acreage | % of Gross Acreage | Current Land Use | % of Gross Acreage | % Difference |
|---------------------------------------|------------------|------------------|--------------------|------------------|--------------------|--------------|
| CONTRACTS | | 38.4 Ac. | 7.0% | 41.1 Ac. | 8.6% | +12% |
| South Shore Blvd | 11.2 Ac. | 11.2 Ac. | 2.2% | 11.2 Ac. | 2.3% | 0% |
| Austin Street | 8.7 Ac. | 8.7 Ac. | 1.7% | 8.7 Ac. | 1.8% | 0% |
| Waterside Parkway | 1.1 Ac. | 1.1 Ac. | 0.2% | 1.1 Ac. | 0.2% | 0% |
| Paper's Estate | 7.8 Ac. | 7.8 Ac. | 1.5% | 7.8 Ac. | 1.6% | 0% |
| Thorp Estate | 0.8 Ac. | 0.8 Ac. | 0.2% | 0.8 Ac. | 0.2% | 0% |
| Water Resources Park | 0.9 Ac. | 0.9 Ac. | 0.2% | 0.9 Ac. | 0.2% | 0% |
| COMMUNITY ELEMENTS | | 88.0 Ac. | 17.0% | 81.0 Ac. | 17.1% | -8% |
| Shoreline Center | 2.1 Ac. | 2.1 Ac. | 0.4% | 2.1 Ac. | 0.4% | 0% |
| South Lake | 12.4 Ac. | 12.4 Ac. | 2.5% | 12.4 Ac. | 2.6% | 0% |
| Progressive Detached Home - 145 Units | 33.5 Ac. | 33.5 Ac. | 6.7% | 33.5 Ac. | 7.1% | 0% |
| RESIDENTIAL | | 13.4 Ac. | 2.8% | 6.0 Ac. | 1.3% | -56% |
| Large Single Detached Home | 12.4 Ac. | 12.4 Ac. | 2.5% | 12.4 Ac. | 2.6% | 0% |
| Community Center | 22.9 Ac. | 22.9 Ac. | 4.5% | 22.9 Ac. | 4.9% | 0% |
| Chapelwood | 11.5 Ac. | 11.5 Ac. | 2.4% | 11.5 Ac. | 2.5% | 0% |
| Day Care | 2.2 Ac. | 2.2 Ac. | 0.4% | 2.2 Ac. | 0.4% | 0% |
| MULTI-FAMILY RESIDENTIAL | | 19.0 Ac. | 4.0% | 16.1 Ac. | 3.4% | -15% |
| SINGLE-FAMILY RESIDENTIAL | | 209.8 Ac. | 40.5% | 208.8 Ac. | 44.1% | +12% |
| TOTAL | 577.3 Ac. | 577.3 Ac. | 100.0% | 477.3 Ac. | 100.0% | |

MODEL HOMES
 10 LOTS
 (TYP. 60'x107'0" X 115')
 810.0 Ac.

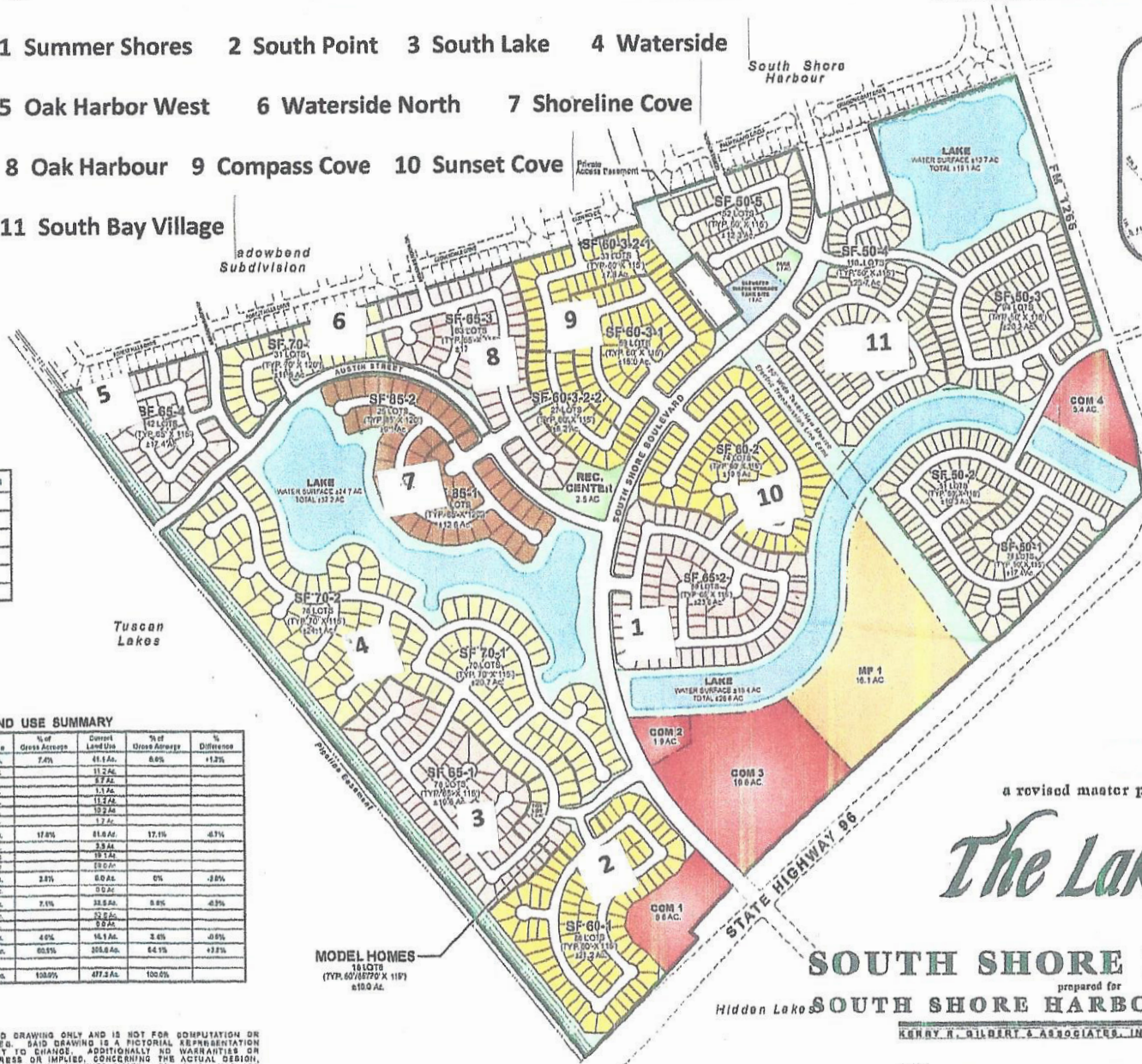

a revised master plan for

The Lakes

SOUTH SHORE HARBOUR
 prepared for
SOUTH SHORE HARBOUR DEV., LTD.

Hidden Lake
 KERRY R. GILBERT & ASSOCIATES, INC.
 Land Planning Consultants
 18810 Park Ten Place
 Suite 160
 Houston, Texas 77064
 (281) 579-0340
 SCALE: 1" = 100'
 MARCH 27, 2007
 HOA E4901-210

THIS MAP IS A SCANNED DRAWING ONLY AND IS NOT FOR COMPUTATION OR CONSTRUCTION PURPOSES. SAID DRAWING IS A PICTORIAL REPRESENTATION ONLY AND IS SUBJECT TO CHANGE. ADDITIONALLY NO WARRANTIES OR REPRESENTATIONS, EXPRESS OR IMPLIED, CONCERNING THE ACTUAL DESIGN, LOCATION OR CHARACTER OF THE FACILITIES SHOWN ON THIS MAP ARE INTENDED. THIS PRESENTATION GRAPHIC REPRESENTS A COMPILATION OF DATUM OBTAINED FROM MAPS, SURVEYS AND OTHER DOCUMENTS PROVIDED TO KERRY R. GILBERT & ASSOCIATES, INC.