

SYMBOLS

- ☒ = CABLE PEDESTAL
- ⊞ = ELECTRIC PEDESTAL
- = SANITARY MANHOLE
- ⊙ = POWER POLE
- * = LIGHT POLE
- △ = TELEPHONE PEDESTAL

LEGEND

- B.B. = BEARING BARS
- ESMT. = EASEMENT
- F.C. = FENCED COMMON ROAD
- F.D.C.F. = FOUND COUNTY CLERK'S FILE
- H.C.M.R. = HARRIS COUNTY MAP RECORDS
- IR. = IRON ROD
- INSIDE PROPERTY LINE
- OUTSIDE PROPERTY LINE

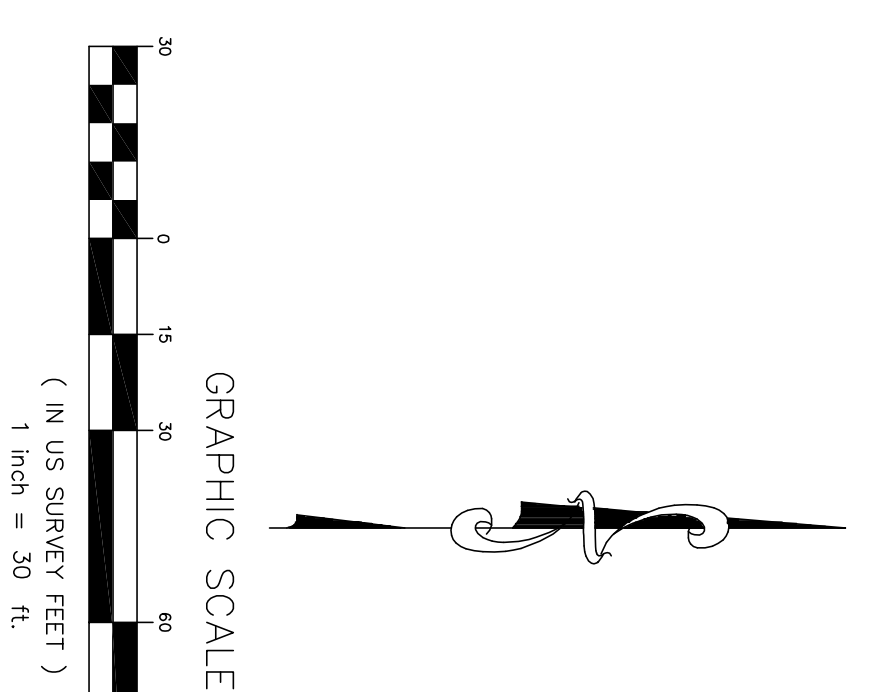

- NOTES:**
- 1.) This survey was prepared without the benefit of a current title report. There may be matters affecting the surveyed tract that are not shown, no additional research was performed by GBI Partners, L.P.
 - 2.) Bearings are referenced to the plot of record for Commons Waterway Sec 4, recorded under Film Code No. 638011 of the Harris County Map Records. Distances are surface values and may be adjusted by applying the combined adjustment factor 0.99994703445.
 - 3.) According to FEMA Flood Insurance Rate Map (FIRM) No. 48201C0310L, map revised June 18, 2007, the surveyed tract lies in Zone AE (BE 52.6) and Zone X (Shaded). Flood zone boundary lines are based on FEMA DTM and should be considered approximate.

BENCHMARK:
 Harris County Floodplain Reference Mark No. 180025
 Brass disc set on concrete guardrail near the southwest corner of the F.M. 2100 bridge crossing Luce Bayou approx. 3 miles north of
 Elevation=54.00' NAVD88 (2001 Adjustment)

T.B.M.:
 P.K. Nail set in asphalt along the north edge of roadway in North Lots 3 and 4, Block 3, Commons Waterway Sec 4.
 Elevation=54.00' NAVD88 (2001 Adjustment)

This is to certify that this map or plat and the survey on which it is based were made on the ground and under my direction, and that this professional service was performed in accordance with the minimum standards promulgated by the Texas Board of Professional Land Surveying. The field work was completed on June 11, 2019.

Kyle B. Duckett
 Registered Professional Land Surveyor
 Texas Registration No. 6390

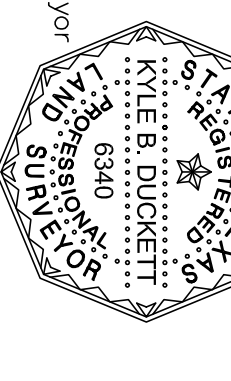

EXISTING CONDITIONS SURVEY
2.313 ACRES

LOTS 3 AND 4, IN BLOCK 2, OF
 COMMONS WATERWAY SEC 4, A SUBDIVISION IN
 HARRIS COUNTY, TEXAS, ACCORDING TO THE
 MAP OR PLAT THEREOF RECORDED IN FILM CODE
 NO. 638011 OF THE HARRIS COUNTY MAP RECORDS.
 LOCATED IN THE
 JAMES H. ISBELL SURVEY, A-474
 HARRIS COUNTY, TEXAS

GBI PARTNERS, L.P.
LAND SURVEYING CONSULTANTS
 4724 VISTA ROAD • PASADENA, TX 77665
 PHONES: 281-469-4839 • GBSurvey@GBISurvey.com
 FBXAS.FIRM #10158000 • www.GBISurvey.com

SCALE: 1" = 30'
 SHEET: 1 OF 1
 FIELD BOOK: 19070
 DATE: 06/24/19
 DWG: 193611