

U.S. DEPARTMENT OF HOMELAND SECURITY
Federal Emergency Management Agency
National Flood Insurance Program

OMB Control No. 1660-0008
Expiration Date: 06/30/2026

ELEVATION CERTIFICATE

IMPORTANT: MUST FOLLOW THE INSTRUCTIONS ON PAGES 9-19

Copy all pages of this Elevation Certificate and all attachments for (1) community official, (2) insurance agent/company, and (3) building owner.

SECTION A – PROPERTY INFORMATION

FOR INSURANCE COMPANY USE

A1. Building Owner's Name: Ryan Little Job# 12-130272-23

Policy Number: _____

A2. Building Street Address (including Apt., Unit, Suite, and/or Bldg. No.) or P.O. Route and Box No.:
812 Lilley Road

Company NAIC Number: _____

City: Algoa State: Texas ZIP Code: 77511

A3. Property Description (e.g., Lot and Block Numbers or Legal Description) and/or Tax Parcel Number:
1.25 Acres I.&G.N.R. Survey Section 29 Abstract 621

A4. Building Use (e.g., Residential, Non-Residential, Addition, Accessory, etc.): Residential

A5. Latitude/Longitude: Lat. 29°23'29.1"N Long. 95°10'39.9"W Horizontal Datum: NAD 1927 NAD 1983 WGS 84

A6. Attach at least two and when possible four clear photographs (one for each side) of the building (see Form pages 7 and 8).

A7. Building Diagram Number: 1B

A8. For a building with a crawlspace or enclosure(s):

a) Square footage of crawlspace or enclosure(s): N/A sq. ft.

b) Is there at least one permanent flood opening on two different sides of each enclosed area? Yes No N/A

c) Enter number of permanent flood openings in the crawlspace or enclosure(s) within 1.0 foot above adjacent grade:
Non-engineered flood openings: N/A Engineered flood openings: N/A

d) Total net open area of non-engineered flood openings in A8.c: N/A sq. in.

e) Total rated area of engineered flood openings in A8.c (attach documentation – see Instructions): N/A sq. ft.

f) Sum of A8.d and A8.e rated area (if applicable – see Instructions): N/A sq. ft.

A9. For a building with an attached garage:

a) Square footage of attached garage: 572 sq. ft.

b) Is there at least one permanent flood opening on two different sides of the attached garage? Yes No N/A

c) Enter number of permanent flood openings in the attached garage within 1.0 foot above adjacent grade:
Non-engineered flood openings: 0 Engineered flood openings: 0

d) Total net open area of non-engineered flood openings in A9.c: N/A sq. in.

e) Total rated area of engineered flood openings in A9.c (attach documentation – see Instructions): N/A sq. ft.

f) Sum of A9.d and A9.e rated area (if applicable – see Instructions): N/A sq. ft.

SECTION B – FLOOD INSURANCE RATE MAP (FIRM) INFORMATION

B1.a. NFIP Community Name: Galveston County Uninc. Areas B1.b. NFIP Community Identification Number: 485470

B2. County Name: Galveston B3. State: Texas B4. Map/Panel No.: 48167C 0220 B5. Suffix: G

B6. FIRM Index Date: 08-15-19 B7. FIRM Panel Effective/Revised Date: 08-15-19

B8. Flood Zone(s): X-Unshaded B9. Base Flood Elevation(s) (BFE) (Zone AO, use Base Flood Depth): N/A

B10. Indicate the source of the BFE data or Base Flood Depth entered in Item B9:

FIS FIRM Community Determined Other: _____

B11. Indicate elevation datum used for BFE in Item B9: NGVD 1929 NAVD 1988 Other/Source: _____

B12. Is the building located in a Coastal Barrier Resources System (CBRS) area or Otherwise Protected Area (OPA)? Yes No
Designation Date: _____ CBRS OPA

B13. Is the building located seaward of the Limit of Moderate Wave Action (LiMWA)? Yes No

ELEVATION CERTIFICATE

IMPORTANT: MUST FOLLOW THE INSTRUCTIONS ON PAGES 9-19

Building Street Address (including Apt., Unit, Suite, and/or Bldg. No.) or P.O. Route and Box No.:
812 Lilley Road

City: **Algoa** State: **Texas** ZIP Code: **77511**

FOR INSURANCE COMPANY USE
Policy Number: _____
Company NAIC Number: _____

SECTION C – BUILDING ELEVATION INFORMATION (SURVEY REQUIRED)

C1. Building elevations are based on: Construction Drawings* Building Under Construction* Finished Construction
*A new Elevation Certificate will be required when construction of the building is complete.

C2. Elevations – Zones A1–A30, AE, AH, AO, A (with BFE), VE, V1–V30, V (with BFE), AR, AR/A, AR/AE, AR/A1–A30, AR/AH, AR/AO, A99. Complete Items C2.a–h below according to the Building Diagram specified in Item A7. In Puerto Rico only, enter meters.
Benchmark Utilized: **Z 53** Vertical Datum: **NAVD 1988**

Indicate elevation datum used for the elevations in items a) through h) below.
 NGVD 1929 NAVD 1988 Other: _____

Datum used for building elevations must be the same as that used for the BFE. Conversion factor used? | Yes No

If Yes, describe the source of the conversion factor in the Section D Comments area.

	Check the measurement used:
a) Top of bottom floor (including basement, crawlspace, or enclosure floor):	<input checked="" type="checkbox"/> feet <input type="checkbox"/> meters
b) Top of the next higher floor (see instructions):	<input type="checkbox"/> feet <input type="checkbox"/> meters
c) Bottom of the lowest horizontal structural member (see Instructions):	<input type="checkbox"/> feet <input type="checkbox"/> meters
d) Attached garage (top of slab):	<input checked="" type="checkbox"/> feet <input type="checkbox"/> meters
e) Lowest elevation of Machinery and Equipment (M&E) servicing the building (describe type of M&E and location in Section D Comments area):	<input type="checkbox"/> feet <input type="checkbox"/> meters
f) Lowest Adjacent Grade (LAG) next to building: <input type="checkbox"/> Natural <input checked="" type="checkbox"/> Finished	<input checked="" type="checkbox"/> feet <input type="checkbox"/> meters
g) Highest Adjacent Grade (HAG) next to building: <input type="checkbox"/> Natural <input checked="" type="checkbox"/> Finished	<input checked="" type="checkbox"/> feet <input type="checkbox"/> meters
h) Finished LAG at lowest elevation of attached deck or stairs, including structural support:	<input type="checkbox"/> feet <input type="checkbox"/> meters

SECTION D – SURVEYOR, ENGINEER, OR ARCHITECT CERTIFICATION

This certification is to be signed and sealed by a land surveyor, engineer, or architect authorized by state law to certify elevation information. I certify that the information on this Certificate represents my best efforts to interpret the data available. I understand that any false statement may be punishable by fine or imprisonment under 18 U.S. Code, Section 1001.

Were latitude and longitude in Section A provided by a licensed land surveyor? Yes No

Check here if attachments and describe in the Comments area.

Certifier's Name: **Richard Fussell** License Number: **4148**

Title: **R.P.L.S**

Company Name: **Survey 1, Inc. Firm#100758-00**

Address: **2408 Mustang Road**

City: **Alvin** State: **Texas** ZIP Code: **77511**

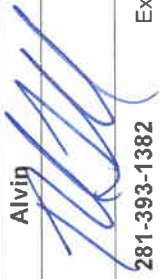
Signature:  Date: **12-15-2023**

Telephone: **281-393-1382** Ext.: **N/A** Email: **survey1@survey1inc.com**



Copy all pages of this Elevation Certificate and all attachments for (1) community official, (2) insurance agent/company, and (3) building owner.

Comments (including source of conversion factor in C2; type of equipment and location per C2.e; and description of any attachments):

- 1). Centerline of Street Elevation - 34.84'
- 2). TBM Elevation - 34.84'
- 3). TBM Location - Mag Nail set in the centerline of Lilley Road near the center of the property
- 4). Pictures are attached, labeled and dated

ELEVATION CERTIFICATE

IMPORTANT: MUST FOLLOW THE INSTRUCTIONS ON PAGES 9-19

Building Street Address (including Apt., Unit, Suite, and/or Bldg. No.) or P.O. Route and Box No.: 812 Lilley Road	FOR INSURANCE COMPANY USE Policy Number: _____ Company NAIC Number: _____
City: Algoa State: Texas ZIP Code: 77511	
SECTION E – BUILDING MEASUREMENT INFORMATION (SURVEY NOT REQUIRED) FOR ZONE AO, ZONE AR/AO, AND ZONE A (WITHOUT BFE)	
<p>For Zones AO, AR/AO, and A (without BFE), complete Items E1–E5. For Items E1–E4, use natural grade, if available. If the Certificate is intended to support a Letter of Map Change request, complete Sections A, B, and C. Check the measurement used. In Puerto Rico only, enter meters.</p> <p>Building measurements are based on: <input type="checkbox"/> Construction Drawings* <input type="checkbox"/> Building Under Construction* <input type="checkbox"/> Finished Construction *A new Elevation Certificate will be required when construction of the building is complete.</p> <p>E1. Provide measurements (C.2.a in applicable Building Diagram) for the following and check the appropriate boxes to show whether the measurement is above or below the natural HAG and the LAG.</p> <p>a) Top of bottom floor (including basement, crawlspace, or enclosure) is: _____ <input type="checkbox"/> feet <input type="checkbox"/> meters <input type="checkbox"/> above or <input type="checkbox"/> below the HAG. b) Top of bottom floor (including basement, crawlspace, or enclosure) is: _____ <input type="checkbox"/> feet <input type="checkbox"/> meters <input type="checkbox"/> above or <input type="checkbox"/> below the LAG.</p> <p>E2. For Building Diagrams 6–9 with permanent flood openings provided in Section A Items 8 and/or 9 (see pages 1–2 of Instructions), the next higher floor (C2.b in applicable Building Diagram) of the building is: _____ <input type="checkbox"/> feet <input type="checkbox"/> meters <input type="checkbox"/> above or <input type="checkbox"/> below the HAG. E3. Attached garage (top of slab) is: _____ <input type="checkbox"/> feet <input type="checkbox"/> meters <input type="checkbox"/> above or <input type="checkbox"/> below the HAG. E4. Top of platform of machinery and/or equipment servicing the building is: _____ <input type="checkbox"/> feet <input type="checkbox"/> meters <input type="checkbox"/> above or <input type="checkbox"/> below the HAG. E5. Zone AO only: If no flood depth number is available, is the top of the bottom floor elevated in accordance with the community's floodplain management ordinance? <input type="checkbox"/> Yes <input type="checkbox"/> No <input type="checkbox"/> Unknown The local official must certify this information in Section G.</p>	
SECTION F – PROPERTY OWNER (OR OWNER'S AUTHORIZED REPRESENTATIVE) CERTIFICATION	
<p>The property owner or owner's authorized representative who completes Sections A, B, and E for Zone A (without BFE) or Zone AO must sign here. <i>The statements in Sections A, B, and E are correct to the best of my knowledge</i></p> <p><input type="checkbox"/> Check here if attachments and describe in the Comments area.</p> <p>Property Owner or Owner's Authorized Representative Name: _____</p> <p>Address: _____</p> <p>City: _____ State: _____ ZIP Code: _____</p> <p>Signature: _____ Date: _____</p> <p>Telephone: _____ Ext.: _____ Email: _____</p> <p>Comments: _____</p>	

ELEVATION CERTIFICATE

IMPORTANT: MUST FOLLOW THE INSTRUCTIONS ON PAGES 9-19

Building Street Address (including Apt., Unit, Suite, and/or Bldg. No.) or P.O. Route and Box No.: 812 Lilley Road		FOR INSURANCE COMPANY USE
City: Algoa	State: Texas ZIP Code: 77511	Policy Number: _____ Company NAIC Number: _____
SECTION G – COMMUNITY INFORMATION (RECOMMENDED FOR COMMUNITY OFFICIAL COMPLETION)		
The local official who is authorized by law or ordinance to administer the community's floodplain management ordinance can complete Section A, B, C, E, G, or H of this Elevation Certificate. Complete the applicable item(s) and sign below when:		
G1. <input type="checkbox"/> The information in Section C was taken from other documentation that has been signed and sealed by a licensed surveyor, engineer, or architect who is authorized by state law to certify elevation information. (Indicate the source and date of the elevation data in the Comments area below.)		
G2.a. <input type="checkbox"/> A local official completed Section E for a building located in Zone A (without a BFE), Zone AO, or Zone AR/AO, or when item E5 is completed for a building located in Zone AO.		
G2.b. <input type="checkbox"/> A local official completed Section H for insurance purposes.		
G3. <input type="checkbox"/> In the Comments area of Section G, the local official describes specific corrections to the information in Sections A, B, E and H.		
G4. <input type="checkbox"/> The following information (Items G5–G11) is provided for community floodplain management purposes.		
G5. Permit Number: _____ G6. Date Permit Issued: _____		
G7. Date Certificate of Compliance/Occupancy Issued: _____		
G8. This permit has been issued for: <input type="checkbox"/> New Construction <input type="checkbox"/> Substantial Improvement		
G9.a. Elevation of as-built lowest floor (including basement) of the building: _____ <input type="checkbox"/> feet <input type="checkbox"/> meters Datum: _____		
G9.b. Elevation of bottom of as-built lowest horizontal structural member: _____ <input type="checkbox"/> feet <input type="checkbox"/> meters Datum: _____		
G10.a. BFE (or depth in Zone AO) of flooding at the building site: _____ <input type="checkbox"/> feet <input type="checkbox"/> meters Datum: _____		
G10.b. Community's minimum elevation (or depth in Zone AO) requirement for the lowest floor or lowest horizontal structural member: _____ <input type="checkbox"/> feet <input type="checkbox"/> meters Datum: _____		
G11. Variance issued? <input type="checkbox"/> Yes <input type="checkbox"/> No If yes, attach documentation and describe in the Comments area.		
The local official who provides information in Section G must sign here. <i>I have completed the information in Section G and certify that it is correct to the best of my knowledge. If applicable, I have also provided specific corrections in the Comments area of this section.</i>		
Local Official's Name: _____		Title: _____
NFIP Community Name: _____		
Telephone: _____		Ext.: _____ Email: _____
Address: _____		
City: _____		State: _____ ZIP Code: _____
Signature: _____		Date: _____
Comments (including type of equipment and location, per C2.e; description of any attachments; and corrections to specific information in Sections A, B, D, E, or H):		

ELEVATION CERTIFICATE

IMPORTANT: MUST FOLLOW THE INSTRUCTIONS ON PAGES 9-19

Building Street Address (including Apt., Unit, Suite, and/or Bldg. No.) or P.O. Route and Box No.:		FOR INSURANCE COMPANY USE	
812 Lilley Road		Policy Number: _____	
City: Algoa	State: Texas	ZIP Code: 77511	Company NAIC Number: _____
SECTION H – BUILDING'S FIRST FLOOR HEIGHT INFORMATION FOR ALL ZONES (SURVEY NOT REQUIRED) (FOR INSURANCE PURPOSES ONLY)			
The property owner, owner's authorized representative, or local floodplain management official may complete Section H for all flood zones to determine the building's first floor height for insurance purposes. Sections A, B, and I must also be completed. Enter heights to the nearest tenth of a foot (nearest tenth of a meter in Puerto Rico). <i>Reference the Foundation Type Diagrams (at the end of Section H Instructions) and the appropriate Building Diagrams (at the end of Section I Instructions) to complete this section.</i>			
H1. Provide the height of the top of the floor (as indicated in Foundation Type Diagrams) above the Lowest Adjacent Grade (LAG):			
a) For Building Diagrams 1A, 1B, 3, and 5-9. Top of bottom _____ <input type="checkbox"/> feet <input type="checkbox"/> meters <input type="checkbox"/> above the LAG floor (include above-grade floors only for buildings with subgrade crawlspaces or enclosure floors) is:			
b) For Building Diagrams 2A, 2B, 4, and 6-9. Top of next higher floor (i.e., the floor above basement, crawlspace, or enclosure floor) is: _____ <input type="checkbox"/> feet <input type="checkbox"/> meters <input type="checkbox"/> above the LAG			
H2. Is all Machinery and Equipment servicing the building (as listed in Item H2 instructions) elevated to or above the floor indicated by the H2 arrow (shown in the Foundation Type Diagrams at end of Section H instructions) for the appropriate Building Diagram? <input type="checkbox"/> Yes <input type="checkbox"/> No			
SECTION I – PROPERTY OWNER (OR OWNER'S AUTHORIZED REPRESENTATIVE) CERTIFICATION			
The property owner or owner's authorized representative who completes Sections A, B, and H must sign here. <i>The statements in Sections A, B, and H are correct to the best of my knowledge. Note: If the local floodplain management official completed Section H, they should indicate in Item G2.b and sign Section G.</i>			
<input type="checkbox"/> Check here if attachments are provided (including required photos) and describe each attachment in the Comments area.			
Property Owner or Owner's Authorized Representative Name: _____			
Address: _____			
City: _____ State: _____ ZIP Code: _____			
Signature: _____ Date: _____			
Telephone: _____ Ext.: _____ Email: _____			
Comments: _____			

ELEVATION CERTIFICATE
IMPORTANT: MUST FOLLOW THE INSTRUCTIONS ON PAGES 9-19
BUILDING PHOTOGRAPHS

See Instructions for Item A6.

Building Street Address (including Apt., Unit, Suite, and/or Bldg. No.) or P.O. Route and Box No.: 812 Lilley Road	FOR INSURANCE COMPANY USE
City: Algoa	Policy Number: _____
State: Texas ZIP Code: 77511	Company NAIC Number: _____

Instructions: Insert below at least two and when possible four photographs showing each side of the building (for example, may only be able to take front and back pictures of townhouses/rowhouses). Identify all photographs with the date taken and "Front View," "Rear View," "Right Side View," or "Left Side View." Photographs must show the foundation. When flood openings are present, include at least one close-up photograph of representative flood openings or vents, as indicated in Sections A8 and A9.



Photo One

Photo One Caption: Front of Home 12-14-2023	Clear Photo One
--	-----------------



Photo Two

Photo Two Caption: Back of Home 12-14-2023	Clear Photo Two
---	-----------------

**ELEVATION CERTIFICATE
BUILDING PHOTOGRAPHS**

IMPORTANT: MUST FOLLOW THE INSTRUCTIONS ON PAGES 9-19

Continuation Page

Building Street Address (including Apt., Unit, Suite, and/or Bldg. No.) or P.O. Route and Box No.: 812 Lilley Road	FOR INSURANCE COMPANY USE
City: Algoa	Policy Number: _____
State: Texas ZIP Code: 77511	Company NAIC Number: _____

Insert the third and fourth photographs below. Identify all photographs with the date taken and "Front View," "Rear View," "Right Side View," or "Left Side View." When flood openings are present, include at least one close-up photograph of representative flood openings or vents, as indicated in Sections A8 and A9.



Photo Three

Photo Three Caption: **Side of Home 12-14-2023**

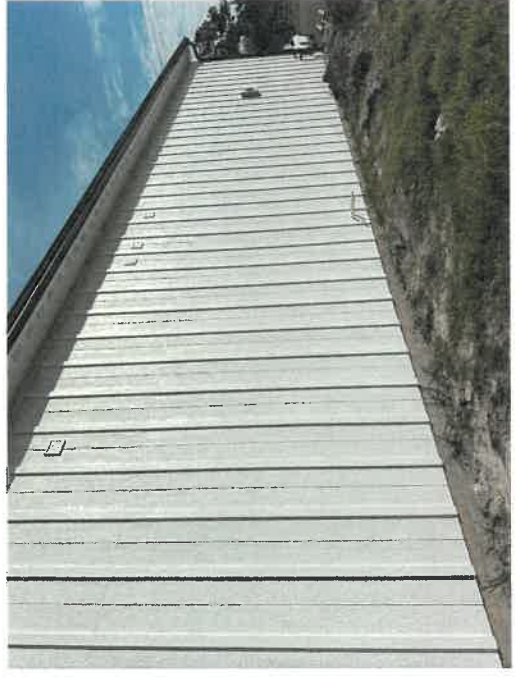

Photo Four

Photo Four Caption: **Side of Home 12-14-2023**