

Building Sketch (Page - 1)

Borrower	Kevin L. Jones			
Property Address	8313 S Kilarney Dr			
City	Beaumont	County	Jefferson	State TX Zip Code 77705
Lender/Client	Kevin L. Jones			

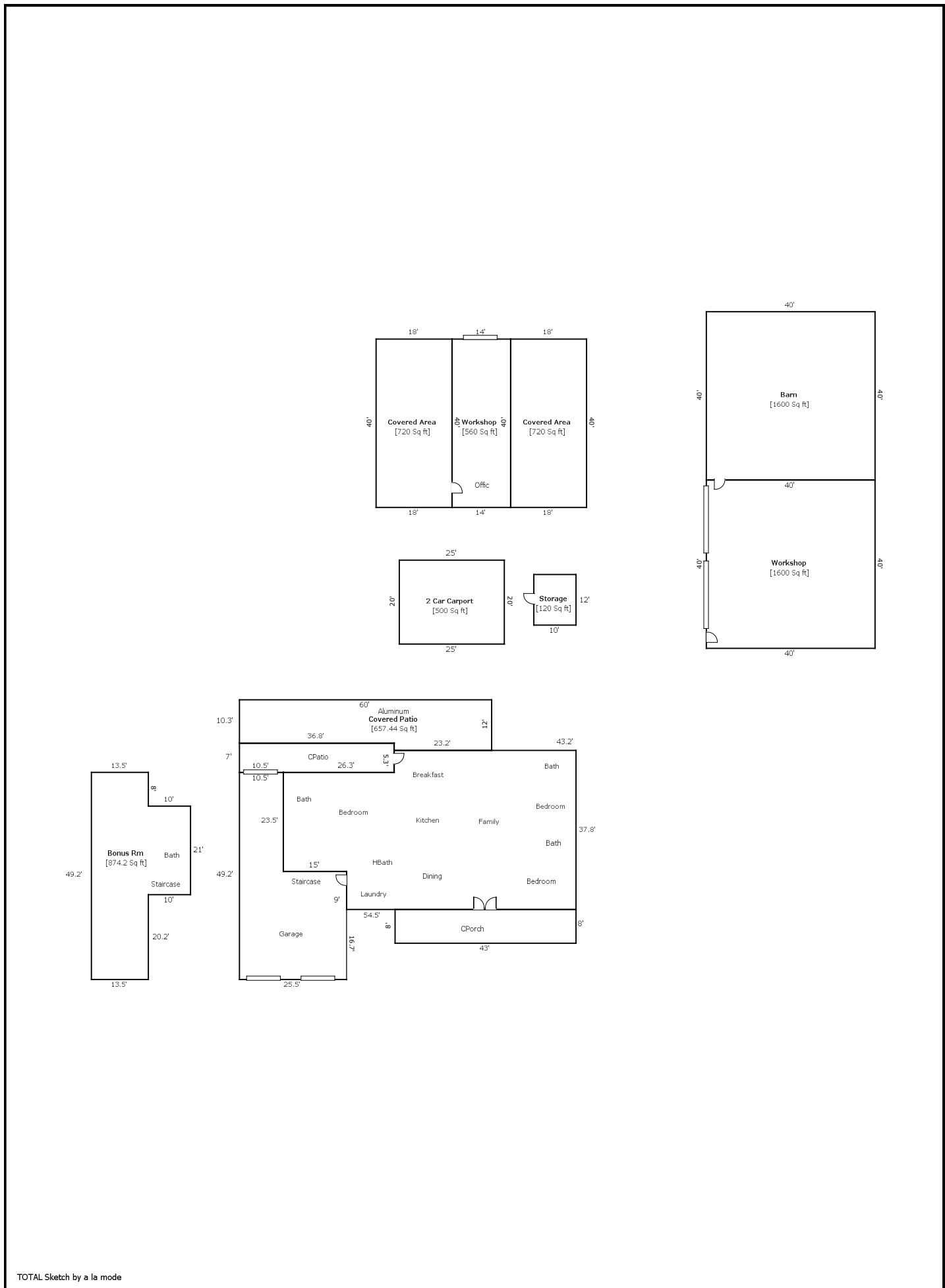

TOTAL Sketch by a la mode

Building Sketch (Page - 2)

Borrower	Kevin L. Jones						
Property Address	8313 S Kilarney Dr						
City	Beaumont	County	Jefferson	State	TX	Zip Code	77705
Lender/Client	Kevin L. Jones						

Living Area	Calculation Details		
First Floor	2352.71 Sq ft		$37.8 \times 43.2 = 1632.96$ $26.3 \times 23.5 = 618.05$ $9 \times 11.3 = 101.7$
Total Living Area (Rounded):	2353 Sq ft		
Non-living Area			
Storage	120 Sq ft		$10 \times 12 = 120$
Covered Porch	257.6 Sq ft		$36.8 \times 7 = 257.6$
Workshop	560 Sq ft		$14 \times 40 = 560$
Barn	1600 Sq ft		$40 \times 40 = 1600$
Workshop	1600 Sq ft		$40 \times 40 = 1600$
Covered Area	720 Sq ft		$18 \times 40 = 720$
2 Car Attached	902.1 Sq ft		$25.5 \times 25.7 = 655.35$ $10.5 \times 23.5 = 246.75$
Covered Porch	344 Sq ft		$43 \times 8 = 344$
Bonus Rm	874.2 Sq ft		$21 \times 10 = 210$ $13.5 \times 49.2 = 664.2$
Covered Patio	657.44 Sq ft		$12 \times 23.2 = 278.4$ $36.8 \times 10.3 = 379.04$
2 Car Carport	500 Sq ft		$20 \times 25 = 500$
Covered Area	720 Sq ft		$40 \times 18 = 720$