

S Mullins
 File #7113625
 OCCGC

- NOTES:
- True ground distances shown
 - Bearings assumed as per Sandusky
 - Survey monuments reconciled w/numerous previous surveys including COG centerline mon.

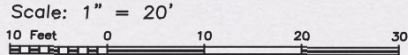

SITE PLAN OF A TRACT OF LAND being the East 1/2 of Lot 3, in the Southeast Block of Outlot 20, in the City and County of Galveston, Texas, according to the plat, in common use, "Plan of the City of Galveston by William Sandusky, 1845".

Vacant property: Avenue M-1/2
 Galveston County, Texas
 This survey is certified for this transaction only and may only be relied on by Sarah Ward. This survey is only valid if print has original seal and signature of surveyor. I hereby certify that this survey was made on the ground under my direct supervision and that this plat correctly represents the facts found at the time of the survey.

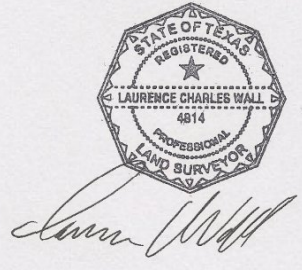

Laurence C. Wall
 RPLS #4814
 March 11, 2021