

# Building Sketch (Page - 1)

Borrower	Nathan Zenero				
Property Address	12303 Adams Run Dr				
City	Cypress	County	Harris	State	TX Zip Code 77429
Lender/Client	Rocket Mortgage, LLC				

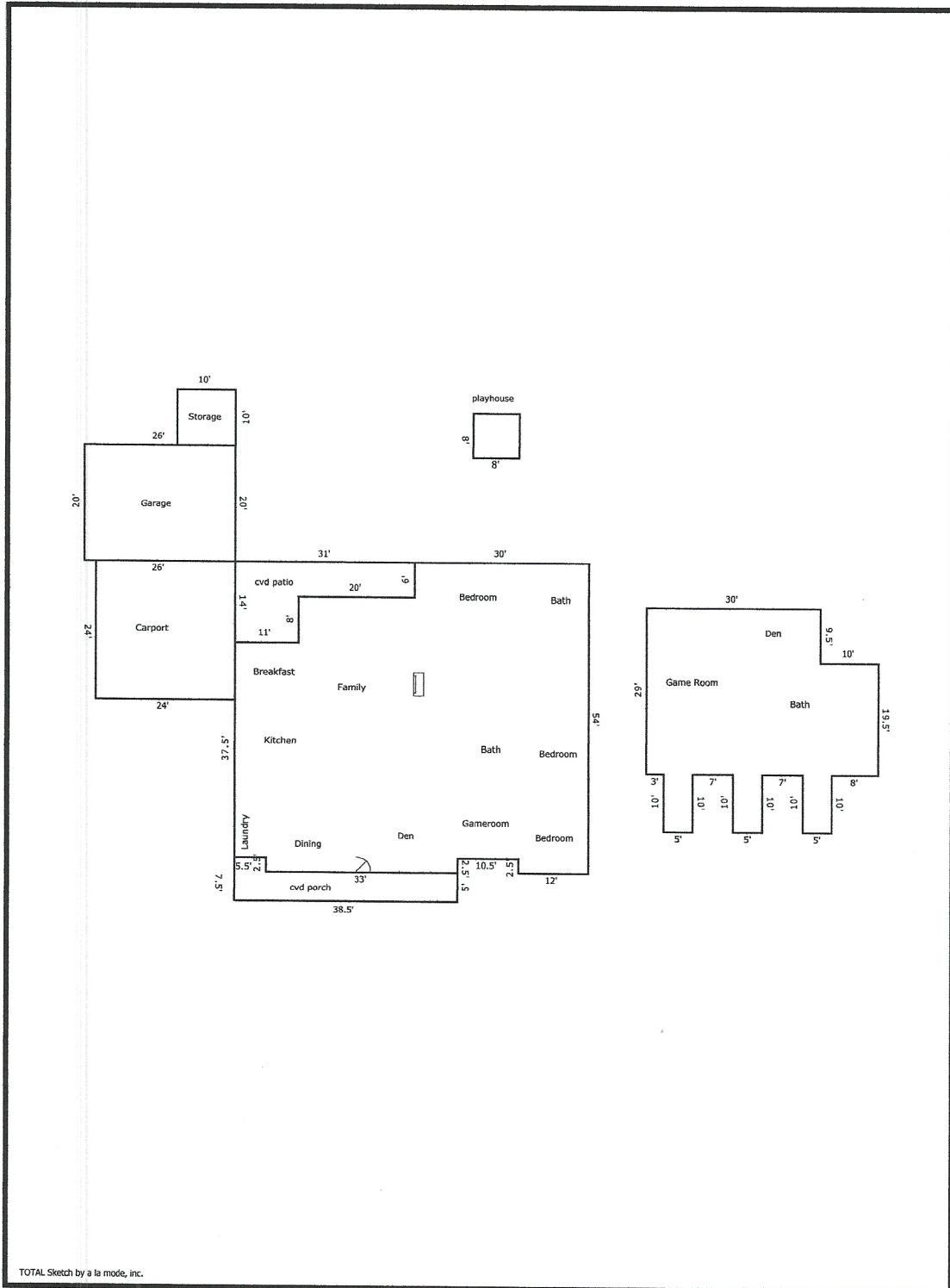

TOTAL Sketch by a la mode, inc.

## Building Sketch (Page - 2)

Borrower	Nathan Zenero		
Property Address	12303 Adams Run Dr		
City	Cypress	County Harris	State TX Zip Code 77429
Lender/Client	Rocket Mortgage, LLC		

TOTAL Sketch by a la mode, Inc.

### Area Calculations Summary

Living Area	Area	Calculation Details
First Floor	2980 Sq ft	$33 \times 2.5 = 82.5$ $37.5 \times 11 = 412.5$ $45.5 \times 20 = 910$ $30 \times 51.5 = 1545$ $2.5 \times 12 = 30$
Second Floor	1215 Sq ft	$5 \times 10 = 50$ $5 \times 10 = 50$ $5 \times 10 = 50$ $29 \times 30 = 870$ $10 \times 19.5 = 195$
<b>Total Living Area (Rounded):</b>	<b>4195 Sq ft</b>	
<b>Non-living Area</b>		
cvd porch	206.25 Sq ft	$7.5 \times 5.5 = 41.25$ $33 \times 5 = 165$
Storage	100 Sq ft	$10 \times 10 = 100$
2 Car Carport	576 Sq ft	$24 \times 24 = 576$
2 Car Detached	520 Sq ft	$20 \times 26 = 520$
cvd patio	274 Sq ft	$14 \times 11 = 154$ $6 \times 20 = 120$
Playhouse	64 Sq ft	$8 \times 8 = 64$