

**4407 Toddington Lane  
Jermaine White and Julie White**

Being all of Lot 4 (FOUR), Block 1 (ONE), CASTLEGATE II SUBDIVISION, SECTION 204, an addition to the City of College Station, Brazos County, Texas, according to the plat recorded in Volume 12633 Page 181 of the Official Records of Brazos County, Texas.

I, Paul Williams, Registered Professional Land Surveyor No. 5743 do hereby certify that this plat represents the results of a survey performed on the ground, under my supervision on October 5, 2016, and is true and correct to the best of my knowledge.

I further certify that no improvements on this property encroach on adjacent property, nor do any improvements on adjacent property encroach on to this property, except as shown.

**PAUL WILLIAMS**  
LAND SURVEYING CO.  
R.P.L.S. No. 5743  
Firm No. 10014300

1851 Briarcrest  
Bryan, TX 77802  
979-779-7670  
Fax 979-779-7672  
pwlndsurveying@earthlink.net

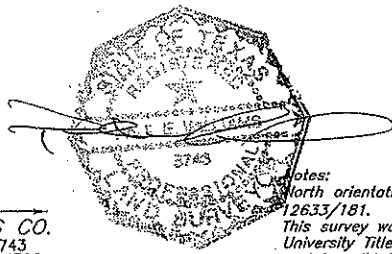

DS  
RSW KHEW

Notes:  
North orientation is based on rotating to plat calls in 12633/181.  
This survey was prepared with the benefit of University Title Company Commitment No. G.F. 167904F and is valid for this transaction only.  
Blanket Easements:  
1) From W. I. McCulloch to The City of Bryan in 98/179.  
2) From Mrs. Esther McCulloch Dansby to The City of Bryan in 566/489.