

FLOORPLAN SKETCH

Borrower: Wang, Walter	File No.: F-81346T-14
Property Address: 1704 Montrose Blvd	Case No.: Loan #0400453031
City: Houston	State: TX
Lender: Nationstar Mortgage LLC., dba Greenlight loans	Zip: 77006

Sketch

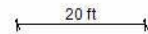
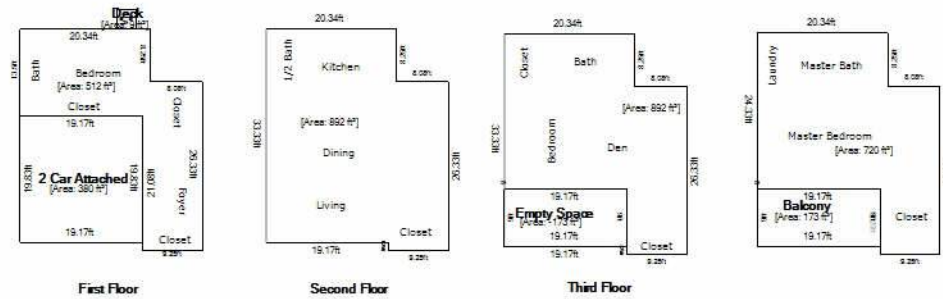

Living Area	Area Calculation			
First Floor	512.00 ft ²	First Floor		x 1.00 = 512.00 ft ²
Second Floor	892.14 ft ² □	21.08ft x	9.25ft x	1.00 = 194.99 ft ²
Third Floor	892.14 ft ² □	13.5ft x	20.34ft x	1.00 = 274.59 ft ²
Empty Space	-172.53 ft ² □	8.08ft x	5.25ft x	1.00 = 42.42 ft ²
Fourth Floor	719.61 ft ²	Second Floor		x 1.00 = 892.14 ft ²
Nonliving Area		8.08ft x	26.33ft x	1.00 = 212.75 ft ²
2 Car Attached	380.14 ft ² □	1.25ft x	1.17ft x	1.00 = 1.46 ft ²
Balcony	172.53 ft ² Δ	33.33ft x	20.34ft x	0.50 = 338.97 ft ²
Deck	9.00 ft ² Δ	33.33ft x	20.34ft x	0.50 = 338.97 ft ²
		Third Floor		x 1.00 = 892.14 ft ²
		8.08ft x	26.33ft x	1.00 = 212.75 ft ²
		1.25ft x	1.17ft x	1.00 = 1.46 ft ²
		Δ 33.33ft x	20.34ft x	0.50 = 338.97 ft ²
		Δ 33.33ft x	20.34ft x	0.50 = 338.97 ft ²
		Empty Space		x -1.00 = -172.53 ft ²
		9ft x	19.17ft x	1.00 = 172.53 ft ²
		Fourth Floor		x 1.00 = 719.61 ft ²
		10.25ft x	9.25ft x	1.00 = 94.81 ft ²
		24.33ft x	20.34ft x	1.00 = 494.87 ft ²
Total Living Area (rounded):	2843 ft² □	8.08ft x	16.08ft x	1.00 = 129.93 ft ²