

7522 Saddle Blanket Drive, Waller, Texas 77484, United States

Gross Living Area: 4653 sq. ft

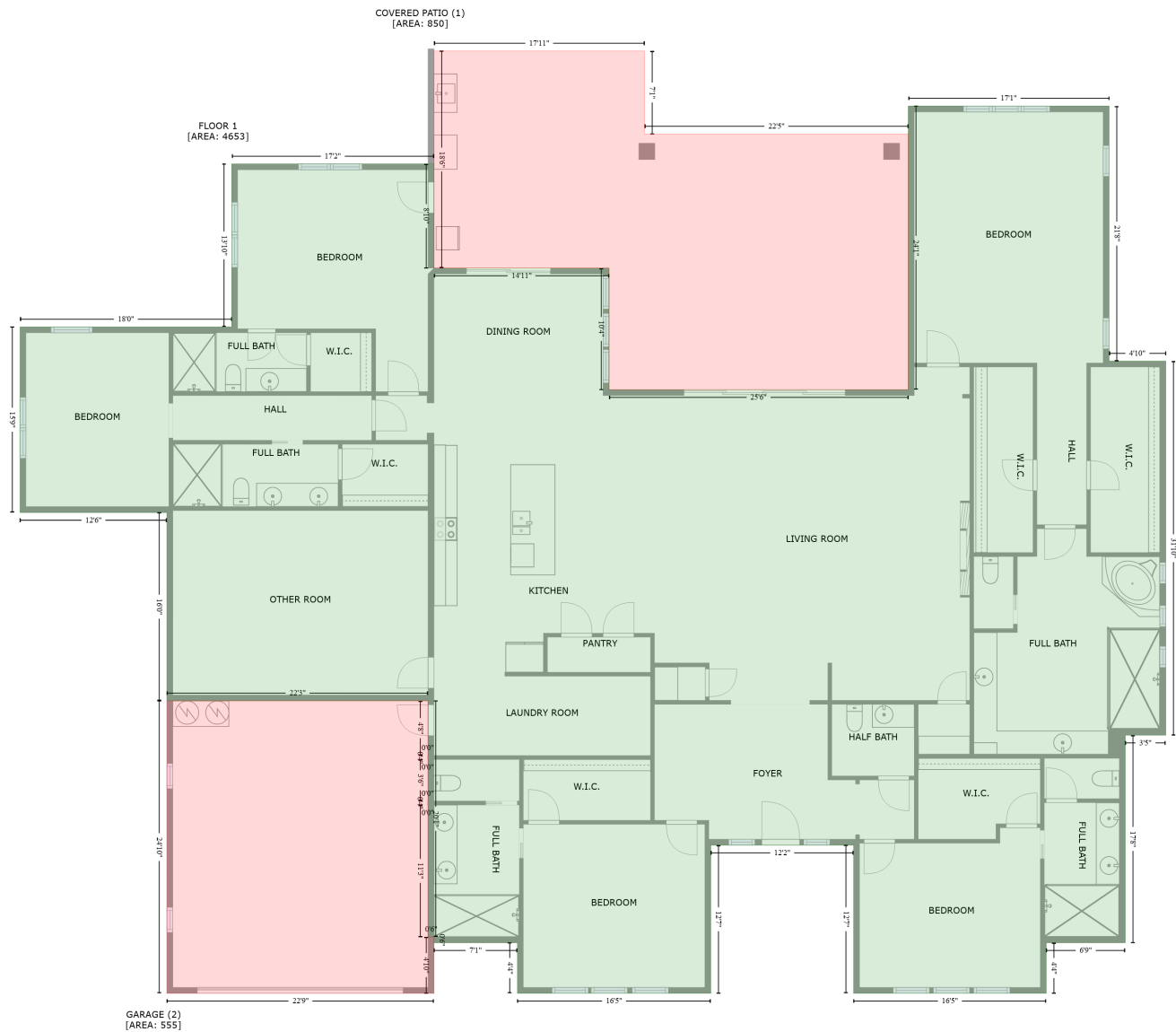

Space	Area (sq. ft)	Calculation
FLOOR 1 (Living area)	4653	Coordinate Polygon Area Algorithm using inches $-((1111.9 + 1111.9) * (73.8 - 334) + (1111.9 + 1169.7) * (334 - 334) + (1169.7 + 1169.7) * (334 - 715.7) + (1169.7 + 1128.4) * (715.7 - 715.7) + (1128.4 + 1128.4) * (715.7 - 927.4) + (1128.4 + 1047.7) * (927.4 - 927.4) + (1047.7 + 1047.7) * (927.4 - 979.1) + (1047.7 + 851) * (979.1 - 979.1) + (851 + 851) * (979.1 - 827.9) + (851 + 705.2) * (827.9 - 827.9) + (705.2 + 705.2) * (827.9 - 979.1) + (705.2 + 507.7) * (979.1 - 979.1) + (507.7 + 507.7) * (979.1 - 927.4) + (507.7 + 422.5) * (927.4 - 927.4) + (422.5 + 422.5) * (927.4 - 921.4) + (422.5 + 416.5) * (921.4 - 921.4) + (416.5 + 416.5) * (921.4 - 680.6) + (416.5 + 149.9) * (680.6 - 680.6) + (149.9 + 149.9) * (680.6 - 488.5) + (149.9 + -0.1) * (488.5 - 488.5) + (-0.1 + -0.1) * (488.5 - 299.1) + (-0.1 + 216) * (299.1 - 299.1) + (216 + 216) * (299.1 - 132.8) + (216 + 422.5) * (132.8 - 132.8) + (422.5 + 422.5) * (132.8 - 239.1))$

7522 Saddle Blanket Drive, Waller, Texas 77484, United States

Gross Living Area: 4653 sq. ft

Space	Area (sq. ft)	Calculation <small>Coordinate Polygon Area Algorithm using inches</small>
COVERED PATIO (Non-living area)	850	$\begin{aligned} &+ (422.5 + 601.2) * (239.1 - 239.1) + (601.2 + 601.2) * (239.1 - 363.2) + (601.2 + 906.8) * (363.2 - 363.2) + (906.8 + 906.8) * (363.2 - 73.8) + (906.8 + 1111.9) * (73.8 - 73.8) * 0.5 * 0.00694 \\ &- ((637.5 + 637.5) * (17.6 - 102.3) + (637.5 + 906.8) * (102.3 - 102.3) + (906.8 + 906.8) * (102.3 - 363.2) + (906.8 + 601.2) * (363.2 - 363.2) + (601.2 + 601.2) * (363.2 - 239.1) + (601.2 + 422.5) * (239.1 - 239.1) + (422.5 + 422.5) * (239.1 - 17.6) + (422.5 + 637.5) * (17.6 - 17.6)) * 0.5 * 0.00694 \end{aligned}$
GARAGE (Non-living area)	555	$\begin{aligned} &- ((416.5 + 416.5) * (680.6 - 736.4) + (416.5 + 416) * (736.4 - 736.4) + (416 + 416) * (736.4 - 740.4) + (416 + 416.5) * (740.4 - 740.4) + (416.5 + 416.5) * (740.4 - 782.9) + (416.5 + 416) * (782.9 - 782.9) + (416 + 416) * (782.9 - 786.9) + (416 + 416.5) * (786.9 - 786.9) + (416.5 + 416.5) * (786.9 - 921.4) + (416.5 + 422.5) * (921.4 - 921.4) + (422.5 + 422.5) * (921.4 - 979.1) + (422.5 + 149.9) * (979.1 - 979.1) + (149.9 + 149.9) * (979.1 - 680.6) + (149.9 + 416.5) * (680.6 - 680.6)) * 0.5 * 0.00694 \end{aligned}$