

LEGEND

B.C.C.O.	BRAZORIA COUNTY CLERK'S OFFICE
B.C.D.R.	BRAZORIA COUNTY DEED RECORDS
(C.M.)	CONTROL MONUMENT
FND	FOUND
R.O.W.	RIGHT-OF-WAY
I.P.	IRON PIPE
I.R.	IRON ROD
(IOB)	COMMITMENT REFERENCE
—○—○—	WROUGHT IRON FENCE
—//—//—	PLASTIC FENCE
—x—x—	HOGWIRE FENCE

LEGAL DESCRIPTION:
 LOT 2, BLOCK 1 OF THE MINOR PLAT OF LINDSAY ESTATE SUBDIVISION IN BRAZORIA COUNTY, TEXAS ACCORDING TO THE MAP OR PLAT THEREOF RECORDED IN CLERK'S FILE NO. 2024001235, IN THE CLERK'S OFFICE OF BRAZORIA COUNTY, TEXAS

- NOTE:**
1. THIS DRAWING IS BASED ON THE TEXAS COORDINATE SYSTEM OF 1983, SOUTH CENTRAL ZONE. THE DRAWING IS IN SURFACE. SCALE FACTOR: 0.99987.
 2. ALL EASEMENTS SHOWN HEREON ARE BASED ON THE RECORDED MINOR PLAT OF LINDSAY ESTATE SUBDIVISION AS RECORDED IN CLERK'S FILE NO. 2024001235 IN THE BRAZORIA COUNTY CLERK'S OFFICE UNLESS OTHERWISE NOTED.
 3. THIS SURVEY HAS BEEN PREPARED UTILIZING A COMMITMENT FOR TITLE INSURANCE PREPARED BY STEWART TITLE GUARANTY COMPANY, FILE NO. 2163609, HAVING AN EFFECTIVE DATE OF JANUARY 10, 2024.
 4. FENCE DIMENSIONS SHOWN HEREON ARE SHOWN ON THE SIDE OF THE PROPERTY LINE THE FENCES ARE ON.

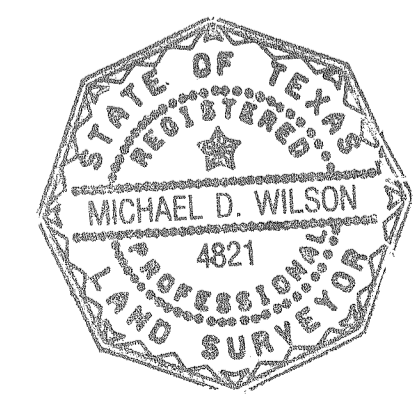

THIS SURVEY SUBSTANTIALLY COMPLIES WITH THE CURRENT TEXAS SOCIETY OF PROFESSIONAL SURVEYORS STANDARDS AND SPECIFICATIONS FOR A CATEGORY 1A, CONDITION II SURVEYS.
 Michael D. Wilson
 MICHAEL D. WILSON R.P.L.S.
 TEXAS REGISTRATION NO. 4821
 02/12/24

02/12/24	REVISED FENCE DIMENSION	
01/22/24	DATE SURVEYED	
CAD FILE 23-129 (LOT 2).dwg	ORIGINAL PLOT DATE: 01/22/24	
DWN	C.L.H.	
CKD	M.D.W.	
SCALE 1"=50'		
JOB NO. 23-129		
SHEET 1 OF 1		
APRIL CERVANTEZ AND JOE CERVANTEZ BOUNDARY SURVEY OF LOT 2, BLOCK 1 OF LINDSAY ESTATE SUBDIVISION IN THE CITY OF PEARLAND, BRAZORIA COUNTY, TEXAS		

COPYRIGHT 2024, THE WILSON SURVEY GROUP, INC.