

NOTES

1. This survey was done in conjunction with title commitment G.F. No. 202356296, dated April 12, 2023, provided by First American Title Guaranty Company. This Surveyor did not research the deed records for previous conflicts in title or easement, therefore, certain easements may have been granted which are not reflected hereon.
2. Right-of-Way easement granted to Soda Water Supply Corporation from Jesse Tolly et ux Ethel Tolly as set out in instrument dated January 6, 1969, recorded in Volume 249, Page 231 et seq., Deed Records, Polk County, Texas.
3. Terms, conditions and stipulations pertaining to a perpetual easement and right of way conveyed in deed dated May 4, 1977 from Joann Joice to Ray A. Clamon and wife, Sara Clamon, recorded in Volume 329, Page 428 et seq., Deed Records, Polk County, Texas.
4. According to horizontal scaling from the current F.E.M.A. flood insurance rate Map no. 48373C0500C, dated September 03, 2010, this tract DOES NOT lie within Zone "A" or Zone "AE".

LEGEND

- UE UTILITY EASEMENT
- BL BUILDING SETBACK LINE
- OHE— OVERHEAD ELECTRIC WIRE
- X — WIRE FENCE
- ⊙ SEPTIC

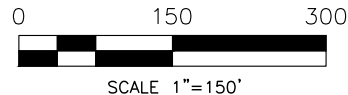

KATHY LOWE
LOT 153-1
 VOL. 1837, PAGE 548
 (O.P.R.P.C.T.)

ALLAN EARL EGGLESTON
 VOL. 2078, PAGE 741
 (O.P.R.P.C.T.)
JOANN RICE EGGLESTON
 VOL. 2078, PAGE 734
 (O.P.R.P.C.T.)
 CALLED 10.3 AC. TRACT THREE

CHANTELL BATTISE
15.063 AC. TRACT
 VOL. 1954, PAGE 427
 (O.P.R.P.C.T.)

16.23 ACRES
JEANNE C HASWELL et al
 CALLED 16.1853 AC. TRACT
 VOL. 2463, PAGE 200
 (O.P.R.P.C.T.)

SOUTHLAND PLANTATION
 SECTION 6

SOUTHLAND PLANTATION
 SECTION 6

GEORGE ROSS et ux
LOT 151-1, 152, 153, 153-A
 VOL. 930, PAGE 471
 (O.P.R.P.C.T.)

CRAIG WILLIAMS
LOT 154
 VOL. 1625, PAGE 716
 (O.P.R.P.C.T.)

JEANNE C HASWELL et al

CHARLES ROBERT HOLCOMBE, JR. et ux
 CALLED 6.7446 AC. TRACT
 VOL. 2177, PAGE 455
 (O.P.R.P.C.T.)

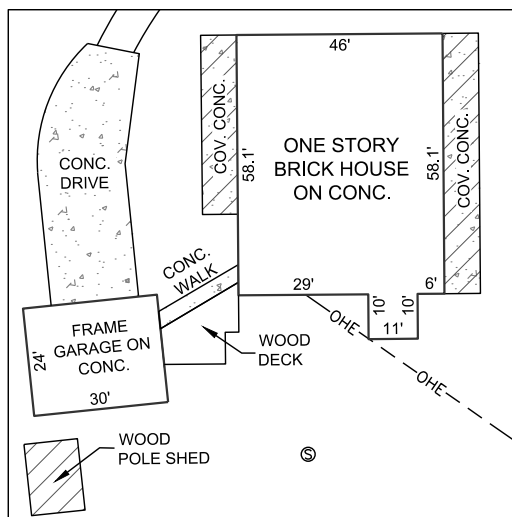

DETAIL N.T.S.

SURVEY OF: A 16.23 ACRE TRACT, SITUATED IN THE J. M. RENFRO SURVEY, A-511, POLK COUNTY, TEXAS, AND BEING THAT SAME CALLED 16.1853 ACRE TRACT RECORDED IN VOLUME 2463, PAGE 200 OF THE OFFICIAL PUBLIC RECORDS OF POLK COUNTY, TEXAS.

JOB NUMBER:	23169_R0
SURVEY MADE FOR:	Jeanne Haswell
DATE:	05/22/2023
FIELD CREW:	KB
OFFICE:	JL, AW, AT

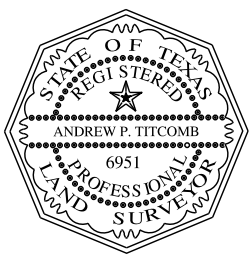

I, Andrew P. Titcomb, certify that this survey was performed under my supervision on May 19, 2023; that there were no encroachments except as shown; that this survey conforms to T.S.P.S. Standards for a Category 1a, Condition III Survey. This certifies only to easements and building lines as referenced in Title Commitment as noted in Note #1 hereon.

Andrew P. Titcomb
 ANDREW P. TITCOMB, R.P.L.S. #6951

734 HAWKINS
 LIVINGSTON, TEXAS 77351

TC SURVEY & MAPPING
 9711 MASON RD. STE. 125 #416
 RICHMOND, TEXAS 77407
 PHONE (832) 600-2510
 atitcomb@tcsurveyandmapping.com
 TBPELS Firm 10194775