

BUYER Carol & Lohr Edwards 1212 Candlewood Drive

DESCRIBED PROPERTY Lot 9, in Block 13, of COUNTRYSIDE, SECTION 4, a subdivision in Galveston County, Texas, according to the map or plat thereof, recorded in Volume 17, Page 51 of the Map Records of Galveston County, Texas.

TEXAS LAND COORDINATORS, INC.
 P.O. Box 1697 • Pearland, TX 77588
 (281) 997-1585
 G.F. 9942300072
 Date: 12-7-99
 Inv.#: 28377
 JOB # 12-113-99

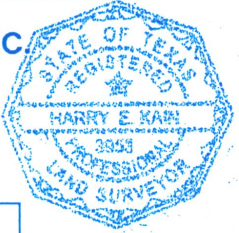

I do hereby certify that this survey was this day made on the ground of the property legally described hereon, (or on the attached sheet), and is correct, and there are no encroachments unless shown, and was done by me or under my supervision, and conforms to or exceeds the current standards as adopted by the Texas Board of Professional Land Surveying.

Note: There are no natural drainage courses on this property.
 Note: This property does not lie in a flood hazard zone according to H.U.D./F.I.A. 485486 0025C 5-2-83 Zone C

Harry E. Kan
 12/08/1999

**T-47 RESIDENTIAL REAL PROPERTY AFFIDAVIT
(MAY BE MODIFIED AS APPROPRIATE FOR COMMERCIAL TRANSACTIONS)**

Date: 4-4-24 GF No. _____

Name of Affiant(s): Peter J. Walkowiak, Sara Walkowiak

Address of Affiant: 1212 Candlewood Dr., League City, TX 77573-6107

Description of Property: _____
County Galveson, Texas

"Title Company" as used herein is the Title Insurance Company whose policy of title insurance is issued in reliance upon the statements contained herein.

Before me, the undersigned notary for the State of Texas, personally appeared Affiant(s) who after by me being sworn, stated:

1. We are the owners of the Property. (Or state other basis for knowledge by Affiant(s) of the Property, such as lease, management, neighbor, etc. For example, "Affiant is the manager of the Property for the record title owners."):

2. We are familiar with the property and the improvements located on the Property.

3. We are closing a transaction requiring title insurance and the proposed insured owner or lender has requested area and boundary coverage in the title insurance policy(ies) to be issued in this transaction. We understand that the Title Company may make exceptions to the coverage of the title insurance as Title Company may deem appropriate. We understand that the owner of the property, if the current transaction is a sale, may request a similar amendment to the area and boundary coverage in the Owner's Policy of Title Insurance upon payment of the promulgated premium.

4. To the best of our actual knowledge and belief, since _____ there have been no:
a. construction projects such as new structures, additional buildings, rooms, garages, swimming pools or other permanent improvements or fixtures;
b. changes in the location of boundary fences or boundary walls;
c. construction projects on immediately adjoining property(ies) which encroach on the Property;
d. conveyances, replattings, easement grants and/or easement dedications (such as a utility line) by any party affecting the Property.

EXCEPT for the following (If None, Insert "None" Below:) Added a Storage Shed.

5. We understand that Title Company is relying on the truthfulness of the statements made in this affidavit to provide the area and boundary coverage and upon the evidence of the existing real property survey of the Property. This Affidavit is not made for the benefit of any other parties and this Affidavit does not constitute a warranty or guarantee of the location of improvements.

6. We understand that we have no liability to Title Company that will issue the policy(ies) should the information in this Affidavit be incorrect other than information that we personally know to be incorrect and which we do not disclose to the Title Company.

Peter J. Walkowiak
Sara Walkowiak
Sara Walkowiak



SWORN AND SUBSCRIBED this 4th day of April, 24

Kaitlin Williams
Notary Public
Kaitlin Williams

(TXR-1907) 02-01-2010