

# Harris Central Appraisal District

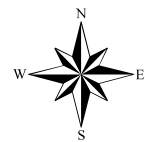

Geospatial or map data maintained by the Harris Central Appraisal District is for informational purposes and may **not** have been prepared for or be suitable for legal, engineering, or surveying purposes. It does **not** represent an on-the-ground survey and only represents the approximate location of property boundaries.

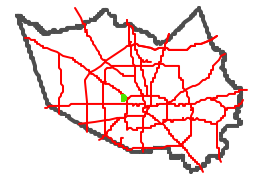

0 80 160 320 Feet

Date: 3/22/2024

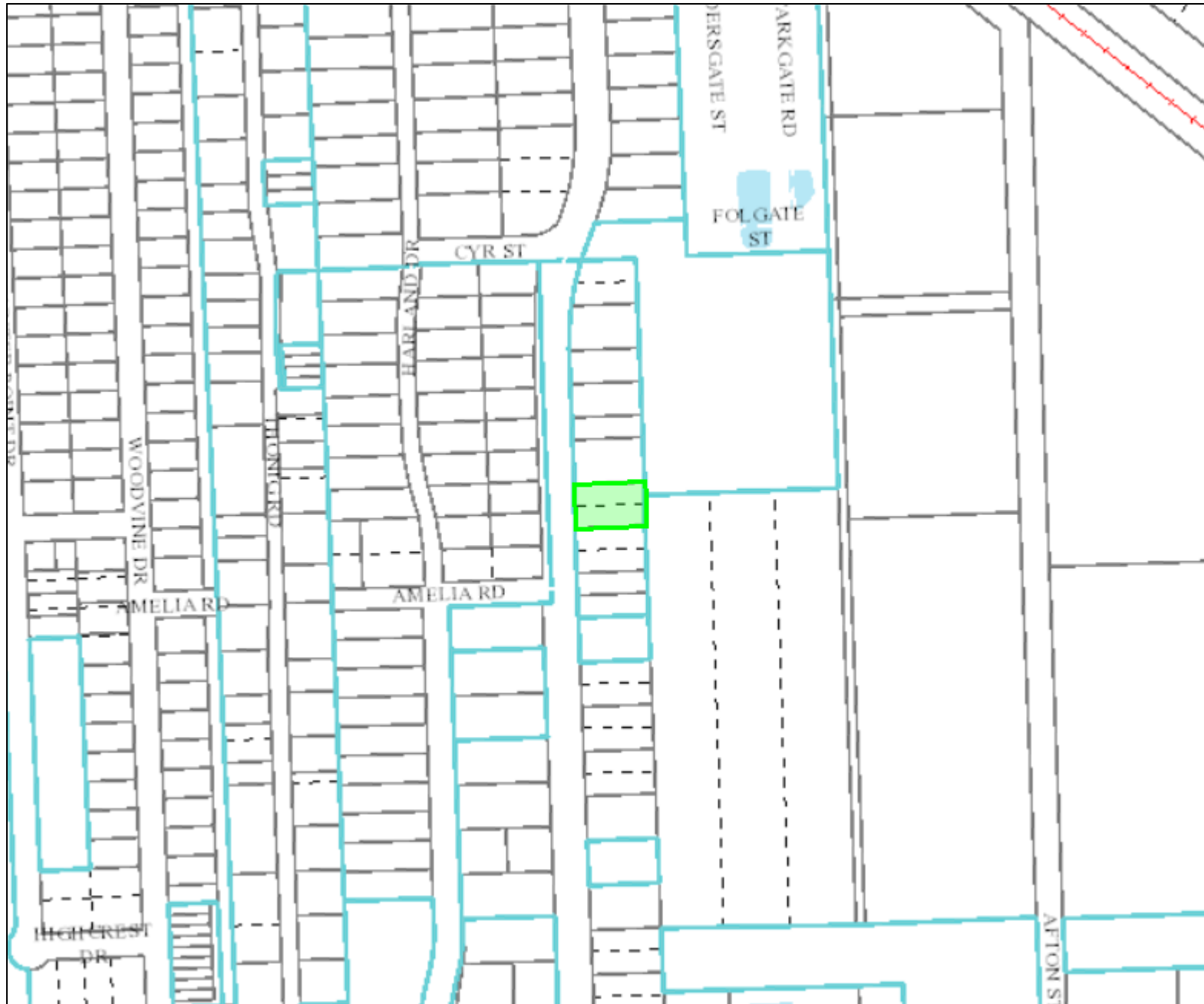

1930 Antoine