



Engineering

CITY OF CONROE

Est. 1904

June 6, 2022

Dear Property Owner:

According to the information the City of Conroe has, you own a structure in FEMA effective 100-year floodplain. Because of this, we strongly encourage you to purchase FEMA backed flood insurance for your property. This provides financial resources for making repairs in case of flooding. In addition, a history of flooding with FEMA backed insurance can help make your structure eligible for FEMA grants in the future in case your structure ever needs measures taken to mitigate for flooding problems.

Because your structure is in floodplain, it is subject to substantial damage rules in the City ordinances. Since your structure is in the 100-year floodplain, any repairs or improvements require that a Floodplain Permit Application be approved by the City prior to starting work. With hurricane season coming up, be aware this includes repair after storm damage. A Floodplain Permit is always going to be required, even for work which does not require electrical, mechanical or any other City permits.

If you are receiving this letter, the City is not aware of an elevation certificate (EC) showing your structure being higher than the BFE. If you happen to have one for your structure, it would be helpful for the City to have a copy in our files. If you cannot find one in your files, your flood insurance agent may have a copy provided to obtain flood insurance. If you would e-mail the document or deliver a copy to the City of Conroe Engineering Department at 700 Metcalf St., Conroe, Texas, this will give you a head start on future work or repairs by allowing the City to verify whether your structure might be exempt from substantial damage rules and not require a floodplain permit. Providing the EC to the City will not hurt you, and it could help you if the structure is higher than the BFE. Please e-mail to engineering@cityofconroe.org, Attention: Ann Colina.

If you do not possess an elevation certificate for your structure but believe the structure is higher than the BFE despite FEMA maps that indicate otherwise, please consider obtaining an elevation certificate. FEMA maps are not always correct, but it is the burden of the property owner to prove so with an EC. If your structure did not flood during Harvey in 2017 and did not flood during Imelda in 2019, it is possible that your structure is higher than the BFE. An elevation certificate must be prepared by a registered professional surveyor and the typical cost lately has been about \$750 for a residence, but the cost is often offset by savings in flood insurance rates if your structure is above the BFE. If you decide to hire a surveyor to do an EC, please provide a copy to the City to determine if your structure is higher than the BFE. If it is, the City will no longer require an approved floodplain permit before work or repairs are performed on your structure.

ELEVATION CERTIFICATE

Important: Follow the instructions on pages 1-9.

Copy all pages of this Elevation Certificate and all attachments for (1) community official, (2) insurance agent/company, and (3) building owner.

SECTION A - PROPERTY INFORMATION				FOR INSURANCE COMPANY USE	
A1. Building Owner's Name Applewood LTD				Policy Number:	
A2. Building Street Address (including Apt., Unit, Suite, and/or Bldg. No.) or P.O. Route and Box No. 2001 Willowbend Street				Company NAIC Number:	
City Conroe	State Texas	ZIP Code 77301			
A3. Property Description (Lot and Block Numbers, Tax Parcel Number, Legal Description, etc.) Lot 9, Block 11, Holly Hills Section 3 Tax ID:R100884					
A4. Building Use (e.g., Residential, Non-Residential, Addition, Accessory, etc.) <u>Residential</u>					
A5. Latitude/Longitude: Lat. <u>N30° 19' 51.51"</u> Long. <u>W95° 28' 11.78"</u> Horizontal Datum: <input type="checkbox"/> NAD 1927 <input checked="" type="checkbox"/> NAD 1983					
A6. Attach at least 2 photographs of the building if the Certificate is being used to obtain flood insurance.					
A7. Building Diagram Number <u>5</u>					
A8. For a building with a crawlspace or enclosure(s):					
a) Square footage of crawlspace or enclosure(s) <u>N/A</u> sq ft					
b) Number of permanent flood openings in the crawlspace or enclosure(s) within 1.0 foot above adjacent grade <u>N/A</u>					
c) Total net area of flood openings in A8.b <u>N/A</u> sq in					
d) Engineered flood openings? <input type="checkbox"/> Yes <input checked="" type="checkbox"/> No					
A9. For a building with an attached garage:					
a) Square footage of attached garage <u>N/A</u> sq ft					
b) Number of permanent flood openings in the attached garage within 1.0 foot above adjacent grade <u>N/A</u>					
c) Total net area of flood openings in A9.b <u>N/A</u> sq in					
d) Engineered flood openings? <input type="checkbox"/> Yes <input checked="" type="checkbox"/> No					
SECTION B - FLOOD INSURANCE RATE MAP (FIRM) INFORMATION					
B1. NFIP Community Name & Community Number City of Conroe 480484			B2. County Name Montgomery		B3. State Texas
B4. Map/Panel Number 48339C0380G	B5. Suffix G	B6. FIRM Index Date 08-18-2014	B7. FIRM Panel Effective/ Revised Date 08-18-2014	B8. Flood Zone(s) AE, Shd. X	B9. Base Flood Elevation(s) (Zone AO, use Base Flood Depth) 211.8
B10. Indicate the source of the Base Flood Elevation (BFE) data or base flood depth entered in Item B9: <input checked="" type="checkbox"/> FIS Profile <input type="checkbox"/> FIRM <input type="checkbox"/> Community Determined <input type="checkbox"/> Other/Source: _____					
B11. Indicate elevation datum used for BFE in Item B9: <input type="checkbox"/> NGVD 1929 <input checked="" type="checkbox"/> NAVD 1988 <input type="checkbox"/> Other/Source: _____					
B12. Is the building located in a Coastal Barrier Resources System (CBRS) area or Otherwise Protected Area (OPA)? <input type="checkbox"/> Yes <input checked="" type="checkbox"/> No Designation Date: _____ <input type="checkbox"/> CBRS <input type="checkbox"/> OPA					

ELEVATION CERTIFICATE

OMB No. 1660-0008
Expiration Date: November 30, 2022

IMPORTANT: In these spaces, copy the corresponding information from Section A.			FOR INSURANCE COMPANY USE
Building Street Address (including Apt., Unit, Suite, and/or Bldg. No.) or P.O. Route and Box No. 2001 Willowbend Street			Policy Number:
City Conroe	State Texas	ZIP Code 77301	Company NAIC Number

SECTION C – BUILDING ELEVATION INFORMATION (SURVEY REQUIRED)

C1. Building elevations are based on: Construction Drawings* Building Under Construction* Finished Construction

*A new Elevation Certificate will be required when construction of the building is complete.

C2. Elevations – Zones A1–A30, AE, AH, A (with BFE), VE, V1–V30, V (with BFE), AR, AR/A, AR/AE, AR/A1–A30, AR/AH, AR/AO. Complete Items C2.a–h below according to the building diagram specified in Item A7. In Puerto Rico only, enter meters.

Benchmark Utilized: Leica RTK SmartNet Vertical Datum: GEOID12B (CONUS) 2011 Adj.

Indicate elevation datum used for the elevations in items a) through h) below.

NGVD 1929 NAVD 1988 Other/Source: _____

Datum used for building elevations must be the same as that used for the BFE.

Check the measurement used.

- | | | | |
|-------------------------------------------------------------------------------------------------------------------------------|-------|------------------------------------------|---------------------------------|
| a) Top of bottom floor (including basement, crawlspace, or enclosure floor) | 211.8 | <input checked="" type="checkbox"/> feet | <input type="checkbox"/> meters |
| b) Top of the next higher floor | N/A | <input type="checkbox"/> feet | <input type="checkbox"/> meters |
| c) Bottom of the lowest horizontal structural member (V Zones only) | N/A | <input type="checkbox"/> feet | <input type="checkbox"/> meters |
| d) Attached garage (top of slab) | N/A | <input type="checkbox"/> feet | <input type="checkbox"/> meters |
| e) Lowest elevation of machinery or equipment servicing the building
(Describe type of equipment and location in Comments) | 211.8 | <input checked="" type="checkbox"/> feet | <input type="checkbox"/> meters |
| f) Lowest adjacent (finished) grade next to building (LAG) | 210.9 | <input checked="" type="checkbox"/> feet | <input type="checkbox"/> meters |
| g) Highest adjacent (finished) grade next to building (HAG) | 211.5 | <input checked="" type="checkbox"/> feet | <input type="checkbox"/> meters |
| h) Lowest adjacent grade at lowest elevation of deck or stairs, including structural support | 211.4 | <input checked="" type="checkbox"/> feet | <input type="checkbox"/> meters |

SECTION D – SURVEYOR, ENGINEER, OR ARCHITECT CERTIFICATION

This certification is to be signed and sealed by a land surveyor, engineer, or architect authorized by law to certify elevation information. I certify that the information on this Certificate represents my best efforts to interpret the data available. I understand that any false statement may be punishable by fine or imprisonment under 18 U.S. Code, Section 1001.

Were latitude and longitude in Section A provided by a licensed land surveyor? Yes No Check here if attachments.

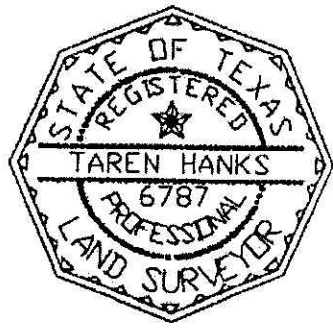
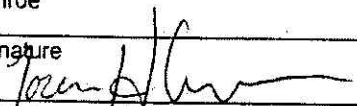
Certifier's Name Taren Hanks	License Number 6787		
Title Registered Professional Land Surveyor			
Company Name Jeffrey Moon and Associates, Inc			
Address P. O. Box 2501			
City Conroe	State Texas		ZIP Code 77305
Signature 	Date 12-01-2021	Telephone (936) 756-5266	Ext.

Copy all pages of this Elevation Certificate and all attachments for (1) community official, (2) insurance agent/company, and (3) building owner.

Comments (including type of equipment and location, per C2(e), if applicable)

Item C2a the elevation of the finish floor.
Item C2e is an A/C unit.

ELEVATION CERTIFICATE

OMB No. 1660-0008
Expiration Date: November 30, 2022

IMPORTANT: In these spaces, copy the corresponding information from Section A.			FOR INSURANCE COMPANY USE
Building Street Address (including Apt., Unit, Suite, and/or Bldg. No.) or P.O. Route and Box No. 2001 Willowbend Street			Policy Number:
City Conroe	State Texas	ZIP Code 77301	Company NAIC Number

**SECTION E – BUILDING ELEVATION INFORMATION (SURVEY NOT REQUIRED)
FOR ZONE AO AND ZONE A (WITHOUT BFE)**

For Zones AO and A (without BFE), complete Items E1–E5. If the Certificate is intended to support a LOMA or LOMR-F request, complete Sections A, B, and C. For Items E1–E4, use natural grade, if available. Check the measurement used. In Puerto Rico only, enter meters.

- E1. Provide elevation information for the following and check the appropriate boxes to show whether the elevation is above or below the highest adjacent grade (HAG) and the lowest adjacent grade (LAG).
- a) Top of bottom floor (including basement, crawlspace, or enclosure) is _____ feet meters above or below the HAG.
- b) Top of bottom floor (including basement, crawlspace, or enclosure) is _____ feet meters above or below the LAG.
- E2. For Building Diagrams 6–9 with permanent flood openings provided in Section A Items 8 and/or 9 (see pages 1–2 of Instructions), the next higher floor (elevation C2.b in the diagrams) of the building is _____ feet meters above or below the HAG.
- E3. Attached garage (top of slab) is _____ feet meters above or below the HAG.
- E4. Top of platform of machinery and/or equipment servicing the building is _____ feet meters above or below the HAG.
- E5. Zone AO only: If no flood depth number is available, is the top of the bottom floor elevated in accordance with the community's floodplain management ordinance? Yes No Unknown. The local official must certify this information in Section G.

SECTION F – PROPERTY OWNER (OR OWNER'S REPRESENTATIVE) CERTIFICATION

The property owner or owner's authorized representative who completes Sections A, B, and E for Zone A (without a FEMA-issued or community-issued BFE) or Zone AO must sign here. The statements in Sections A, B, and E are correct to the best of my knowledge.

Property Owner or Owner's Authorized Representative's Name

Address _____ City _____ State _____ ZIP Code _____

Signature _____ Date _____ Telephone _____

Comments

Check here if attachments.

BUILDING PHOTOGRAPHS

See Instructions for Item A6.

OMB No. 1660-0008

Expiration Date: November 30, 2022

ELEVATION CERTIFICATE

IMPORTANT: In these spaces, copy the corresponding information from Section A.			FOR INSURANCE COMPANY USE
Building Street Address (including Apt., Unit, Suite, and/or Bldg. No.) or P.O. Route and Box No. 2001 Willowbend Street			Policy Number:
City Conroe	State Texas	ZIP Code 77301	Company NAIC Number

If using the Elevation Certificate to obtain NFIP flood insurance, affix at least 2 building photographs below according to the instructions for Item A6. Identify all photographs with date taken; "Front View" and "Rear View"; and, if required, "Right Side View" and "Left Side View." When applicable, photographs must show the foundation with representative examples of the flood openings or vents, as indicated in Section A8. If submitting more photographs than will fit on this page, use the Continuation Page.



Photo One

Photo One Caption East / Front View

Clear Photo One



Photo Two

Photo Two Caption South / Left View

Clear Photo Two

ELEVATION CERTIFICATE

BUILDING PHOTOGRAPHS

Continuation Page

OMB No. 1660-0008
Expiration Date: November 30, 2022

IMPORTANT: In these spaces, copy the corresponding information from Section A.			FOR INSURANCE COMPANY USE
Building Street Address (including Apt., Unit, Suite, and/or Bldg. No.) or P.O. Route and Box No. 2001 Willowbend Street			Policy Number:
City Conroe	State Texas	ZIP Code 77301	Company NAIC Number

If submitting more photographs than will fit on the preceding page, affix the additional photographs below. Identify all photographs with: date taken; "Front View" and "Rear View"; and, if required, "Right Side View" and "Left Side View." When applicable, photographs must show the foundation with representative examples of the flood openings or vents, as indicated in Section AB.

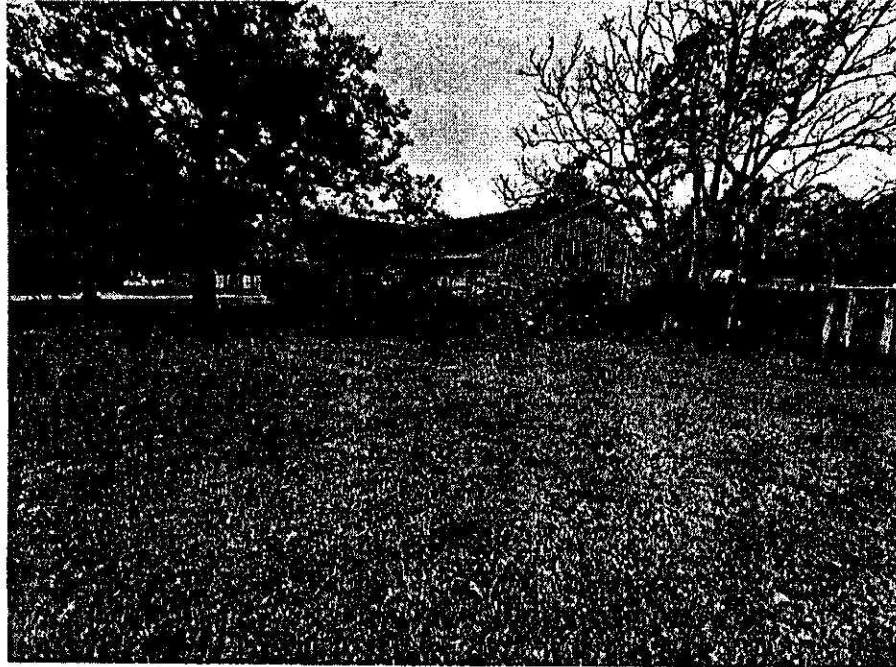

Photo Three

Photo Three Caption North Side / Right View

Clear Photo Three

Photo Four

Photo Four

Photo Four Caption

Clear Photo Four