

4203 Carnes Court

David Schremp and Stephanie Graves

Being all of Lot 12 (TWELVE), Block 2 (TWO), CREEK MEADOWS PHASE TWO B SECTION FOUR, an addition to the City of College Station, Brazos County, Texas, according to the plat recorded in Volume 9903 Page 166 of the Official Records of Brazos County, Texas.

I, Paul Williams, Registered Professional Land Surveyor No. 5743 do hereby certify that this plat represents the results of a survey performed on the ground, under my supervision on July 22, 2013, and is true and correct to the best of my knowledge.

I further certify that no improvements on this property encroach on adjacent property, nor do any improvements on adjacent property encroach on to this property, except as shown.

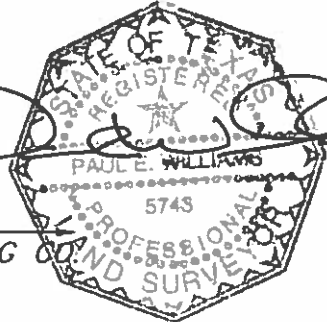
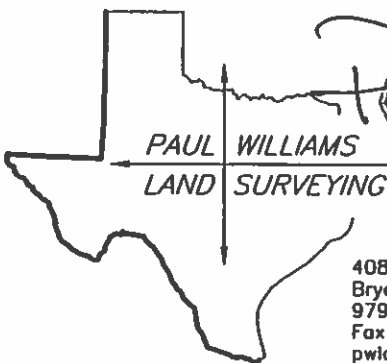

PAUL WILLIAMS
LAND SURVEYING CO.
408 North Coulter Drive
Bryan, TX 77803
979-779-7670
Fax 979-779-7672
pwlandsurveying@earthlink.net

Notes:
North orientation is based on rotating to plat calls in 9903/166.
This survey was prepared with the benefit of Brazos County Abstract Company Commitment No. G.F. BC1300545 and is valid for this transaction only.
The Following Easements appear to effect the parent tract of this property, however no above ground evidence was located on this survey:
1) From B. F. Vance to Lone Star Gas Company in 148/491.
2) From VRV Partners to Wellborn Special Utility District in 3645/276; and in 3645/286.
k:/pwlsco/clients/2013/13030.dwg