



GRAPHIC SCALE
1"=200'

MONTGOMERY COUNTY, TEXAS
ZACHARIAH LANDRUM SURVEY, ABSTRACT NUMBER 22

WOMACK CEMETERY ROAD

CALLED 32,821 ACRES
C.F.N. 8229724
O.P.R.M.C.T.

FOUND 5/8" IRON ROD WITH CAP

SYMBOL LEGEND	
●	PROPERTY CORNER
○	GUY WIRE
⊕	TELEPHONE FEED
⊖	WATER WELL
⦿	POWER POLE

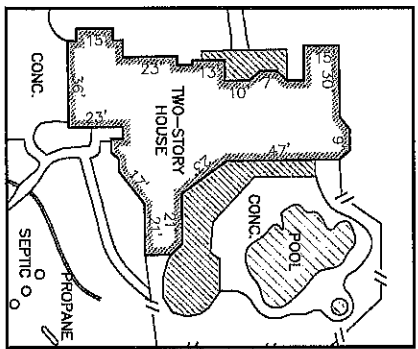
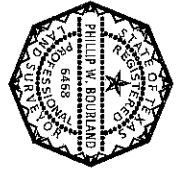

CALLED 14,719 ACRES
VOL. 584 PG. 1220
O.P.R.M.C.T.

NOTES:

1. THE SURVEYOR HAS RELIED UPON THE COMMITMENT FOR TITLE INSURANCE ISSUED BY CHICAGO TITLE INSURANCE COMPANY, FILE NO. CTR-F03-172729, EFFECTIVE DATE 05/21/2007, IN CONNECTION WITH THIS SURVEY. THE SURVEYOR HAS CONDUCTED VISUAL INSPECTION OF THE SUBJECT PROPERTY AND HAS BEEN ADVISED THAT THE COMMITMENT IS CORRECT AND THAT NO ADDITIONAL RESEARCH REGARDING THE EXISTENCE OF EASEMENTS, RESTRICTIONS, OR OTHER MATTERS OF RECORD HAS BEEN PERFORMED BY THE SURVEYOR.
2. THIS SURVEY DOES NOT PROVIDE A DETERMINATION OR OPINION CONCERNING THE LOCATION OR EXISTENCE OF WELLS, FAULT LINES, TOXIC OR HAZARDOUS WASTE AREAS, SUBSIDENCE, OVERHEAD, SUBSURFACE AND ENVIRONMENTAL CONDITIONS OR GEOLOGICAL ISSUES. NO STATEMENT IS MADE CONCERNING THE SUITABILITY OF THE SUBJECT TRACT FOR ANY INTENDED USE, PURPOSE OR DEVELOPMENT.
3. DATE OF SURVEY 04/19/2021
4. BASIS OF BEARING IS BASED ON THE INSTRUMENT RECORDED UNDER CLERK'S FILE NUMBER 200611859 OFFICIAL RECORDS OF MONTGOMERY COUNTY, TEXAS

The Commitment, Schedule B items:

10g. An easement granted to Mid-South Electric Cooperative, Inc., as set forth in instrument recorded under County Clerk's File No. 9605082. (Does affect. Unable to Plot)
 10h. Electric line easement and right of way granted to Mid-South Electric Cooperative Association, dba Mid-South Energy as set forth in instrument dated September 7, 2007 filed for record under Montgomery County Clerk's File No. 2007-115586. (Does affect. Unable to Plot)

TO: CHICAGO TITLE INSURANCE COMPANY, AND JOHN MCGILL AND HELENA MCGILL

THIS SURVEY SUBSTANTIALLY COMPLIES WITH THE CURRENT TEXAS SOCIETY OF PROFESSIONAL SURVEYORS STANDARDS AND SPECIFICATIONS FOR A CATEGORY 1A, CONDITION III SURVEY.

PHILLIP W. BOURLAND
REGISTERED PROFESSIONAL LAND SURVEYOR
NO. 6488 - STATE OF TEXAS
DATE 04/23/21

BOURLAND
LAND SURVEYING, LLC
2400 FM 3081
MILLS, TEXAS 77378
(281) 732-3013
TSPS SRM REG # 10194235

CALLED 251.86 ACRES
C.F.N. 9403259
O.P.R.M.C.T.

LINE USED FOR DIRECTIONAL CONTROL

N01°14'30"W 1354.47'

POINT OF BEGINNING
P.N.D. 5/8"
IRON ROD
CONTROLLING
MONUMENT

FOUND 3/4" IRON PIPE

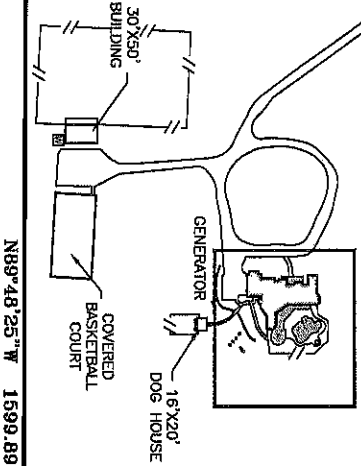

49.895 ACRES
(2,173,438 SQUARE FEET)
C.F.N. 200611859
O.P.R.M.C.T.

N89°48'25"W 1599.89'

CALLED 50,847 ACRES
C.F.N. 2020124901
O.P.R.M.C.T.

FOUND 5/8" IRON ROD WITH CAP

PROPERTY ADDRESS:
11909 Womack Cemetery Rd.
Montgomery, TX 77316