

**SKETCH ADDENDUM**

Borrower or Owner **Mark & Julie Colasacco**  
 Property Address **87 Olmstead Row**  
 City **Spring** County **Montgomery** State **Tx** Zip Code **77380**  
 Client **Pam Franks**

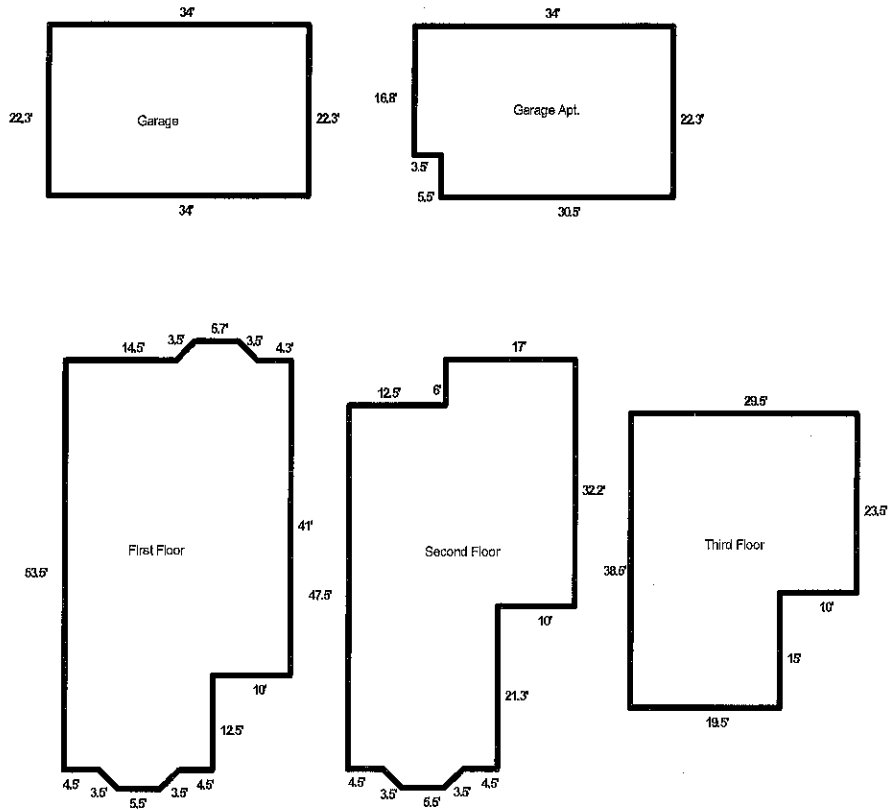

SUMMARY	SQ. FT. AREA	PERIMETER	AREA CALCULATION DETAILS	
Living Area			First Floor	
First Floor	1494	170	8.2 X 2.5 =	20.5
Second Floor	1310	168	29.5 X 41.0 =	1208.5
Third Floor	986	136	19.5 X 12.5 =	243.7
Total	3790	474	8.0 X 2.5 =	20.0
			Total	1493.7
Other			Second Floor	
Garage Apt.	739	113	17.0 X 6.0 =	102.0
Garage/Carport			29.5 X 26.2 =	772.9
Detached Garage	758	113	19.5 X 21.3 =	415.3
			8.0 X 2.5 =	20.0
			Total	1310.2
			Third Floor	
			29.5 X 23.5 =	693.2
			19.5 X 15.0 =	292.5
			Total	985.7