

CURVE TABLE

CURVE	BEARING	DISTANCE	RADIUS	LENGTH
C1	N 07° 35' 04" E	157.29'	250.00'	160.00'
C2	N 41° 49' 03" E	136.97'	250.00'	138.74'

LINE TABLE

LINE	BEARING	DISTANCE
L1	N 57° 43' 00" E	50.00'
L2	S 57° 43' 00" W	56.46'
L3	S 10° 45' 00" E	39.72'



RUSTIC LANE
(60' R.O.W.)

N 10° 45' 00" W
70.00'

FND. 1/2" I.R.

FND. 1/2" I.R.

15' UTILITY & DRAINAGE EASEMENT

5' X 20' AERIAL EASEMENT

50' BUILDING LINE

C1

FND. 1/2" I.R.

79.2'

29.9'

66.2'

S 79° 15' 00" W
255.00'

LOT 32
BLOCK 3

LOT 31
BLOCK 3

5' X 20' AERIAL EASEMENT

10' UTILITY EASEMENT

5' X 20' AERIAL EASEMENT

10' UTILITY EASEMENT

5' X 20' AERIAL EASEMENT

C2

LOT 30
BLOCK 3
VACANT LOT

S 59° 36' 17" E
272.92'

FND. 1/2" I.R.

FND. 1/2" I.R.

L2

280.00'

S 32° 17' 00" E

280.00'

FND. 1/2" I.R.

FND. 1/2" I.R.

L1

SET 1/2" I.R.

130.00'

FND. 1/2" I.R.

15' UTILITY & DRAINAGE EASEMENT

5' X 20' AERIAL EASEMENT

50' BUILDING LINE

NOT TO SCALE

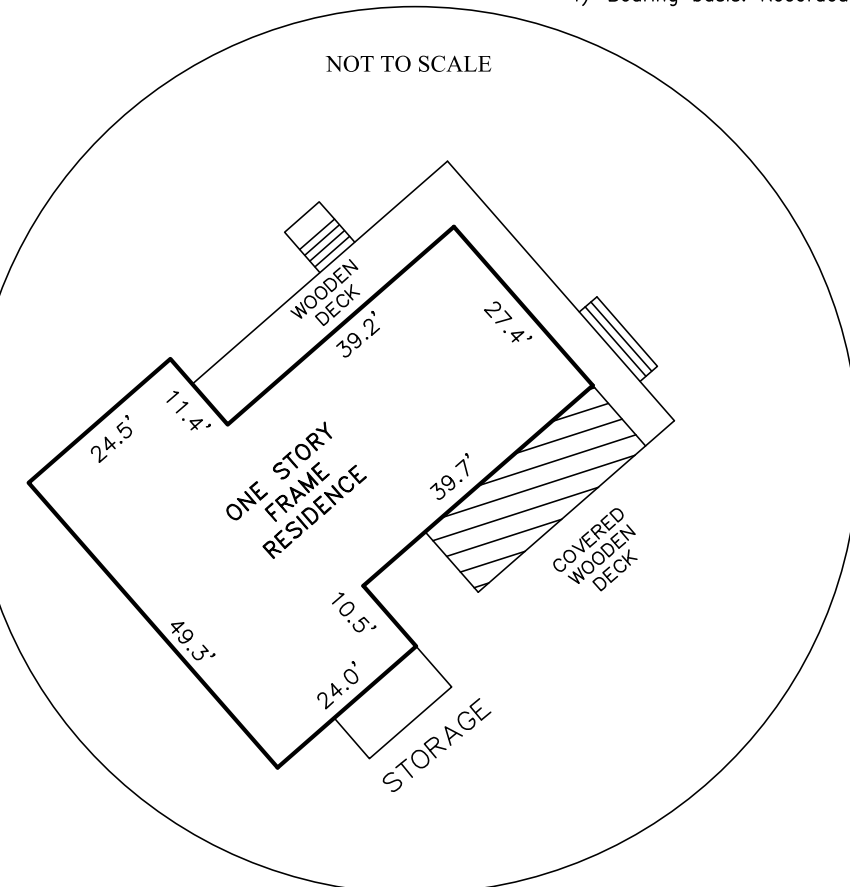

NOTE(S):

- 1) Property subject to subdivision covenants, conditions and restrictions be easements, building lines and other matters of record.
- 2) This survey was done without the benefit of a title report.
- 3) Any and all easements, building lines, and conditions, covenants, and restrictions as set forth in plat recorded under Volume 430, Page 649 of the Map and/or Plat Records of Grimes County, Texas.
- 4) Bearing basis: Recorded subdivision plat.

RESIDENTIAL SURVEY

LOT(S) 30 & 31 BLOCK 3
W MAGNOLIA FIRST, SECTION 18
VOLUME 430, PAGE 649 G.C.M.R.

Date: 2/10/2022
Field Work: SP
Drawn By: SP
Project No.: C22-0208

Prepared For:

Project Location:
17325 Rustic Lane
Waller, Texas 77484
Key Map: --

FLOOD DATA
THIS PROPERTY IS NOT IN THE 100 YEAR FLOOD ZONE.
IS IN ZONE X PER FIRM MAP, COMMUNITY PANEL No. 48185C0550C WHICH HAS AN EFFECTIVE DATE OF 04/03/2012, AND IS NOT IN THE SPECIAL FLOOD HAZARD AREA.



David L. Bowden

TBPLS Firm Registration No. 10127400

© COPYRIGHT 2022 BOWDEN SURVEY CO.
SURVEY is good for this transaction only.
Copying or unauthorized use of this SURVEY not only violates federal and state copyright laws, punishable by CIVIL and CRIMINAL sanctions, but is OUTRIGHT THEFT and harms Bowden Survey Co.'s livelihood. Please don't do it.

SCALE: 1" = 40'

Bowden Survey
Professional Surveying Services
12000 WESTHEIMER RD. STE. 106
Houston, Texas 77077
Phone: (281) 531-1900 Fax: (281) 531-4900