

FLOORPLAN SKETCH

Borrower: N/A

File No.: 36 Lake Bluff

Property Address: 36 Lake Blf

Case No.:

City: Montgomery

State: TX

Zip: 77356

Lender:

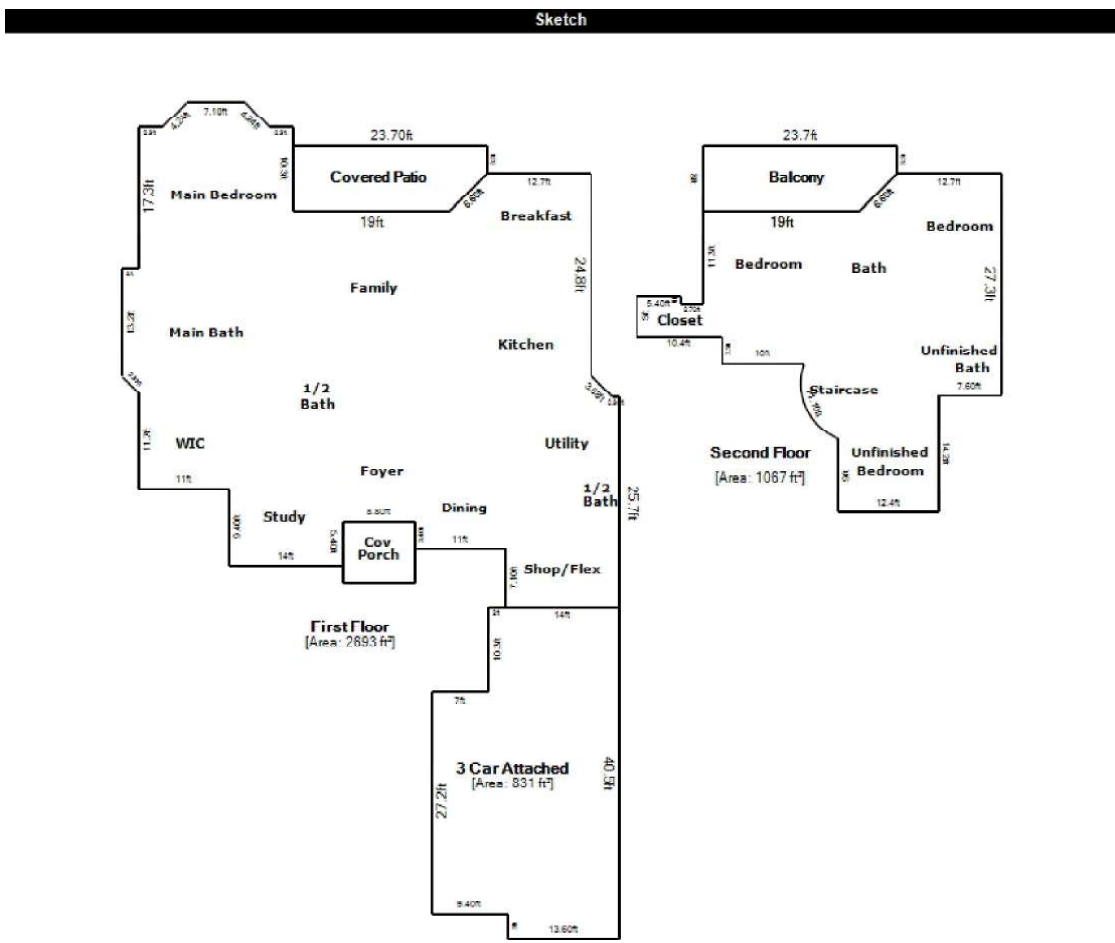

Living Area		Area Calculation	
First Floor	2892.56 ft²	First Floor	x 1.00 = 2892.56 ft²
Second Floor	1066.77 ft²	5.40ft x 14ft	1.00 = 75.60 ft²
Nonliving Area		10.3ft x 2.9ft	0.50 = 14.94 ft²
3 Car Attached	831.20 ft²	2.9ft x 44.2ft	1.00 = 128.18 ft²
Covered Patio	178.56 ft²	0.90ft x 0.90ft	0.50 = 0.40 ft²
Cov Porch	66 ft²	7.10ft x 14ft	1.00 = 99.40 ft²
Balcony	178.56 ft²	3.40ft x 25ft	1.00 = 85.00 ft²
		20.1ft x 20.10ft	0.60 = 202.01 ft²
		4ft x 47.80ft	1.00 = 191.2 ft²
		10.3ft x 10.3ft	0.50 = 53.05 ft²
		7.10ft x 7.10ft	0.50 = 25.21 ft²
		35.60ft x 35.60ft	0.50 = 633.68 ft²
		4.24ft x 10.04ft	0.50 = 21.3 ft²
		10.90ft x 4.50ft	0.46 = 22.72 ft²
		10.70ft x 13.27ft	0.45 = 64.48 ft²
		19.52ft x 20.43ft	0.50 = 277.30 ft²
		13.11ft x 50.35ft	0.30 = 201.14 ft²
		34.48ft x 16.30ft	0.49 = 276.28 ft²
		44.2ft x 3ft	0.50 = 66.3 ft²
		47.2ft x 4.24ft	0.35 = 70.8 ft²
		15.84ft x 3.68ft	0.50 = 29.12 ft²
		19.52ft x 5.20ft	0.35 = 35.88 ft²
		1.27ft x 1.80ft	0.35 = 0.81 ft²
		14.57ft x 1.27ft	1.00 = 18.54 ft²
		6.65ft x 4.70ft	0.35 = 11.05 ft²
		12.7ft x 4.7ft	1.00 = 59.69 ft²
		2.83ft x 2ft	0.35 = 2 ft²
		13.2ft x 2ft	1.00 = 26.4 ft²
		Second Floor	x 1.00 = 1066.77 ft²
		5ft x 5.40ft	1.00 = 27.00 ft²
		2.70ft x 4ft	1.00 = 10.8 ft²
		15.3ft x 36.40ft	1.00 = 556.92 ft²
		7.60ft x 7.3ft	1.00 = 55.48 ft²
		10ft x 3.3ft	1.00 = 33 ft²
		21.5ft x 12.4ft	1.00 = 266.6 ft²
		10.07ft x 9.20ft	0.20 = 18.88 ft²
		3.3ft x 4.10ft	1.00 = 13.53 ft²
		6.65ft x 4.70ft	0.35 = 11.05 ft²
		12.7ft x 4.7ft	1.00 = 59.69 ft²
Total Living Area (rounded):	3759 ft²	Arc: 10.07ft	Arc: 2ft