

ELEVATION CERTIFICATE

Important: Read the instructions on pages 1-9.

OMB No. 1680-0008
Expiration Date: July 31, 2015

SECTION A - PROPERTY INFORMATION

A1 Building Owner's Name ERIN ST LAURENT

A2 Building Street Address (including Apt., Unit, Suite, and/or Bldg. No.) or P.O. Route and Box No
1208 EAST 29TH STREET
City HOUSTON State TX ZIP Code 77009

FOR INSURANCE COMPANY USE
Policy Number
Company NAIC Number

A3 Property Description (Lot and Block Numbers, Tax Parcel Number, Legal Description, etc.)
LOT 7 BLOCK 1 OF SUNSET HEIGHTS PLACE, REPLAT NO. 1 IN HARRIS COUNTY, TEXAS

A4 Building Use (e.g., Residential, Non-Residential, Addition, Accessory, etc.) RESIDENTIAL

A5 Latitude/Longitude: Lat 29.813082 Long -95.383321 Horizontal Datum: NAD 1927 NAD 1983

A6 Attach at least 2 photographs of the building if the Certificate is being used to obtain flood insurance.

A7 Building Diagram Number 1A

A8 For a building with a crawspace or enclosure(s):
a) Square footage of crawspace or enclosure(s) NA sq ft
b) Number of permanent flood openings in the crawspace or enclosure(s) within 1.0 foot above adjacent grade NA
c) Total net area of flood openings in A8.b NA sq in
d) Engineered flood openings? Yes No

A9 For a building with an attached garage:
a) Square footage of attached garage 324 sq ft
b) Number of permanent flood openings in the attached garage within 1.0 foot above adjacent grade NA
c) Total net area of flood openings in A9.b NA sq in
d) Engineered flood openings? Yes No

SECTION B - FLOOD INSURANCE RATE MAP (FIRM) INFORMATION

B1 NFIP Community Name & Community Number
CITY OF HOUSTON 480298

B2 County Name
HARRIS

B3 State
TEXAS

B4 Map/Panel Number
48201 C 0660

B5 Suffix
M

B6 FIRM Index Date
05/04/2015

B7 FIRM Panel Effective/Revised Date
06/09/2014

B8 Flood Zone(s)
AE

B9 Base Flood Elevation(s) (Zone AO, use base flood depth)
56.8 FEET

B10 Indicate the source of the Base Flood Elevation (BFE) data or base flood depth entered in Item B9
 FIS Profile FIRM Community Determined Other/Source: _____

B11 Indicate elevation datum used for BFE in Item B9: NGVD 1929 NAVD 1988 Other/Source: 2001 ADJ

B12 Is the building located in a Coastal Barrier Resources System (CBRS) area or Otherwise Protected Area (OPA)?
Designation Date: _____ CBRS OPA Yes No

SECTION C - BUILDING ELEVATION INFORMATION (SURVEY REQUIRED)

C1 Building elevations are based on: Construction Drawings* Building Under Construction* Finished Construction
*A new Elevation Certificate will be required when construction of the building is complete.

C2 Elevations - Zones A1-A30, AE, AH, A (with BFE), VE, V1-V30, V (with BFE), AR, AR/A, AR/AE, AR/A1-A30, AR/AH, AR/AO. Complete items C2.a-h below according to the building diagram specified in Item A7. In Puerto Rico only, enter meters.

Benchmark Utilized: RM 050145 EL = 47.24 FEET Vertical Datum: NAVD 88, 2001 ADJ

Indicate elevation datum used for the elevations in items a) through h) below. NGVD 1929 NAVD 1988 Other/Source: _____

Datum used for building elevations must be the same as that used for the BFE.

a) Top of bottom floor (including basement, crawspace, or enclosure floor) 58.3 feet meters

b) Top of the next higher floor NA feet meters

c) Bottom of the lowest horizontal structural member (V Zones only) NA feet meters

d) Attached garage (top of slab) 57.6 feet meters

e) Lowest elevation of machinery or equipment servicing the building (Describe type of equipment and location in Comments) 57.7 feet meters

f) Lowest adjacent (finished) grade next to building (LAG) 57.4 feet meters

g) Highest adjacent (finished) grade next to building (HAG) 57.9 feet meters

h) Lowest adjacent grade at lowest elevation of deck or stairs, including structural support NA feet meters

SECTION D - SURVEYOR, ENGINEER, OR ARCHITECT CERTIFICATION

This certification is to be signed and sealed by a land surveyor, engineer, or architect authorized by law to certify elevation information. I certify that the information on this Certificate represents my best efforts to interpret the data available. I understand that any false statement may be punishable by fine or imprisonment under 18 U.S. Code, Section 1001.

Check here if comments are provided on back of form. Check here if attachments

Were latitude and longitude in Section A provided by a licensed land surveyor? Yes No

Certifier's Name JAMES P. WALKOVIAK License Number 5971

Title R.P.L.S. Company Name PRECISION SURVEYORS INC.

Address 950 THREADNEEDLE ST #150 City HOUSTON State TX ZIP Code 77079

Signature *James P. Walkoviak* Date 07/01/2015 Telephone 281-496-1586

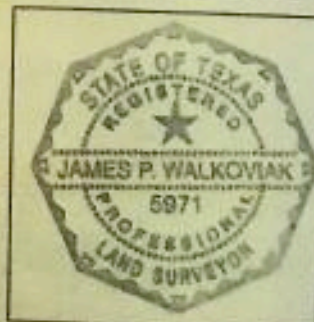

ELEVATION CERTIFICATE

Important: Read the instructions on pages 1-9.

OMB No. 1660-0008
Expiration Date: July 31, 2015

SECTION A - PROPERTY INFORMATION

A1 Building Owner's Name ERIN ST LAURENT

A2 Building Street Address (including Apt., Unit, Suite, and/or Bldg. No.) or P.O. Route and Box No.
1208 EAST 29TH STREET

City HOUSTON State TX ZIP Code 77009

FOR INSURANCE COMPANY USE

Policy Number:

Company NAIC Number:

A3 Property Description (Lot and Block Numbers, Tax Parcel Number, Legal Description, etc.)
LOT 7 BLOCK 1 OF SUNSET HEIGHTS PLACE REPLAT NO 1 IN HARRIS COUNTY, TEXAS

A4 Building Use (e.g., Residential, Non-Residential, Addition, Accessory, etc.) RESIDENTIAL

A5 Latitude/Longitude Lat 29.813062 Long -95.383321 Horizontal Datum: NAD 1927 NAD 1983

A6 Attach at least 2 photographs of the building if the Certificate is being used to obtain flood insurance.

A7 Building Diagram Number 1A

A8 For a building with a crawlspace or enclosure(s):

a) Square footage of crawlspace or enclosure(s) NA sq ft

b) Number of permanent flood openings in the crawlspace or enclosure(s) within 1.0 foot above adjacent grade NA

c) Total net area of flood openings in A8.b NA sq in

d) Engineered flood openings? Yes No

A9 For a building with an attached garage:

a) Square footage of attached garage 324 sq ft

b) Number of permanent flood openings in the attached garage within 1.0 foot above adjacent grade NA

c) Total net area of flood openings in A9.b NA sq in

d) Engineered flood openings? Yes No

SECTION B - FLOOD INSURANCE RATE MAP (FIRM) INFORMATION

B1 NFIP Community Name & Community Number
CITY OF HOUSTON 480296

B2 County Name
HARRIS

B3 State
TEXAS

B4 Map/Panel Number <u>48201 C 0660</u>	B5 Suffix <u>M</u>	B6 FIRM Index Date <u>05/04/2015</u>	B7 FIRM Panel Effective/Revised Date <u>06/09/2014</u>	B8 Flood Zone(s) <u>AE</u>	B9 Base Flood Elevation(s) (Zone AO, use base flood depth) <u>56.8 FEET</u>
--	-----------------------	---	---	-------------------------------	--

B10 Indicate the source of the Base Flood Elevation (BFE) data or base flood depth entered in Item B9:
 FIS Profile FIRM Community Determined Other/Source: _____

B11 Indicate elevation datum used for BFE in Item B9: NGVD 1929 NAVD 1988 Other/Source: 2001 ADJ.

B12 Is the building located in a Coastal Barrier Resources System (CBRS) area or Otherwise Protected Area (OPA)?
Designation Date: _____ CBRS OPA Yes No

SECTION C - BUILDING ELEVATION INFORMATION (SURVEY REQUIRED)

C1 Building elevations are based on: Construction Drawings* Building Under Construction* Finished Construction
*A new Elevation Certificate will be required when construction of the building is complete.

C2 Elevations - Zones A1-A30, AE, AH, A (with BFE), VE, V1-V30, V (with BFE), AR, AR/A, AR/AE, AR/A1-A30, AR/AH, AR/AO. Complete Items C2.a-h below according to the building diagram specified in Item A7. In Puerto Rico only, enter meters.
Benchmark Utilized: RM 050145 EL = 47.24 FEET Vertical Datum: NAVD 88, 2001 ADJ.

Indicate elevation datum used for the elevations in items a) through h) below: NGVD 1929 NAVD 1988 Other/Source: _____
Datum used for building elevations must be the same as that used for the BFE.

a) Top of bottom floor (including basement, crawlspace, or enclosure floor)	<u>58.3</u>	Check the measurement used:
b) Top of the next higher floor	<u>NA</u>	<input checked="" type="checkbox"/> feet <input type="checkbox"/> meters
c) Bottom of the lowest horizontal structural member (V Zones only)	<u>NA</u>	<input type="checkbox"/> feet <input type="checkbox"/> meters
d) Attached garage (top of slab)	<u>57.6</u>	<input type="checkbox"/> feet <input type="checkbox"/> meters
e) Lowest elevation of machinery or equipment servicing the building (Describe type of equipment and location in Comments)	<u>57.7</u>	<input checked="" type="checkbox"/> feet <input type="checkbox"/> meters
f) Lowest adjacent (finished) grade next to building (LAG)	<u>57.4</u>	<input checked="" type="checkbox"/> feet <input type="checkbox"/> meters
g) Highest adjacent (finished) grade next to building (HAG)	<u>57.9</u>	<input checked="" type="checkbox"/> feet <input type="checkbox"/> meters
h) Lowest adjacent grade at lowest elevation of deck or stairs, including structural support	<u>NA</u>	<input type="checkbox"/> feet <input type="checkbox"/> meters

SECTION D - SURVEYOR, ENGINEER, OR ARCHITECT CERTIFICATION

This certification is to be signed and sealed by a land surveyor, engineer, or architect authorized by law to certify elevation information. I certify that the information on this Certificate represents my best efforts to interpret the data available. I understand that any false statement may be punishable by fine or imprisonment under 18 U.S. Code, Section 1001.

Check here if comments are provided on back of form. Check here if attachments.

Were latitude and longitude in Section A provided by a licensed land surveyor? Yes No

Certifier's Name JAMES P. WALKOVIAK License Number 5971

Title R.P.L.S. Company Name PRECISION SURVEYORS INC

Address 950 THREADNEEDLE ST. #150 City HOUSTON State TX ZIP Code 77079

Signature [Signature] Date 07/01/2015 Telephone 281-496-1586

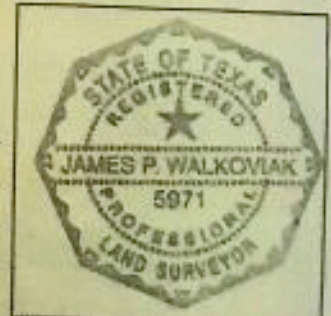

IMPORTANT: In these spaces, copy the corresponding information from Section A.

Building Street Address (including Apt. Unit, Suite and/or Bldg No.) or P.O. Route and Box No
1208 EAST 29TH STREET

City HOUSTON

State TX ZIP Code 77009

FOR INSURANCE COMPANY USE

Policy Number:

Company NAIC Number:

SECTION D - SURVEYOR, ENGINEER, OR ARCHITECT CERTIFICATION (CONTINUED)

Copy both sides of this Elevation Certificate for (1) community official, (2) insurance agent/company, and (3) building owner.

Comments: C2 e) AIR CONDITIONER PAD

Signature

Date 07/01/2015

SECTION E - BUILDING ELEVATION INFORMATION (SURVEY NOT REQUIRED) FOR ZONE AO AND ZONE A (WITHOUT BFE)

For Zones AO and A (without BFE), complete Items E1-E5. If the Certificate is intended to support a LOMA or LOMR-F request, complete Sections A, B, and C. For Items E1-E4, use natural grade, if available. Check the measurement used. In Puerto Rico only, enter meters.

- E1. Provide elevation information for the following and check the appropriate boxes to show whether the elevation is above or below the highest adjacent grade (HAG) and the lowest adjacent grade (LAG).
 - a) Top of bottom floor (including basement, crawlspace, or enclosure) is _____ feet meters above or below the HAG.
 - b) Top of bottom floor (including basement, crawlspace, or enclosure) is _____ feet meters above or below the LAG.
- E2. For Building Diagrams 6-9 with permanent flood openings provided in Section A Items 8 and/or 9 (see pages 8-9 of instructions), the next higher floor (elevation C2.b in the diagrams) of the building is _____ feet meters above or below the HAG.
- E3. Attached garage (top of slab) is _____ feet meters above or below the HAG.
- E4. Top of platform of machinery and/or equipment servicing the building is _____ feet meters above or below the HAG.
- E5. Zone AO only: If no flood depth number is available, is the top of the bottom floor elevated in accordance with the community's floodplain management ordinance? Yes No Unknown. The local official must certify this information in Section G.

SECTION F - PROPERTY OWNER (OR OWNER'S REPRESENTATIVE) CERTIFICATION

The property owner or owner's authorized representative who completes Sections A, B, and E for Zone A (without a FEMA-issued or community-issued BFE) or Zone AO must sign here. The statements in Sections A, B, and E are correct to the best of my knowledge.

Property Owner's or Owner's Authorized Representative's Name

Address _____ City _____ State _____ ZIP Code _____

Signature _____ Date _____ Telephone _____

Comments

Check here if attachments.

SECTION G - COMMUNITY INFORMATION (OPTIONAL)

The local official who is authorized by law or ordinance to administer the community's floodplain management ordinance can complete Sections A, B, C (or E), and G of this Elevation Certificate. Complete the applicable item(s) and sign below. Check the measurement used in Items G8-G10. In Puerto Rico only, enter meters.

- G1. The information in Section C was taken from other documentation that has been signed and sealed by a licensed surveyor, engineer, or architect who is authorized by law to certify elevation information. (Indicate the source and date of the elevation data in the Comments area below.)
- G2. A community official completed Section E for a building located in Zone A (without a FEMA-issued or community-issued BFE) or Zone AO.
- G3. The following information (Items G4-G10) is provided for community floodplain management purposes.

G4. Permit Number	G5. Date Permit Issued	G6. Date Certificate Of Compliance/Occupancy Issued
-------------------	------------------------	---

- G7. This permit has been issued for New Construction Substantial Improvement
- G8. Elevation of as-built lowest floor (including basement) of the building: _____ feet meters Datum _____
- G9. BFE or (in Zone AO) depth of flooding at the building site: _____ feet meters Datum _____
- G10. Community's design flood elevation: _____ feet meters Datum _____

Local Official's Name _____ Title _____

Community Name _____ Telephone _____

Signature _____ Date _____

Comments

Check here if attachments.

Building Photographs

See Instructions for Item A5

IMPORTANT: In these spaces, copy the corresponding information from Section A.Building Street Address (including Apt. Unit, Suite, and/or Bldg. No.) or P.O. Route and Box No.
1208 EAST 29TH STREET

City HOUSTON

State TX ZIP Code 77009

FOR INSURANCE COMPANY USE

Policy Number

Company NAIC Number

If using the Elevation Certificate to obtain NFIP flood insurance, affix at least 2 building photographs below according to the instructions for Item A5. Identify all photographs with date taken, "Front View" and "Rear View"; and, if required, "Right Side View" and "Left Side View." When applicable, photographs must show the foundation with representative examples of the flood openings or vents, as indicated in Section A5. If submitting more photographs than will fit on this page, use the Continuation Page.

FRONT VIEW 07/01/2015



Building Photographs

Continuation Page

IMPORTANT: In these spaces, copy the corresponding information from Section A.Building Street Address (including Apt., Unit, Suite, and/or Bldg. No.) or P.O. Route and Box No.
1205 EAST 29TH STREET

City HOUSTON

State TX

ZIP Code 77009

FOR INSURANCE COMPANY USE

Policy Number

Company NAIC Number

If submitting more photographs than will fit on the preceding page, affix the additional photographs below. Identify all photographs with date taken, "Front View" and "Rear View" and, if required, "Right Side View" and "Left Side View." When applicable, photographs must show the foundation with representative examples of the flood openings or vents, as indicated in Section A8.

REAR VIEW 07/01/2015



ELEVATION CERTIFICATE

Important: Read the instructions on pages 1-9.

OMB No. 1660-0008
Expiration Date: July 31, 2015

SECTION A - PROPERTY INFORMATION

FOR INSURANCE COMPANY USE

A1 Building Owner's Name ERIN ST LAURENT

Policy Number

A2 Building Street Address (including Apt., Unit, Suite, and/or Bldg. No.) or P.O. Route and Box No.
1208 EAST 29TH STREET

Company NAIC Number

City HOUSTON

State TX

ZIP Code 77009

A3 Property Description (Lot and Block Numbers, Tax Parcel Number, Legal Description, etc.)
LOT 7 BLOCK 1 OF SUNSET HEIGHTS PLACE REPLAT NO 1 IN HARRIS COUNTY, TEXAS

A4 Building Use (e.g., Residential, Non-Residential, Addition, Accessory, etc.) RESIDENTIAL

A5 Latitude/Longitude Lat 29.813082 Long. -95.383321 Horizontal Datum NAD 1927 NAD 1983

A6 Attach at least 2 photographs of the building if the Certificate is being used to obtain flood insurance.

A7 Building Diagram Number 1A

A8 For a building with a crawlspace or enclosure(s):

- a) Square footage of crawlspace or enclosure(s) NA sq ft
b) Number of permanent flood openings in the crawlspace or enclosure(s) within 1.0 foot above adjacent grade NA
c) Total net area of flood openings in A8.b NA sq in
d) Engineered flood openings? Yes No

A9 For a building with an attached garage

- a) Square footage of attached garage 324 sq ft
b) Number of permanent flood openings in the attached garage within 1.0 foot above adjacent grade NA
c) Total net area of flood openings in A9.b NA sq in
d) Engineered flood openings? Yes No

SECTION B - FLOOD INSURANCE RATE MAP (FIRM) INFORMATION

B1 NFIP Community Name & Community Number
CITY OF HOUSTON 480296

B2 County Name
HARRIS

B3 State
TEXAS

B4 Map/Panel Number
48201 C 0660

B5 Suffix
M

B6 FIRM Index Date
05/04/2015

B7 FIRM Panel Effective/Revised Date
06/09/2014

B8 Flood Zone(s)
AE

B9 Base Flood Elevation(s) (Zone AO, use base flood depth)
56.8 FEET

B10 Indicate the source of the Base Flood Elevation (BFE) data or base flood depth entered in Item B9
 FIS Profile FIRM Community Determined Other/Source: _____

B11 Indicate elevation datum used for BFE in item B9: NGVD 1929 NAVD 1988 Other/Source: 2001 ADJ.

B12 Is the building located in a Coastal Barrier Resources System (CBRS) area or Otherwise Protected Area (OPA)? Yes No
Designation Date: _____
 CBRS OPA

SECTION C - BUILDING ELEVATION INFORMATION (SURVEY REQUIRED)

C1 Building elevations are based on: Construction Drawings* Building Under Construction* Finished Construction
*A new Elevation Certificate will be required when construction of the building is complete.

C2 Elevations - Zones A1-A30, AE, AH, A (with BFE), VE, V1-V30, V (with BFE), AR, AR/A, AR/AE, AR/A1-A30, AR/AH, AR/AO. Complete items C2.a-h below according to the building diagram specified in item A7. In Puerto Rico only, enter meters.

Benchmark Utilized: RM 050145 EL = 47.24 FEET

Vertical Datum: NAVD 88, 2001 ADJ.

Indicate elevation datum used for the elevations in items a) through h) below. NGVD 1929 NAVD 1988 Other/Source: _____
Datum used for building elevations must be the same as that used for the BFE.

- | | | |
|--|----------------------------|--|
| a) Top of bottom floor (including basement, crawlspace, or enclosure floor) | <u>58.3</u> | Check the measurement used. |
| b) Top of the next higher floor | <u>NA</u> | <input checked="" type="checkbox"/> feet <input type="checkbox"/> meters |
| c) Bottom of the lowest horizontal structural member (V Zones only) | <u>NA</u> | <input type="checkbox"/> feet <input type="checkbox"/> meters |
| d) Attached garage (top of slab) | <u>NA</u> | <input type="checkbox"/> feet <input type="checkbox"/> meters |
| e) Lowest elevation of machinery or equipment servicing the building (Describe type of equipment and location in Comments) | <u>57.8</u>
<u>57.7</u> | <input checked="" type="checkbox"/> feet <input type="checkbox"/> meters
<input checked="" type="checkbox"/> feet <input type="checkbox"/> meters |
| f) Lowest adjacent (finished) grade next to building (LAG) | <u>57.4</u> | <input checked="" type="checkbox"/> feet <input type="checkbox"/> meters |
| g) Highest adjacent (finished) grade next to building (HAG) | <u>57.8</u> | <input checked="" type="checkbox"/> feet <input type="checkbox"/> meters |
| h) Lowest adjacent grade at lowest elevation of deck or stairs, including structural support | <u>NA</u> | <input type="checkbox"/> feet <input type="checkbox"/> meters |

SECTION D - SURVEYOR, ENGINEER, OR ARCHITECT CERTIFICATION

This certification is to be signed and sealed by a land surveyor, engineer, or architect authorized by law to certify elevation information. I certify that the information on this Certificate represents my best efforts to interpret the data available. I understand that any false statement may be punishable by fine or imprisonment under 18 U.S. Code, Section 1001.

Check here if comments are provided on back of form.

Check here if attachments

Were latitude and longitude in Section A provided by a licensed land surveyor? Yes No

Certifier's Name JAMES P. WALKOWIAK

License Number 5971

Title R.P.L.S.

Company Name PRECISION SURVEYORS INC.

Address 950 THREADNEEDLE ST #150

City HOUSTON

State TX ZIP Code 77079

Signature *James P. Walkowiak*

Date 07/01/2015

Telephone 281-496-1586

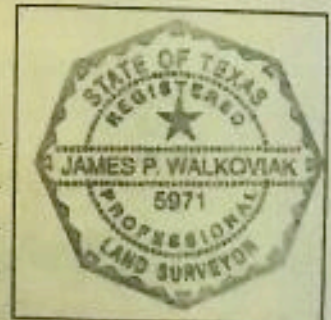

IMPORTANT: In these spaces, copy the corresponding information from Section A.	FOR INSURANCE COMPANY USE
Building Street Address (including Apt. Unit, Suite and/or Bldg No.) or P.O. Route and Box No. 1208 EAST 29TH STREET	Policy Number:
City HOUSTON State TX ZIP Code 77009	Company NAIC Number:

SECTION D – SURVEYOR, ENGINEER, OR ARCHITECT CERTIFICATION (CONTINUED)

Copy both sides of the Elevation Certificate for (1) community official, (2) insurance agent/company, and (3) building owner.

Comments C2 e) AIR CONDITIONER PAD

Signature *Luca P. [Signature]* Date 07/01/2015

SECTION E – BUILDING ELEVATION INFORMATION (SURVEY NOT REQUIRED) FOR ZONE AO AND ZONE A (WITHOUT BFE)

For Zones AO and A (without BFE), complete Items E1–E5. If the Certificate is intended to support a LOMA or LOMR-F request, complete Sections A, B, and C. For Items E1–E4, use natural grade, if available. Check the measurement used. In Puerto Rico only, enter meters.

- E1. Provide elevation information for the following and check the appropriate boxes to show whether the elevation is above or below the highest adjacent grade (HAG) and the lowest adjacent grade (LAG).
- a) Top of bottom floor (including basement, crawlspace, or enclosure) is _____ feet meters above or below the HAG.
- b) Top of bottom floor (including basement, crawlspace, or enclosure) is _____ feet meters above or below the LAG.
- E2. For Building Diagrams 6–9 with permanent flood openings provided in Section A Items 8 and/or 9 (see pages 8–9 of instructions), the next higher floor (elevation C2.b in the diagrams) of the building is _____ feet meters above or below the HAG.
- E3. Attached garage (top of slab) is _____ feet meters above or below the HAG.
- E4. Top of platform of machinery and/or equipment servicing the building is _____ feet meters above or below the HAG.
- E5. Zone AO only: If no flood depth number is available, is the top of the bottom floor elevated in accordance with the community's floodplain management ordinance? Yes No Unknown. The local official must certify this information in Section G.

SECTION F – PROPERTY OWNER (OR OWNER'S REPRESENTATIVE) CERTIFICATION

The property owner or owner's authorized representative who completes Sections A, B, and E for Zone A (without a FEMA-issued or community-issued BFE) or Zone AO must sign here. The statements in Sections A, B, and E are correct to the best of my knowledge.

Property Owner's or Owner's Authorized Representative's Name _____

Address _____ City _____ State _____ ZIP Code _____

Signature _____ Date _____ Telephone _____

Comments _____

Check here if attachments.

SECTION G – COMMUNITY INFORMATION (OPTIONAL)

The local official who is authorized by law or ordinance to administer the community's floodplain management ordinance can complete Sections A, B, C (or E), and G of this Elevation Certificate. Complete the applicable item(s) and sign below. Check the measurement used in Items G8–G10. In Puerto Rico only, enter meters.

- G1. The information in Section C was taken from other documentation that has been signed and sealed by a licensed surveyor, engineer, or architect who is authorized by law to certify elevation information. (Indicate the source and date of the elevation data in the Comments area below.)
- G2. A community official completed Section E for a building located in Zone A (without a FEMA-issued or community-issued BFE) or Zone AO.
- G3. The following information (Items G4–G10) is provided for community floodplain management purposes.

G4. Permit Number	G5. Date Permit Issued	G6. Date Certificate Of Compliance/Occupancy Issued
-------------------	------------------------	---

G7. This permit has been issued for: New Construction Substantial Improvement

G8. Elevation of as-built lowest floor (including basement) of the building: _____ feet meters Datum _____

G9. BFE or (in Zone AO) depth of flooding at the building site: _____ feet meters Datum _____

G10. Community's design flood elevation _____ feet meters Datum _____

Local Official's Name _____ Title _____

Community Name _____ Telephone _____

Signature _____ Date _____

Comments _____

Check here if attachments.

Building Photographs

See instructions for Item A6.

IMPORTANT: In these spaces, copy the corresponding information from Section A.Building Street Address (including Apt., Unit, Suite, and/or Bldg. No.) or P.O. Route and Box No.
1208 EAST 29TH STREET

City HOUSTON

State TX ZIP Code 77009

FOR INSURANCE COMPANY USE

Policy Number

Company NAIC Number

If using the Elevation Certificate to obtain NFIP flood insurance, affix at least 2 building photographs below according to the instructions for Item A6. Identify all photographs with date taken, "Front View" and "Rear View", and, if required, "Right Side View" and "Left Side View". When applicable, photographs must show the foundation with representative examples of the flood openings or vents, as indicated in Section A5. If submitting more photographs than will fit on this page, use the Continuation Page.

FRONT VIEW 07/01/2015

Building Photographs

Continuation Page

IMPORTANT: In these spaces, copy the corresponding information from Section A.

Building Street Address (including Apt., Unit, Suite, and/or Bldg. No.) or P.O. Route and Box No.
1206 EAST 28TH STREET

City HOUSTON

State TX

ZIP Code 77009

FOR INSURANCE COMPANY USE

Policy Number

Company NAIC Number

If submitting more photographs than will fit on the preceding page, affix the additional photographs below. Identify all photographs with date taken, "Front View" and "Rear View" and, if required, "Right Side View" and "Left Side View." When applicable, photographs must show the foundation with representative examples of the flood openings or vents, as indicated in Section AB.

REAR VIEW 07/01/2015

