

SET 1/2" I.R.  
W/CAP MARKED  
SURVEY 1"

**NOTES**

1. ALL BEARINGS SHOWN HEREON ARE REFERENCED TO THE SUBDIVISION PLAT NAMED BELOW, POINTS (A) AND (B) WERE HELD FOR HORIZONTAL CONTROL.
2. ABSTRACT INFORMATION FOR THE SUBJECT TRACT WAS PROVIDED BY THE TITLE INSURANCE COMPANY LISTED BELOW.
3. SURVEYOR HAS NOT INDEPENDENTLY ABSTRACTED SUBJECT PROPERTY.
4. THIS SURVEY IS CERTIFIED TO THE TITLE INSURANCE COMPANY LISTED BELOW FOR THIS TRANSACTION ONLY. IT IS NOT TRANSFERABLE TO ADDITIONAL INSTITUTIONS OR SUBSEQUENT OWNERS.
5. ALL EASEMENTS AND BUILDING LINES SHOWN ARE PER THE RECORDED PLAT UNLESS OTHERWISE NOTED.
6. THERE ARE NATURAL DRAINAGE COURSES ON SUBJECT PROPERTY.
7. SUBJECT TO THE RESTRICTIVE COVENANTS AS LISTED IN SCHEDULE B OF THE TITLE COMMITMENT ISSUED ON MAY 03, 2022, UNDER G.F. NO. ATCH-80F-ATCH22119172MA.



TITLE COMPANY:

**Alamo Title Company**

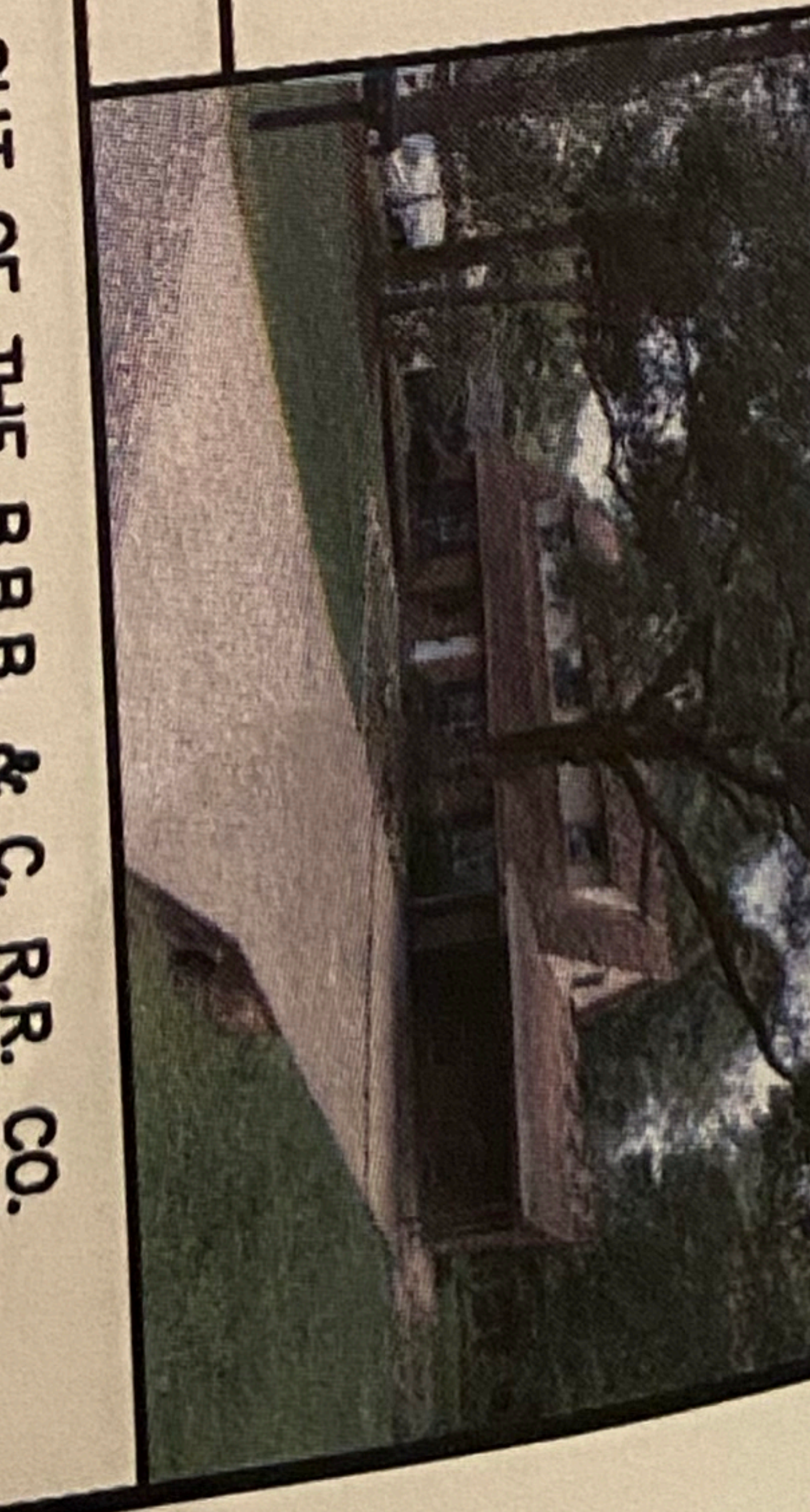

**LEGAL DESCRIPTION:**

TRACT I: LOTS 9 & 10, OF LAKESIDE VILLAGE, A SUBDIVISION OF 29.14 ACRES OUT OF THE B.B.B. & C. R.R. CO. SURVEY, ABSTRACT 161, IN BRAZORIA COUNTY, TEXAS, ACCORDING TO THE MAP OR PLAT THEREOF RECORDED IN VOLUME 12, PAGE 94 OF THE PLAT RECORDS OF BRAZORIA COUNTY, TEXAS.

TRACT II: A TRACT OF LAND CONTAINING 1.9304 ACRES (84,088 SQUARE FEET) SITUATED IN THE B.B.B. & C. R.R. CO. SURVEY ABSTRACT 161, BRAZORIA COUNTY, TEXAS AND ALSO CALLED LOT 6-B. SAID TRACT BEING MORE PARTICULARLY DESCRIBED BY METES AND BOUNDS AS ATTACHED.

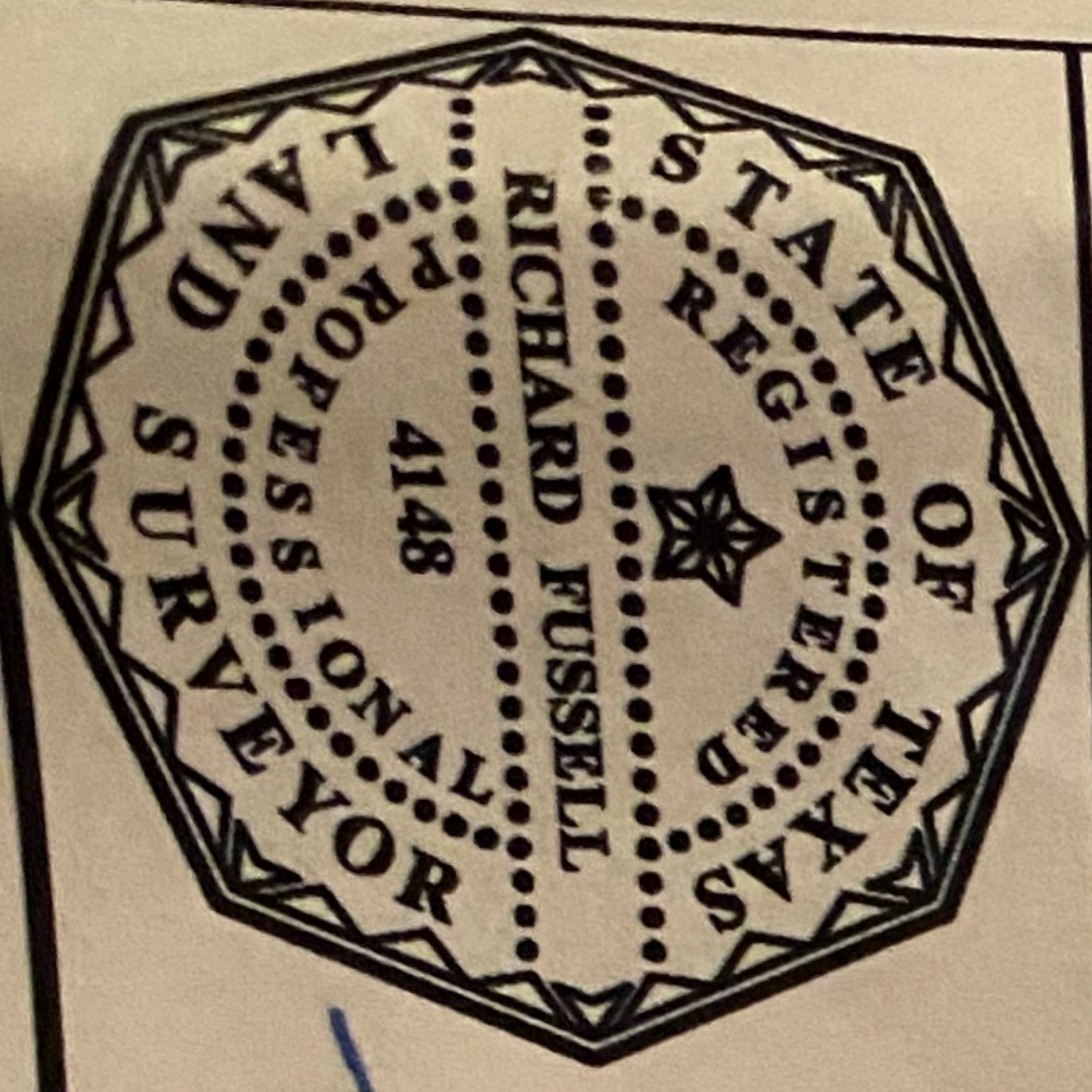

SURVEYORS CERTIFICATE:  
IN MY PROFESSIONAL OPINION, THIS PLAT REPRESENTS THE FACTS FOUND ON THE GROUND DURING THE COURSE OF A BOUNDARY SURVEY CONDUCTED UNDER MY SUPERVISION ON MAY 04, 2022 AND THAT THIS PLAT SUBSTANTIALLY COMPLIES WITH THE CURRENT STANDARDS AS ADOPTED BY THE TEXAS BOARD OF PROFESSIONAL LAND SURVEYING AND THAT THERE ARE NO ENCROACHMENTS OR PROTRUSIONS EXCEPT AS SHOWN.

RICHARD FUSSELL  
RPLS# 4148

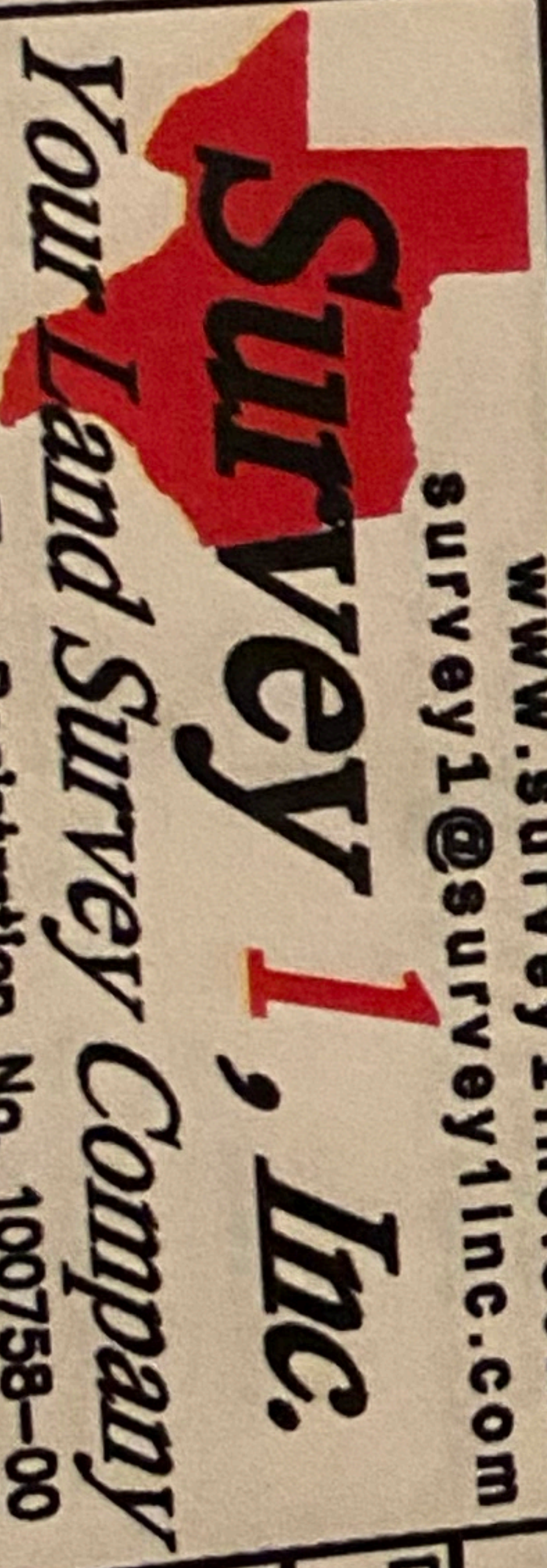

Firm Registration No. 100758-00  
P.O. Box 2543 | Alyn, TX 77512 | (281)393-1382

CLIENT: CHRISTOPHER CYRIL ATANASOV AND JAMIE ATANASOV  
ADDRESS: 178 WEST COUNTY ROAD 136  
www.survey1inc.com  
survey1@survey1inc.com

FIELD CREW:	JF	TECH:	RK
DRAFTER:	AR	FINAL CHECK:	EF
DATE:	5-10-22		
JOB#	5-111376-22		

G.F. # ATCH-80F-ATCH22119172MA  
ISSUE DATE: MAY 03, 2022