

- NOTES:
1. RESTRICTIVE COVENANTS BY VOL. 193 PG. 106 M.R.H.C.
  2. H.L.&P. AGREEMENT BY C.C.F No. D739666.
  3. BUILDING RESTRICTIONS BY THE RECORDED PLAT AND IN C.C.F. No. D711279.

GF No. FAH19001562

TRACT: SOUTH PORTION OF LOT 5 (SEE METES AND BOUNDS)		BLK: 1	SUBDIVISION: KINGS FOREST, SECTION ONE (1)	
COUNTY: HARRIS	STATE: TEXAS	RECORDATION: VOL. 193 PG. 106 M.R.H.C	JOB NO. 2410 K	
PURCHASER: MELANIE ROSE		MORTGAGE CO.	FIELD: 3-10-19 D.F.	
ADDRESS: 2410 KINGS FOREST DRIVE		TITLE CO. FIDELITY NATIONAL TITLE	DRAFT: 3-12-19 J.E.C	
		FINAL CHK: 3-13-19 S.R.		

THIS SURVEY IS VALID FOR THIS TRANSACTION ONLY. ALL BEARINGS BASED ON THE DEED OF RECORD UNLESS OTHERWISE NOTED.

**COPPERFIELD SURVEYING**  
 12436 F.M. 1960 WEST, #128  
 HOUSTON TEXAS, 77065  
 832-217-7903  
 COPPERFIELD\_SURVEYING@HOTMAIL.COM  
 FIRM NUMBER 10193752

I DO HEREBY CERTIFY THAT THIS SURVEY WAS MADE ON THE GROUND UNDER MY SUPERVISION AND THAT IT CORRECTLY REPRESENTS THE FACTS FOUND AT THE TIME OF THE SURVEY. THERE ARE NO ENCROACHMENTS APPARENT EXCEPT AS SHOWN.

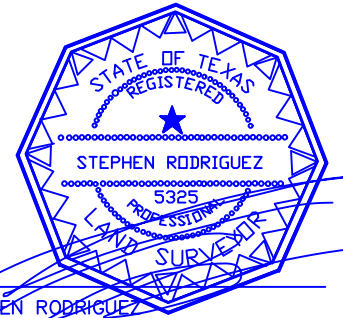

STEPHEN RODRIGUEZ  
 TEXAS REGISTERED PROFESSIONAL  
 LAND SURVEYOR NO. 5325

3-13-19  
 DATE

FEMA INFORMATION

SUBJECT PROPERTY IS NOT LOCATED IN A FEDERAL INSURANCE ADMINISTRATION DESIGNATED FLOOD HAZARD AREA ZONE 'X' AS PER MAP 480296 PANEL 48201C0315 DATED 06/18/2007.

THE FLOOD INFORMATION IS FROM A F.E.M.A. MAP. WE ARE NOT RESPONSIBLE FOR ITS ACCURACY.

EXHIBIT "A"

A TRACT OR PARCEL CONTAINING 36356 SQUARE FEET OF LAND (0.8346ACRE) OF LAND, MORE OR LESS, AND KNOWN AS THE SOUTH PORTION OF LOT FIVE (5), IN BLOCK ONE (1), OF KINGS FOREST, SECTION ONE (1), A SUBDIVISION IN HARRIS COUNTY TEXAS, ACCORDING TO THE MAP OR PLAT RECORDED IN VOLUME 193 PAGE 106 OF THE MAP RECORDS OF HARRIS COUNTY, TEXAS, SAID SOUTH PORTION OF LOT FIVE BEING MORE PARTICULARLY DESCRIBED BY METES AND BOUNDS AS FOLLOWS;

BEGINNING AT A 5/8" IRON ROD FOUND AT THE PLATTED SOUTHWEST CORNER OF SAID LOT FIVE IN BLOCK ONE OF KINGS FOREST, SECTION ONE, AND SOUTHWEST CORNER OF THE HEREIN DESCRIBED TRACT;

THENCE NORTH 21 DEGREES 36 MINUTES 33 SECONDS EAST, A DISTANCE OF 167.19 FEET TO A FENCE POST FOUND AT AN ANGLE POINT OF SAID LOT FIVE FOR THE NORTHWEST CORNER OF THE HEREIN DESCRIBED TRACT;

THENCE SOUTH 67 DEGREES 52 MINUTES 42 SECONDS EAST, A DISTANCE OF 218.74 (CALLED 218.14) FEET TO A NAIL FOUND IN CONCRETE FOR ANGLE POINT IN SAID LOT 5 FOR THE NORTHEAST CORNER OF THE HEREIN DESCRIBED TRACT;

THENCE SOUTH 21 DEGREES 36 MINUTES 33 SECONDS WEST, A DISTANCE OF 165.23 FEET TO A 5/8" IRON ROD FOUND FOR THE SOUTHEAST CORNER OF THE HEREIN DESCRIBED TRACT AND ON THE NORTH RIGHT OF WAY LINE OF KINGWOOD DRIVE (VARIED WIDTH) BY FILM CODE 218078 OF THE MAP RECORDS OF HARRIS COUNTY;

THENCE NORTH 68 DEGREES 23 MINUTES 27 SECONDS WEST, ALONG THE NORTH RIGHT OF WAY LINE OF SAID KINGWOOD DRIVE A DISTANCE OF 218.73 FEET TO THE POINT OF BEGINNING AND CONTAINING 36356 SQUARE FEET OF LAND, MORE OR LESS.

This legal description was produced and associated with

JOB No. 2410K

COPPERFIELD LAND SURVEYING

FIRM No. 10193752

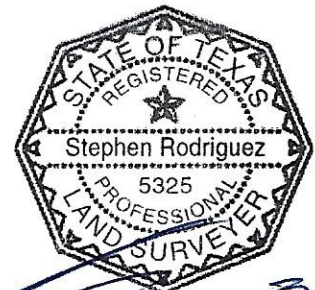

3-15-19

STEPHEN RODRIGUEZ R.P.L.S No. 5325