

### Building Sketch

Borrower/Client	Francisco Villarreal						
Property Address	9027 Madera Rd						
City	Houston	County	Harris	State	TX	Zip Code	77078-2520
Lender	Gateway Mortgage Group LLC						

**First Floor**  
[877.4 Sq ft]

**First Floor**  
[876.48 Sq ft]

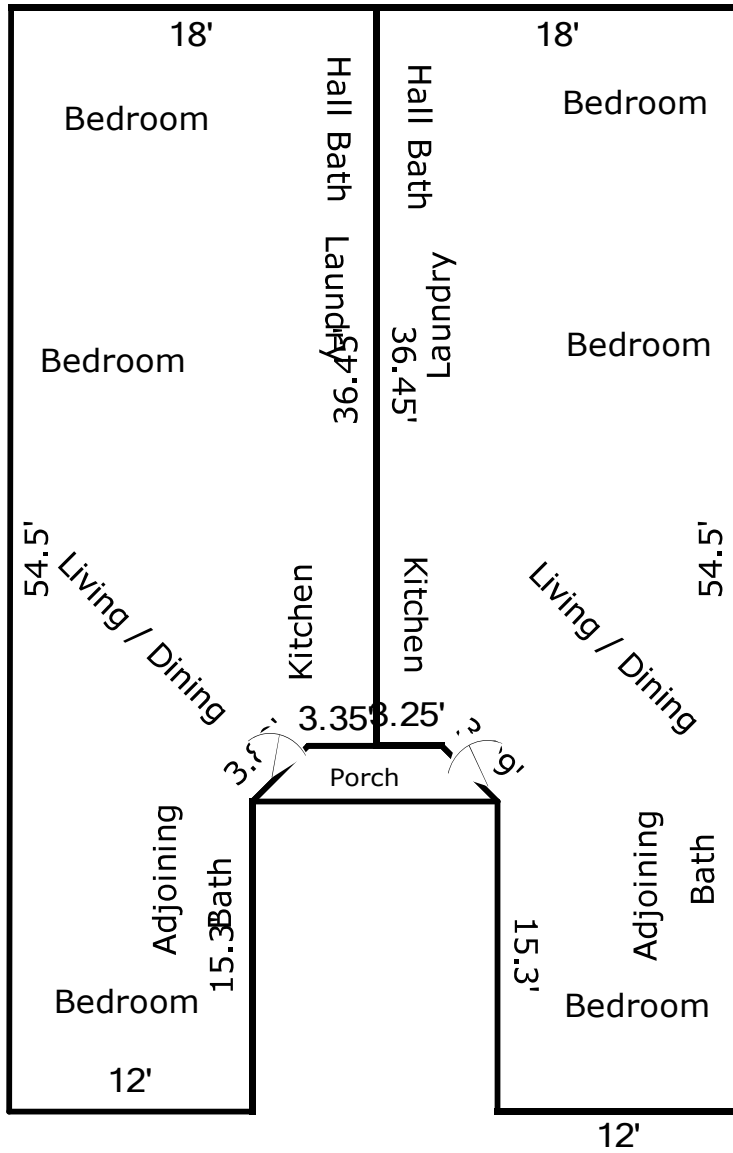

**Unit A**

**Unit B**

TOTAL Sketch by a la mode, inc.

**Area Calculations Summary**

Living Area	Calculation Details		
First Floor	876.48 Sq ft	$12 \times 15.3 = 183.6$	$18 \times 36.45 = 656.1$
		$2.75 \times 12 = 33$	$0.5 \times 2.75 \times 2.75 = 3.78$
First Floor	877.4 Sq ft	$36.45 \times 3.35 = 122.11$	$0.5 \times 2.75 \times 2.75 = 3.78$
		$36.45 \times 2.75 = 100.24$	$54.5 \times 11.9 = 648.55$
		$0.5 \times 54.5 \times 0.1 = 2.72$	
<b>Total Living Area (Rounded):</b>	<b>1754 Sq ft</b>		
Non-living Area			
Open Porch	25.71 Sq ft	$6.6 \times 2.75 = 18.15$	$0.5 \times 2.75 \times 2.75 = 3.78$
		$0.5 \times 2.75 \times 2.75 = 3.78$	