

SCALE: 1"= 60'

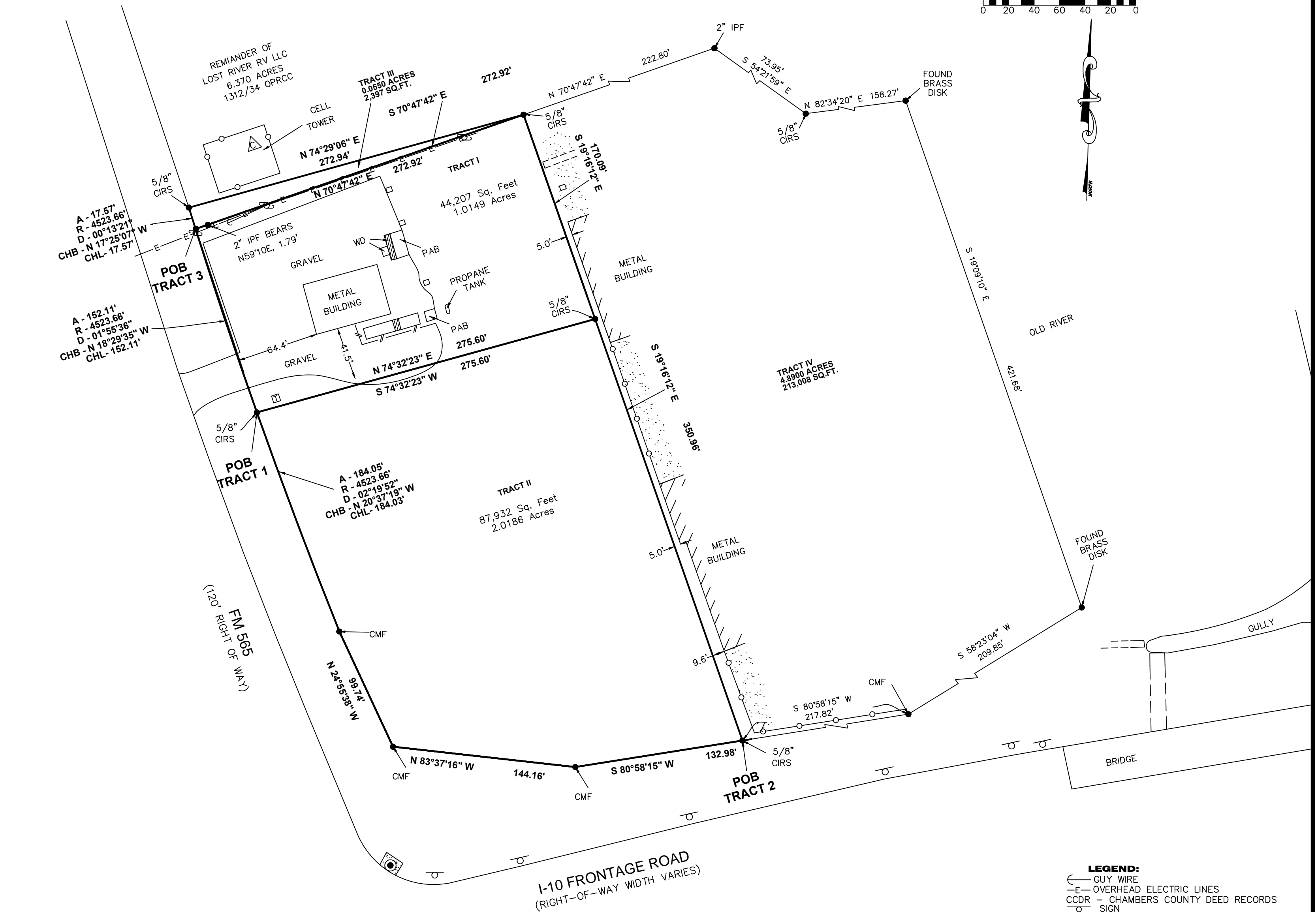

LEGAL DESCRIPTION  
TRACT I  
1.0149 ACRES  
A.B.J. WINFREE SURVEY, ABSTRACT NO. 306  
CHAMBERS COUNTY, TEXAS

A TRACT OR PARCEL CONTAINING 1.0149 ACRES (44,207 SQUARE FEET) OF LAND SITUATED IN THE A.B.J. WINFREE SURVEY, ABSTRACT NO. 306, CHAMBERS COUNTY, TEXAS, AND BEING OUT OF AND A PART OF A 7.923 ACRE TRACT CONVEYED FROM STRATTON SIMMONS AND JENNY CLAYBURN TO LOST RIVER RV PARK, LLC, RECORDED IN VOLUME 1611, PAGE 80 OF THE OFFICIAL PUBLIC RECORDS OF CHAMBERS COUNTY, TEXAS, SAID 1.0149 ACRE TRACT BEING MORE PARTICULARLY DESCRIBED BY METES AND BOUNDS AS FOLLOWS: THE BEARINGS SHOWN HEREON ARE BASED ON THE TEXAS STATE PLANE COORDINATE SYSTEM, SOUTH CENTRAL ZONE, NAD 83:

COMMENCING AT A BRASS DISK FOUND IN THE SIDE OF A GULLY BANK FOR THE SOUTHWEST CORNER OF A CALLED 1.53 ACRE TRACT OF LAND BELONGING TO THE UNITED STATES OF AMERICA, IN THE NORTH RIGHT-OF-WAY LINE OF INTERSTATE HIGHWAY 10 (RIGHT OF WAY WIDTH VARIES), BEING THE SOUTHEAST CORNER OF SAID 7.923 ACRE TRACT;

THENCE SOUTH 58 DEGREES 23 MINUTES 04 SECONDS WEST, ALONG THE NORTH RIGHT-OF-WAY OF SAID INTERSTATE 10 A DISTANCE OF 209.85 FEET TO A CONCRETE RIGHT-OF-WAY MARKER FOUND FOR ANGLE POINT;

THENCE SOUTH 80 DEGREES 58 MINUTES 15 SECONDS WEST, CONTINUING ALONG SAID NORTH RIGHT-OF-WAY, PASS AT A DISTANCE OF 217.82 FEET TO A 5/8 INCH CAPPED IRON ROD SET FOR THE SOUTHEAST CORNER OF A 2.0831 ACRE TRACT SURVEYED THIS DAY, IN A DISTANCE OF 350.80 FEET TO A CONCRETE RIGHT-OF-WAY MARKER FOUND FOR ANGLE POINT;

THENCE NORTH 83 DEGREES 37 MINUTES 16 WEST, CONTINUING ALONG SAID NORTH RIGHT-OF-WAY A DISTANCE OF 144.16 FEET TO A CONCRETE RIGHT-OF-WAY MARKER FOUND AT THE INTERSECTION OF SAID NORTH RIGHT-OF-WAY WITH THE EASTERLY RIGHT-OF-WAY OF STATE HIGHWAY F. M. 565 (120 FOOT RIGHT OF WAY);

THENCE NORTH 24 DEGREES 55 MINUTES 38 SECONDS WEST, WITH THE WEST LINE OF THIS TRACT AND THE EAST RIGHT-OF-WAY LINE OF F.M. 565 A DISTANCE OF 99.74 FEET TO A CONCRETE RIGHT-OF-WAY MARKER FOUND AT THE BEGINNING OF A NON-TANGENT CURVE TO THE RIGHT;

THENCE WITH THE WEST LINE OF THIS TRACT OF LAND AND THE EAST RIGHT-OF-WAY LINE OF F.M. 565 SAID CURVE TO THE RIGHT HAVING A RADIUS OF 4523.66 FEET, AN ARC LENGTH OF 184.05 FEET, A CENTRAL ANGLE OF 02 DEGREES 19 MINUTES 52 SECONDS AND A CHORD BEARING NORTH 20 DEGREES 37 MINUTES 19 SECONDS WEST, 184.03 FEET TO A 5/8 INCH CAPPED IRON ROD SET FOR THE NORTHWEST CORNER OF SAID 2.0831 ACRE TRACT SURVEYED THIS DAY, BEING THE SOUTHWEST CORNER OF THE HEREIN DESCRIBED TRACT AND POINT OF BEGINNING;

THENCE CONTINUING ALONG THE EAST RIGHT-OF-WAY LINE OF F.M. 565 SAID CURVE TO THE RIGHT HAVING A RADIUS OF 4523.66 FEET, AN ARC LENGTH OF 184.05 FEET, A CENTRAL ANGLE OF 02 DEGREES 19 MINUTES 52 SECONDS AND A CHORD BEARING NORTH 20 DEGREES 37 MINUTES 19 SECONDS WEST, 184.03 FEET TO A 5/8 INCH CAPPED IRON ROD SET FOR THE NORTHWEST CORNER OF SAID 2.0831 ACRE TRACT SURVEYED THIS DAY, BEING THE SOUTHWEST CORNER OF THE HEREIN DESCRIBED TRACT;

THENCE SOUTH 19 DEGREES 16 MINUTES 12 SECONDS EAST, ALONG THE WEST LINE OF SAID 4.8900 ACRE TRACT SURVEYED THIS DAY, A DISTANCE OF 170.09 FEET TO A 5/8 INCH CAPPED IRON ROD SET FOR THE NORTHEAST CORNER OF SAID 2.0831 ACRE TRACT SURVEYED THIS DAY, BEING THE SOUTHEAST CORNER OF THE HEREIN DESCRIBED TRACT;

THENCE SOUTH 74 DEGREES 32 MINUTES 23 SECONDS WEST, ALONG THE NORTH LINE OF SAID 2.0186 ACRE TRACT SURVEYED THIS DAY, A DISTANCE OF 275.60 FEET TO THE POINT OF BEGINNING AND CONTAINING 1.0149 ACRES OF LAND, MORE OR LESS.

LEGAL DESCRIPTION  
TRACT II  
2.0186 ACRES  
A.B.J. WINFREE SURVEY, ABSTRACT NO. 306  
CHAMBERS COUNTY, TEXAS

A TRACT OR PARCEL CONTAINING 2.0186 ACRES (87,932 SQUARE FEET) OF LAND SITUATED IN THE A.B.J. WINFREE SURVEY, ABSTRACT NO. 306, CHAMBERS COUNTY, TEXAS, AND BEING OUT OF AND A PART OF A 7.923 ACRE TRACT CONVEYED FROM STRATTON SIMMONS AND JENNY CLAYBURN TO LOST RIVER RV PARK, LLC, RECORDED IN VOLUME 1611, PAGE 80 OF THE OFFICIAL PUBLIC RECORDS OF CHAMBERS COUNTY, TEXAS, SAID 2.0186 ACRE TRACT BEING MORE PARTICULARLY DESCRIBED BY METES AND BOUNDS AS FOLLOWS: THE BEARINGS SHOWN HEREON ARE BASED ON THE TEXAS STATE PLANE COORDINATE SYSTEM, SOUTH CENTRAL ZONE, NAD 83:

COMMENCING AT A BRASS DISK FOUND IN THE SIDE OF A GULLY BANK FOR THE SOUTHWEST CORNER OF A CALLED 1.53 ACRE TRACT OF LAND BELONGING TO THE UNITED STATES OF AMERICA, IN THE NORTH RIGHT-OF-WAY LINE OF INTERSTATE HIGHWAY 10 (RIGHT OF WAY WIDTH VARIES), BEING THE SOUTHEAST CORNER OF SAID 7.923 ACRE TRACT;

THENCE SOUTH 58 DEGREES 23 MINUTES 04 SECONDS WEST, ALONG THE NORTH RIGHT-OF-WAY OF SAID INTERSTATE 10, A DISTANCE OF 209.85 FEET TO A CONCRETE RIGHT-OF-WAY MARKER FOUND FOR ANGLE POINT;

THENCE SOUTH 80 DEGREES 58 MINUTES 15 SECONDS WEST, CONTINUING ALONG SAID NORTH RIGHT-OF-WAY A DISTANCE OF 217.82 FEET TO A 5/8 INCH CAPPED IRON ROD SET FOR THE SOUTHEAST CORNER OF THE HEREIN DESCRIBED TRACT AND POINT OF BEGINNING;

THENCE SOUTH 80 DEGREES 58 MINUTES 15 SECONDS WEST, CONTINUING ALONG SAID NORTH RIGHT-OF-WAY A DISTANCE OF 132.98 FEET TO A CONCRETE RIGHT-OF-WAY MARKER FOUND FOR ANGLE POINT;

THENCE NORTH 83 DEGREES 37 MINUTES 16 WEST, CONTINUING ALONG SAID NORTH RIGHT-OF-WAY A DISTANCE OF 144.16 FEET TO A CONCRETE RIGHT-OF-WAY MARKER FOUND AT THE INTERSECTION OF SAID NORTH RIGHT-OF-WAY WITH THE EASTERLY RIGHT-OF-WAY OF STATE HIGHWAY F.M. 565 (120 FOOT RIGHT OF WAY);

THENCE NORTH 24 DEGREES 55 MINUTES 38 SECONDS WEST, WITH THE WEST LINE OF THIS TRACT AND THE EAST RIGHT-OF-WAY LINE OF F.M. 565, A DISTANCE OF 99.74 FEET TO A CONCRETE RIGHT-OF-WAY MARKER FOUND AT THE BEGINNING OF A NON-TANGENT CURVE TO THE RIGHT;

THENCE WITH THE WEST LINE OF THIS TRACT OF LAND AND THE EAST RIGHT-OF-WAY LINE OF F.M. 565 SAID CURVE TO THE RIGHT HAVING A RADIUS OF 4523.66 FEET, AN ARC LENGTH OF 184.05 FEET, A CENTRAL ANGLE OF 02 DEGREES 19 MINUTES 52 SECONDS AND A CHORD BEARING NORTH 20 DEGREES 37 MINUTES 19 SECONDS WEST, 184.03 FEET TO A 5/8 INCH CAPPED IRON ROD SET FOR THE NORTHWEST CORNER OF SAID 2.0831 ACRE TRACT SURVEYED THIS DAY, BEING THE SOUTHWEST CORNER OF THE HEREIN DESCRIBED TRACT;

THENCE CONTINUING ALONG THE EAST RIGHT-OF-WAY LINE OF F.M. 565 SAID CURVE TO THE RIGHT HAVING A RADIUS OF 4523.66 FEET, AN ARC LENGTH OF 184.05 FEET, A CENTRAL ANGLE OF 02 DEGREES 19 MINUTES 52 SECONDS AND A CHORD BEARING NORTH 20 DEGREES 37 MINUTES 19 SECONDS WEST, 184.03 FEET TO A 5/8 INCH CAPPED IRON ROD SET FOR THE NORTHWEST CORNER OF SAID 2.0831 ACRE TRACT SURVEYED THIS DAY, BEING THE SOUTHWEST CORNER OF THE HEREIN DESCRIBED TRACT;

THENCE SOUTH 19 DEGREES 16 MINUTES 12 SECONDS EAST, ALONG THE WEST LINE OF SAID 4.8900 ACRE TRACT SURVEYED THIS DAY, A DISTANCE OF 170.09 FEET TO A 5/8 INCH CAPPED IRON ROD SET FOR THE NORTHEAST CORNER OF SAID 2.0831 ACRE TRACT SURVEYED THIS DAY, BEING THE SOUTHEAST CORNER OF THE HEREIN DESCRIBED TRACT;

THENCE SOUTH 74 DEGREES 32 MINUTES 23 SECONDS WEST, ALONG THE NORTH LINE OF SAID 2.0186 ACRE TRACT SURVEYED THIS DAY, A DISTANCE OF 275.60 FEET TO THE POINT OF BEGINNING AND CONTAINING 2.0186 ACRES OF LAND, MORE OR LESS.

LEGAL DESCRIPTION  
TRACT III  
0.0550 ACRES  
A.B.J. WINFREE SURVEY, ABSTRACT NO. 306  
CHAMBERS COUNTY, TEXAS

A TRACT OR PARCEL CONTAINING 0.0550 ACRES (2,397 SQUARE FEET) OF LAND SITUATED IN THE A.B.J. WINFREE SURVEY, ABSTRACT NO. 306, CHAMBERS COUNTY, TEXAS, AND BEING OUT OF AND A PART OF A 7.923 ACRE TRACT CONVEYED FROM STRATTON SIMMONS AND JENNY CLAYBURN TO LOST RIVER RV PARK, LLC, RECORDED IN VOLUME 1611, PAGE 80 OF THE OFFICIAL PUBLIC RECORDS OF CHAMBERS COUNTY, TEXAS, SAID 0.0550 ACRE TRACT BEING MORE PARTICULARLY DESCRIBED BY METES AND BOUNDS AS FOLLOWS: THE BEARINGS SHOWN HEREON ARE BASED ON THE TEXAS STATE PLANE COORDINATE SYSTEM, SOUTH CENTRAL ZONE, NAD 83:

BEGINNING AT A BRASS DISK FOUND IN THE SIDE OF A GULLY BANK FOR THE SOUTHWEST CORNER OF A CALLED 1.53 ACRE TRACT OF LAND BELONGING TO THE UNITED STATES OF AMERICA, IN THE NORTH RIGHT-OF-WAY LINE OF INTERSTATE HIGHWAY 10 (RIGHT OF WAY WIDTH VARIES), BEING THE SOUTHEAST CORNER OF SAID 7.923 ACRE TRACT;

THENCE SOUTH 58 DEGREES 23 MINUTES 04 SECONDS WEST, ALONG THE NORTH RIGHT-OF-WAY OF SAID INTERSTATE 10, A DISTANCE OF 209.85 FEET TO A CONCRETE RIGHT-OF-WAY MARKER FOUND FOR ANGLE POINT;

THENCE SOUTH 80 DEGREES 58 MINUTES 15 SECONDS WEST, CONTINUING ALONG SAID NORTH RIGHT-OF-WAY, A DISTANCE OF 217.82 FEET TO A 5/8 INCH CAPPED IRON ROD SET FOR THE SOUTHEAST CORNER OF A 2.0831 ACRE TRACT SURVEYED THIS DAY, BEING THE SOUTHERLY SOUTHWEST CORNER OF THE HEREIN DESCRIBED TRACT AND POINT OF BEGINNING;

THENCE NORTH 19 DEGREES 16 MINUTES 12 SECONDS WEST, ALONG THE EAST LINE OF SAID 2.0831 ACRE TRACT SURVEYED THIS DAY, PASS AT 368.96 FEET THE COMMON EAST CORNER OF SAID 2.0831 ACRE TRACT SURVEYED THIS DAY AND A 0.9312 ACRE TRACT SURVEYED THIS DAY, IN ALL, A TOTAL DISTANCE OF 521.06 FEET TO A 5/8 INCH CAPPED IRON ROD SET FOR THE SOUTHEAST CORNER OF SAID 1.0149 ACRE TRACT SURVEYED THIS DAY, BEING THE NORTHEAST CORNER OF SAID 0.9312 ACRE TRACT, AND THE EAST CORNER OF A 0.0550 ACRE TRACT SURVEYED THIS DAY FOR THE NORTHWEST CORNER OF THE HEREIN DESCRIBED TRACT;

THENCE NORTH 70 DEGREES 47 MINUTES 42 SECONDS EAST, WITH THE NORTH LINE OF THIS TRACT AND THE SOUTH LINE OF SAID REMAINDER OF THE LOST RIVER RV PARK, LLC, A DISTANCE OF 222.80 FEET TO A 2 INCH IRON PIPE FOUND FOR THE NORTHERN NORTHEAST CORNER OF THE HEREIN DESCRIBED TRACT;

THENCE SOUTH 54 DEGREES 21 MINUTES 59 SECONDS EAST, ALONG THE WESTERLY LINE OF SAID 1.53 ACRE TRACT, A DISTANCE OF 73.95 FEET TO A 5/8 INCH CAPPED IRON ROD SET FOR INTERIOR CORNER;

THENCE NORTH 82 DEGREES 34 MINUTES 20 SECONDS EAST, WITH THE EASTERLY NORTH LINE OF THE HEREIN DESCRIBED TRACT AND THE WESTERLY LINE OF SAID 1.53 ACRE TRACT, A DISTANCE OF 158.27 FEET TO A BRASS DISK FOUND FOR THE EASTERLY NORTHEAST CORNER OF THE HEREIN DESCRIBED TRACT;

THENCE SOUTH 19 DEGREES 09 MINUTES 10 SECONDS EAST, WITH THE EAST LINE OF THIS TRACT OF LAND AND THE WEST LINE OF SAID 1.53 ACRE TRACT OF LAND, A DISTANCE OF 421.68 FEET TO THE POINT OF BEGINNING AND CONTAINING 0.0550 ACRES OF LAND, MORE OR LESS.

LEGAL DESCRIPTION  
TRACT IV  
4.8900 ACRES  
A.B.J. WINFREE SURVEY, ABSTRACT NO. 306  
CHAMBERS COUNTY, TEXAS

A TRACT OR PARCEL CONTAINING 4.8900 ACRES (213,008 SQUARE FEET) OF LAND SITUATED IN THE A.B.J. WINFREE SURVEY, ABSTRACT NO. 306, CHAMBERS COUNTY, TEXAS, AND BEING OUT OF AND A PART OF A 7.923 ACRE TRACT CONVEYED FROM STRATTON SIMMONS AND JENNY CLAYBURN TO LOST RIVER RV PARK, LLC, RECORDED IN VOLUME 1611, PAGE 80 OF THE OFFICIAL PUBLIC RECORDS OF CHAMBERS COUNTY, TEXAS, SAID 4.8900 ACRE TRACT BEING MORE PARTICULARLY DESCRIBED BY METES AND BOUNDS AS FOLLOWS: THE BEARINGS SHOWN HEREON ARE BASED ON THE TEXAS STATE PLANE COORDINATE SYSTEM, SOUTH CENTRAL ZONE, NAD 83:

BEGINNING AT A POINT IN THE EAST RIGHT OF WAY LINE OF FARM TO MARKET ROAD 565 (120 FOOT RIGHT OF WAY) FOR THE NORTHWEST CORNER OF A 7.923 ACRE TRACT CONVEYED FROM STRATTON SIMMONS AND JENNY CLAYBURN TO LOST RIVER RV LLC RECORDED IN VOLUME 1611, PAGE 80 OF THE OFFICIAL PUBLIC RECORDS OF CHAMBERS COUNTY, AND A 0.9312 ACRE TRACT OF LAND SURVEYED THIS DAY, BEING THE SOUTHWEST CORNER OF THE HEREIN DESCRIBED TRACT, FROM WHICH 2 INCH IRON PIPE FOUND BEARS NORTH 59 DEGREES 10 MINUTES EAST, 1.79 FEET;

THENCE WITH THE WEST LINE OF THIS TRACT OF LAND AND THE EAST RIGHT-OF-WAY LINE OF F.M. 565 ALONG A CURVE TO THE RIGHT HAVING A RADIUS OF 4523.66 FEET, AN ARC LENGTH OF 17.57 FEET, A CENTRAL ANGLE OF 00 DEGREES 13 MINUTES 21 SECONDS AND A CHORD BEARING NORTH 17 DEGREES 25 MINUTES 07 SECONDS WEST, 17.57 FEET TO A 5/8 INCH CAPPED IRON ROD SET FOR THE NORTHWEST CORNER OF THE HEREIN DESCRIBED TRACT;

THENCE NORTH 74 DEGREES 29 MINUTES 06 SECONDS EAST, OVER SAID CALLED 6.339 ACRE TRACT, A DISTANCE OF 272.94 FEET TO A 5/8 INCH CAPPED IRON ROD SET IN THE NORTH LINE OF SAID 7.923 ACRE TRACT, THE COMMON NORTH CORNER OF SAID 0.9312 ACRE TRACT SURVEYED THIS DAY AND A 4.8900 ACRE TRACT SURVEYED THIS DAY, BEING THE EAST CORNER OF THE HEREIN DESCRIBED TRACT;

THENCE SOUTH 70 DEGREES 47 MINUTES 42 SECONDS WEST, ALONG THE NORTH LINE OF SAID 7.923 ACRE TRACT, AND SAID 0.9312 ACRE TRACT SURVEYED THIS DAY, A DISTANCE OF 272.92 FEET TO THE POINT OF BEGINNING AND CONTAINING 0.0550 ACRES OF LAND, MORE OR LESS.

NOTES:

- THE BEARINGS SHOWN HEREON ARE BASED ON THE TEXAS STATE PLANE COORDINATE SYSTEM, SOUTH CENTRAL ZONE, NAD 83.
- THIS SURVEY WAS PERFORMED WITHOUT BENEFIT OF A TITLE REPORT, CERTAIN EASEMENTS AND/OR BUILDING LINES MAY HAVE BEEN GRANTED WHICH ARE NOT REFLECTED HEREON. THIS SURVEY IS SUBJECT TO ANY FACTS THAT MAY BE DISCLOSED BY A REASONABLE AND APPROPRIATE TITLE SEARCH.
- NOTHING IN THIS SURVEY IS INTENDED TO EXPRESS AN OPINION REGARDING OWNERSHIP OR TITLE.
- THE WORD CERTIFY IS UNDERSTOOD TO BE AN EXPRESSION OF PROFESSIONAL JUDGMENT BY THE SURVEYOR, WHICH IS BASED ON HIS BEST KNOWLEDGE, INFORMATION AND BELIEF.
- SURVEY IS CERTIFIED FOR THIS TRANSACTION ONLY.
- THE FINDINGS AND OPINIONS OF WELLS LAND SURVEY, LLC REFLECTED HEREON ARE PRIVILEGED, CONFIDENTIAL AND INTENDED FOR THE USE OF THE INDIVIDUAL OR ENTITY FOR WHOM THIS WORK WAS PREPARED, IT IS UNDERSTOOD THAT THE USE OF, RELIANCE ON, OR REPRODUCTION OF SAME, IN WHOLE OR IN PART, BY OTHERS WITHOUT THE EXPRESS WRITTEN CONSENT OF WELLS LAND SURVEY, LLC IS PROHIBITED AND WITHOUT WARRANTY, EXPRESS OR IMPLIED, WELLS LAND SURVEY, LLC SHALL BE HELD HARMLESS AGAINST DAMAGES OR EXPENSES RESULTING FROM SUCH UNAUTHORIZED USE, RELIANCE OF REPRODUCTION. COPYRIGHT 2017. ALL RIGHTS RESERVED.

PROPERTY LIES WITHIN FLOOD ZONE 'X', ACCORDING TO F.I.R.M. NO. 48071C0185E, DATED MAY 04, 2015, BY GRAPHIC PLOTTING ONLY. WELLS LAND SURVEY DOES NOT ASSUME RESPONSIBILITY FOR EXACT DETERMINATION. BEFORE ANY DEVELOPMENT, PLANNING, DESIGN, OR CONSTRUCTION IS STARTED, THE COMMUNITY, CITY, AND COUNTY IN WHICH SUBJECT TRACT EXISTS SHOULD BE CONTACTED, SAID ENTITIES MAY IMPOSE GREATER FLOOD PLAIN AND FLOODWAY RESTRICTIONS THAN SHOWN BY THE F.I.R.M. THAT MAY AFFECT DEVELOPMENT.

## SURVEY OF

A TRACT OR PARCEL CONTAINING 1.0149 ACRES (44,207 SQUARE FEET) OF LAND SITUATED IN THE A.B.J. WINFREE SURVEY, ABSTRACT NO. 306, CHAMBERS COUNTY, TEXAS, AND BEING OUT OF AND A PART OF A 7.923 ACRE TRACT CONVEYED FROM STRATTON SIMMONS AND JENNY CLAYBURN TO LOST RIVER RV PARK, LLC, RECORDED IN VOLUME 1611, PAGE 80 OF THE OFFICIAL PUBLIC RECORDS OF CHAMBERS COUNTY, TEXAS.

A TRACT OR PARCEL CONTAINING 2.0186 ACRES (87,932 SQUARE FEET) OF LAND SITUATED IN THE A.B.J. WINFREE SURVEY, ABSTRACT NO. 306, CHAMBERS COUNTY, TEXAS, AND BEING OUT OF AND A PART OF A 7.923 ACRE TRACT CONVEYED FROM STRATTON SIMMONS AND JENNY CLAYBURN TO LOST RIVER RV PARK, LLC, RECORDED IN VOLUME 1611, PAGE 80 OF THE OFFICIAL PUBLIC RECORDS OF CHAMBERS COUNTY, TEXAS.

A TRACT OR PARCEL CONTAINING 0.0550 ACRES (2,397 SQUARE FEET) OF LAND SITUATED IN THE A.B.J. WINFREE SURVEY, ABSTRACT NO. 306, CHAMBERS COUNTY, TEXAS, AND BEING OUT OF AND A PART OF A 7.923 ACRE TRACT CONVEYED FROM STRATTON SIMMONS AND JENNY CLAYBURN TO LOST RIVER RV PARK, LLC, RECORDED IN VOLUME 1611, PAGE 80 OF THE OFFICIAL PUBLIC RECORDS OF CHAMBERS COUNTY, TEXAS.

A TRACT OR PARCEL CONTAINING 4.8900 ACRES (213,008 SQUARE FEET) OF LAND SITUATED IN THE A.B.J. WINFREE SURVEY, ABSTRACT NO. 306, CHAMBERS COUNTY, TEXAS, AND BEING THE REMAINDER OF A CALLED 7.923 ACRE TRACT CONVEYED FROM STRATTON SIMMONS AND JENNY CLAYBURN TO LOST RIVER RV PARK, LLC, RECORDED IN VOLUME 1611, PAGE 80 OF THE OFFICIAL PUBLIC RECORDS OF CHAMBERS COUNTY, TEXAS.

ADDRESS: FM-565  
MONT BELVIEU, TX 77523

BUYER:  
LOST RIVER RV RESORT

JOB NO: 092-18

REVISED: 2-27-18 AREA OF TR 1&2

DATE: 12-11-17

SCALE: 1"= 60'

**SURVEYOR'S CERTIFICATION**

TO: LOST RIVER RV RESORT, EXCLUSIVELY:  
I, TIM W. WHITE, A REGISTERED PROFESSIONAL LAND SURVEYOR IN THE STATE OF TEXAS, HEREBY CERTIFY THAT THIS PLAT REPRESENTS A SURVEY MADE ON THE GROUND UNDER MY DIRECT SUPERVISION ON DECEMBER 11, 2017. AT THE TIME OF THIS SURVEY THERE WERE NO APPARENT DISCREPANCIES, SHORTAGES IN AREA, BOUNDARY LINE CONFLICTS, ENCROACHMENTS, OVERLAPPING OF IMPROVEMENTS, EASEMENTS OR RIGHTS OF WAY, THAT I AM AWARE OF EXCEPT AS SHOWN HEREON, AND THAT SAID PROPERTY HAS ACCESS TO AND FROM A DEDICATED ROADWAY. PROPERTY IS SUBJECT TO ALL CITY ORDINANCES AND SUBDIVISION COVENANTS, CONDITIONS AND RESTRICTIONS THAT MAY APPLY.

**THIS SURVEY IS CERTIFIED FOR THIS TRANSACTION ONLY.**

Tim Wells White, Registered Professional Land Surveyor No. 5742